

## Itasca County Timber Appraisal Report

**Appraised By:**

Jesse Lehner

**Appraisal Date:**

03/23/2020

**Sale Type:**

SEALED BID-INTERMEDIATE

**Auction Date:**

06/12/2020

**Appraisal Number:** 20-07-06**Permit Number:****Expiration Date:** 03/01/2023**Page:** 1 of 3**Legal Description**

<b>RE Code</b>	<b>Sec.</b>	<b>Twp.</b>	<b>Rge.</b>	<b>City/Twp</b>	<b>Subd</b>			
68-002-3400	2	54	27	Unorganized	SE SW			
68-002-4000	2	54	27	Unorganized	SE 1/4			
68-011-1200	11	54	27	Unorganized	NW NE			
<b>Block 1 Species</b>	<b>Volume</b>	<b>Units</b>	<b>Unit Price</b>	<b>Value</b>	<b>Comments</b>	<b>Bolt %</b>	<b>Bid</b>	
Aspen	466	Cords	\$26.00	\$12,116.00	4-9 stick, 7-25 inch Dbh, Poor-Good quality	10	^	
Maple	76	Cords	\$8.00	\$608.00	2-4 stick, 6-18 inch Dbh, Poor-Fair quality	0	#	
Red Oak	41	Cords	\$19.00	\$779.00	5-7 stick, 9-19 inch Dbh, Fair quality, 20% saw	20	#	
Basswood	28	Cords	\$8.00	\$224.00	5-7 stick, 8-15 inch Dbh, Fair quality	30	#	
Paper Birch	12	Cords	\$8.00	\$96.00	4-6 stick, 10-20 inch Dbh, Fair-Good quality, 20% saw	20	#	
				\$13,823.00	<b>Subtotal</b>			
<b>Total Cords =</b>	623		<b>Total MBF: 0</b>	\$13,823.00	<b>Total</b>			

Bid Symbols: ^ = Bid Species; # = Non-Bid Species; + = Sold Area Estimate; \* = Sold Area Estimate & Non-Bid Species  
All species woodsrun unless listed otherwise.

**Species Scaled:** Aspen, Basswood, Maple, Paper Birch, Red Oak

**Species SAE:**

**Operability:** Summer: 7/1 - 10/1

**Soil Type:** Itasca-Goodland silt loams

**Topography:** Level to rolling

**Cutting Acres:** 27.3

All permits must follow Itasca County Forest Management Guidelines and Specifications (can be found at <http://www.co.itasca.mn.us/DocumentCenter/View/567/Forest-Management-Guidelines-and-Specifications>).

**Harvest Specifications**

<b>Comments</b>
Harvest type: Aspen removal/Marked hardwood thin

<b>Harvest and Reserves</b>
Reserve all non-hazardous snags. Trees marked with "R" are to be reserved for wildlife. Cut all aspen and orange ringed hardwood species within permit boundaries. Reserve all non-marked trees.

<b>Access</b>
Public access road must be used to access this timber sale. Access road must be kept in good condition at all times. Gate must be locked at all times, except on days when 3 or more loads are hauled. Gates must remain locked during hunting season.

<b>Landings and Access Roads</b>
Location and construction of any new roads/landings must be pre-approved by the sale administrator. Trails and landings need to be rehabilitated to a satisfactory condition before performance bond is returned. Timber sale administrator shall be notified at least 3 working days prior to completion of hauling and road work. This provides adequate time for permit area inspection and addressing of permit compliance requirements before hauling and road work equipment is removed.

## Itasca County Timber Appraisal Report

<b>Appraised By:</b> Jesse Lehner <b>Appraisal Date:</b> 03/23/2020	<b>Sale Type:</b> SEALED BID-INTERMEDIATE <b>Auction Date:</b> 06/12/2020	<b>Appraisal Number:</b> 20-07-06 <b>Permit Number:</b> <b>Expiration Date:</b> 03/01/2023 <b>Page:</b> 2 of 3
--	--	---

### Cutting, Felling, and Skidding

Timber must be processed at the stump.  
 Do not damage unmarked trees, regeneration, or reserve trees.  
 Do not fell timber into wetlands or across sale boundaries.

### Site, Soil, and Water Protection

Filter strips require <5% soil disturbance within 50' of all wetlands.  
 Roads and skid trails must be stabilized. This may involve installing water bars, strike outs, and/or mulching and seeding.

### Slash Disposal

Slash must be evenly distributed throughout permit area.

### Regeneration Plan

Natural northern hardwood and aspen regeneration.

# Itasca County Timber Appraisal Report

<b>Appraised By:</b> Jesse Lehner <b>Appraisal Date:</b> 03/23/2020	<b>Sale Type:</b> SEALED BID-INTERMEDIATE <b>Auction Date:</b> 06/12/2020	<b>Appraisal Number:</b> 20-07-06 <b>Permit Number:</b> <b>Expiration Date:</b> 03/01/2023 <b>Page:</b> 3 of 3
--	--	---

**Site Map:**

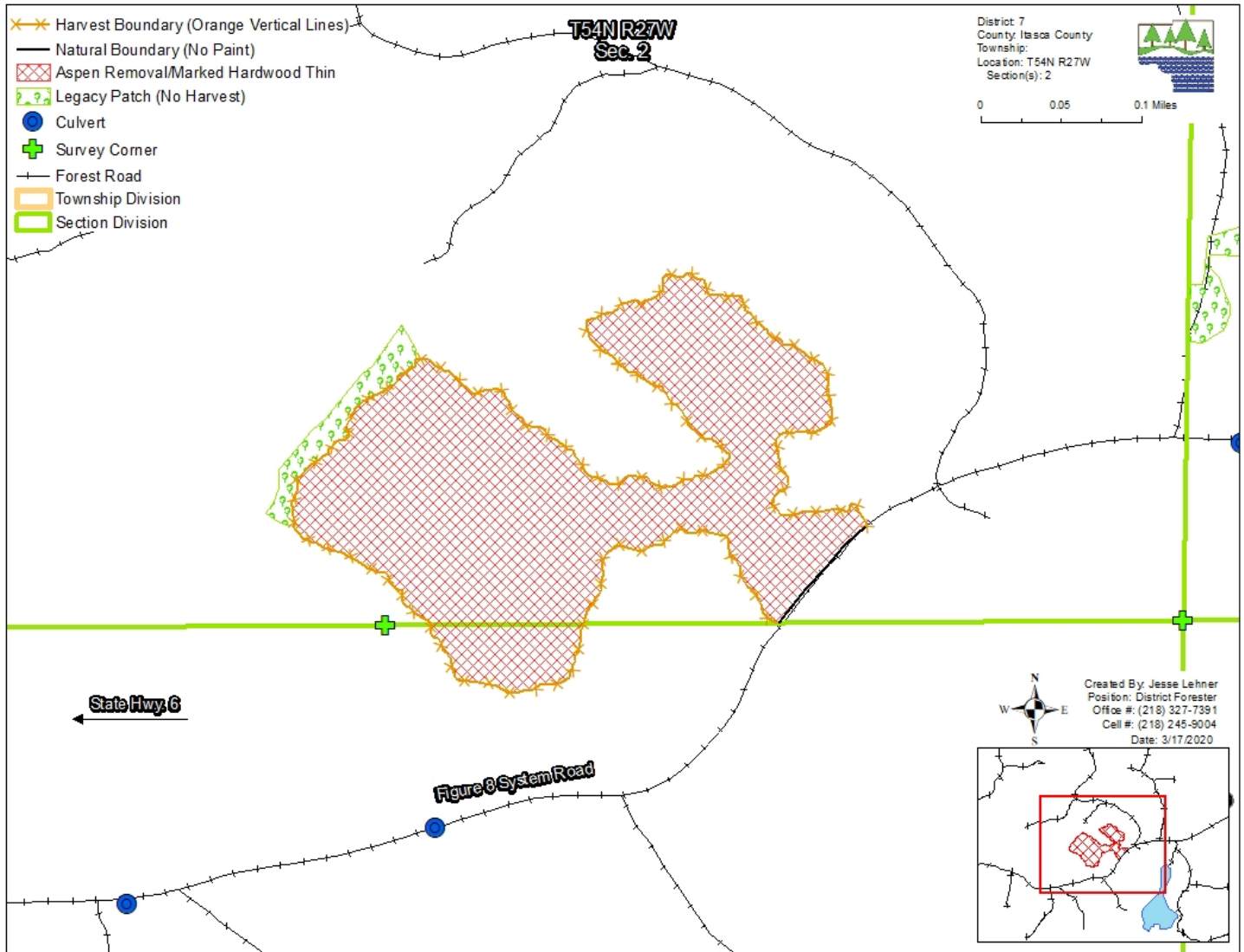

Appraisal examined and approved by \_\_\_\_\_  
Forester Date

Appraisal examined and approved by \_\_\_\_\_  
Land Department Date