

Itasca County Timber Appraisal Report

Appraised By: Jesse Lehner Appraisal Date: 03/23/2020	Sale Type: SEALED BID-REGULAR Auction Date: 06/12/2020	Appraisal Number: 20-07-01 Permit Number: Expiration Date: 03/01/2023 Page: 1 of 3
--	---	---

Legal Description

<u>RE Code</u>	<u>Sec.</u>	<u>Twp.</u>	<u>Rge.</u>	<u>City/Twp</u>	<u>Subd</u>		
14-121-0000	21	55	22	Goodland	ALL OF SECTION		
<u>Block 1 Species</u>	<u>Volume</u>	<u>Units</u>	<u>Unit Price</u>	<u>Value</u>	<u>Comments</u>	<u>Bolt %</u>	<u>Bid</u>
Aspen	396	Cords	\$26.00	\$10,296.00	5-7 stick, 8-14 inch Dbh, Good quality	25	^
Maple	90	Cords	\$7.00	\$630.00	2-4 stick, 7-14 inch Dbh, Poor-Fair quality	0	#
Paper Birch	28	Cords	\$13.00	\$364.00	3-5 stick, 8-16 inch Dbh, Good quality, 30% saw	20	#
				Subtotal			
Total Cords =				514	Total MBF: 0		Total
				\$11,290.00			

Bid Symbols: ^ = Bid Species; # = Non-Bid Species; + = Sold Area Estimate; * = Sold Area Estimate & Non-Bid Species
 All species woodsrun unless listed otherwise.

Species Scaled: Aspen, Maple , Paper Birch
Species SAE:

Operability: Summer dry: 7/1 - 10/1	Soil Type: Menahga-Itasca Complex & Itasca-Goodland silt loams
Topography: Level to steep	Cutting Acres: 18.7

All permits must follow Itasca County Forest Management Guidelines and Specifications (can be found at <http://www.co.itasca.mn.us/DocumentCenter/View/567/Forest-Management-Guidelines-and-Specifications>).

Harvest Specifications

Comments
Harvest type: Clearcut w/reserves

Harvest and Reserves
Harvest all merchantable stems within the permit area, except reserve species. Reserve all oak, basswood, red pine, white pine, and yellow birch. In addition, reserve 3-5 fully crowned, single stemmed birch per acre. Reserve all non-hazardous snags. Trees marked with "R" are to be reserved for wildlife.

Access
Public forest roads must be used to access the timber sale. Access road must be kept in good condition, determined by administering forester, at all times. Permit is along the Goodland ATV/OHM Trail. ATV trail regulations in Itasca County Forest Management Guideline & Specifications apply.

Landings and Access Roads
Location and construction of any new roads/landings must be pre-approved by the sale administrator. Trails and landings need to be rehabilitated to a satisfactory condition, determined by administering forester, before performance bond is returned. Berm(s) must be installed after sale is completed. Timber sale administrator shall be notified at least 3 working days prior to completion of hauling and road work. This provides adequate time for permit area inspection and addressing of permit compliance requirements before hauling and road work equipment is removed.

Itasca County Timber Appraisal Report

Appraised By: Jesse Lehner Appraisal Date: 03/23/2020	Sale Type: SEALED BID-REGULAR Auction Date: 06/12/2020	Appraisal Number: 20-07-01 Permit Number: Expiration Date: 03/01/2023 Page: 2 of 3
--	---	---

Cutting, Felling, and Skidding

Do not damage reserve trees.
 Do not fell timber into wetlands or across sale boundaries.
 Some steep slopes occur on this permit, which may require hand felling.
 Permit sale boundaries are painted in orange paint. Natural boundaries are also used for this permit, these are not painted.

Site, Soil, and Water Protection

Filter strips require <5% soil disturbance within 50' of all wetlands.
 Roads and skid trails must be stabilized. This may involve installing water bars, strike outs, and/or mulching and seeding.
 Reserve all non-merchantable timber within 15ft of all wetlands.

Slash Disposal

Slash must be evenly distributed throughout permit area.

Special Conditions

Loads with mixed species will be scaled as the highest value species, unless consumer scales species separately using county approved methods.

Regeneration Plan

Natural Regeneration

Itasca County Timber Appraisal Report

Appraised By: Jesse Lehner	Sale Type: SEALED BID-REGULAR	Appraisal Number: 20-07-01
Appraisal Date: 03/23/2020	Auction Date: 06/12/2020	Permit Number:
		Expiration Date: 03/01/2023
		Page: 3 of 3

Site Map:

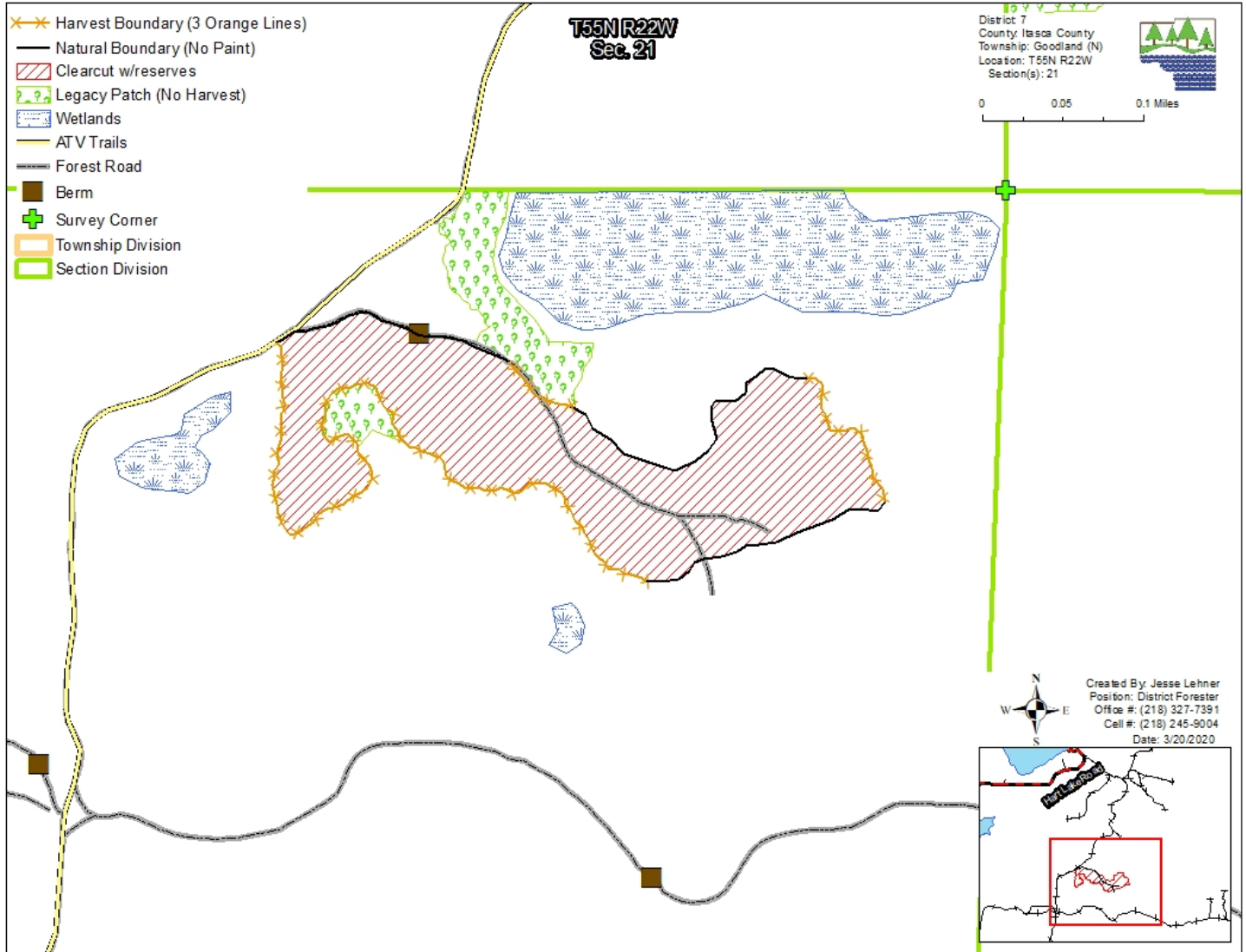

Appraisal examined and approved by _____
Forester Date

Appraisal examined and approved by _____
Land Department Date