

# Itasca County Timber Appraisal Report

<b>Appraised By:</b> Tony Schram <b>Appraisal Date:</b> 01/13/2020	<b>Sale Type:</b> SEALED BID-REGULAR <b>Auction Date:</b> 06/12/2020	<b>Appraisal Number:</b> 20-06-04 <b>Permit Number:</b> <b>Expiration Date:</b> 03/01/2023 <b>Page:</b> 1 of 3
-----------------------------------------------------------------------------	-------------------------------------------------------------------------------	-------------------------------------------------------------------------------------------------------------------------

## Legal Description

RE Code	Sec.	Twp.	Rge.	City/Twp	Subd
41-035-1400	35	57	25	Wabana	SE NE
41-035-4100	35	57	25	Wabana	NE SE
41-035-4200	35	57	25	Wabana	NW SE
41-035-4300	35	57	25	Wabana	SW SE
41-035-4400	35	57	25	Wabana	SE SE

Block 1 Species	Volume	Units	Unit Price	Value	Comments	Bolt %	Bid
Aspen	1,250	Cords	\$24.00	\$30,000.00	4-6 stick 6-9 inch	5	^
Balm	20	Cords	\$18.00	\$360.00	4-6 stick 6-9 inch	0	^
Balsam Fir	40	Cords	\$12.00	\$480.00	3-4 stick 6-10inch	0	#
Spruce	2	Cords	\$15.00	\$30.00	3-6 stick 8-14 inch 100% w. spruce	60	#
				\$30,870.00	<b>Subtotal</b>		
<b>Total Cords =</b>	1,312			<b>Total MBF: 0</b>	<b>Total</b>		

Bid Symbols: ^ = Bid Species; # = Non-Bid Species; + = Sold Area Estimate; \* = Sold Area Estimate & Non-Bid Species  
All species woodsrun unless listed otherwise.

**Species Scaled:** Aspen, Balm , Balsam Fir, Spruce

**Species SAE:**

**Operability:** Dry Summer : 7-15 - 9-15, Frozen Ground : 12-1 - 3-1  
**Soil Type:** A1B Eagleview and Menahga

**Topography:** Level  
**Cutting Acres:** 46.2

All permits must follow Itasca County Forest Management Guidelines and Specifications (can be found at <http://www.co.itasca.mn.us/DocumentCenter/View/567/Forest-Management-Guidelines-and-Specifications> ).

## Harvest Specifications

Comments
Aspen Clearcut W/Reserves

Harvest and Reserves
Harvest Aspen, balm and Balsam along with any W. Spruce 3 sticks and bigger. Reserve Oak, Maple, Birch, Pine, Ash, and Spruce 2 sticks and smaller. Reserve all non-hazardous snags.

Access
Access is down the newly built "Rain Barrel" road starting on County Rd 60 (Clearwater Road). The road crosses state and tax forfeit lands. Snowmobile trail regulations in Itasca County Forest Management Guideline & Specifications apply. A minimum of two inches of compacted snow must remain on the trail as a running surface.

Landings and Access Roads
Roads and landings must be approved by sale administrator. Roughly a 1/4 mile of new summer road would need to be built in order to access the sale in nonfrozen conditions. Timber sale administrator shall be notified at least 3 working days prior to completion of hauling and road work. This provides adequate time for permit area inspection and addressing of permit compliance requirements before hauling and road work equipment is removed.

## Itasca County Timber Appraisal Report

<b>Appraised By:</b> Tony Schram <b>Appraisal Date:</b> 01/13/2020	<b>Sale Type:</b> SEALED BID-REGULAR <b>Auction Date:</b> 06/12/2020	<b>Appraisal Number:</b> 20-06-04 <b>Permit Number:</b> <b>Expiration Date:</b> 03/01/2023 <b>Page:</b> 2 of 3
-----------------------------------------------------------------------------	-------------------------------------------------------------------------------	-------------------------------------------------------------------------------------------------------------------------

### Cutting, Felling, and Skidding

Do not disturb survey markers, including witness trees.  
 Do not damage reserve trees.  
 Sale property boundaries are painted with orange circles.  
 Sale cutting boundaries are painted with orange or blue slashes

### Site, Soil, and Water Protection

Filter strips require <5% soil disturbance within 50' of all wetlands.  
 Dry summer operable site with interruptions due to wet weather conditions. Extreme care will be needed to safely harvest site during nonfrozen conditions.

### Slash Disposal

Slash must be evenly distributed throughout permit area.  
 A 10 ft. wide slash free zone must be maintained along roads and trails.  
 No snags shall be left within a tree length distance to the snowmobile trail

### Regeneration Plan

Natural Regeneration

# Itasca County Timber Appraisal Report

<b>Appraised By:</b> Tony Schram <b>Appraisal Date:</b> 01/13/2020	<b>Sale Type:</b> SEALED BID-REGULAR <b>Auction Date:</b> 06/12/2020	<b>Appraisal Number:</b> 20-06-04 <b>Permit Number:</b> <b>Expiration Date:</b> 03/01/2023 <b>Page:</b> 3 of 3
-----------------------------------------------------------------------------	-------------------------------------------------------------------------------	-------------------------------------------------------------------------------------------------------------------------

**Site Map:**

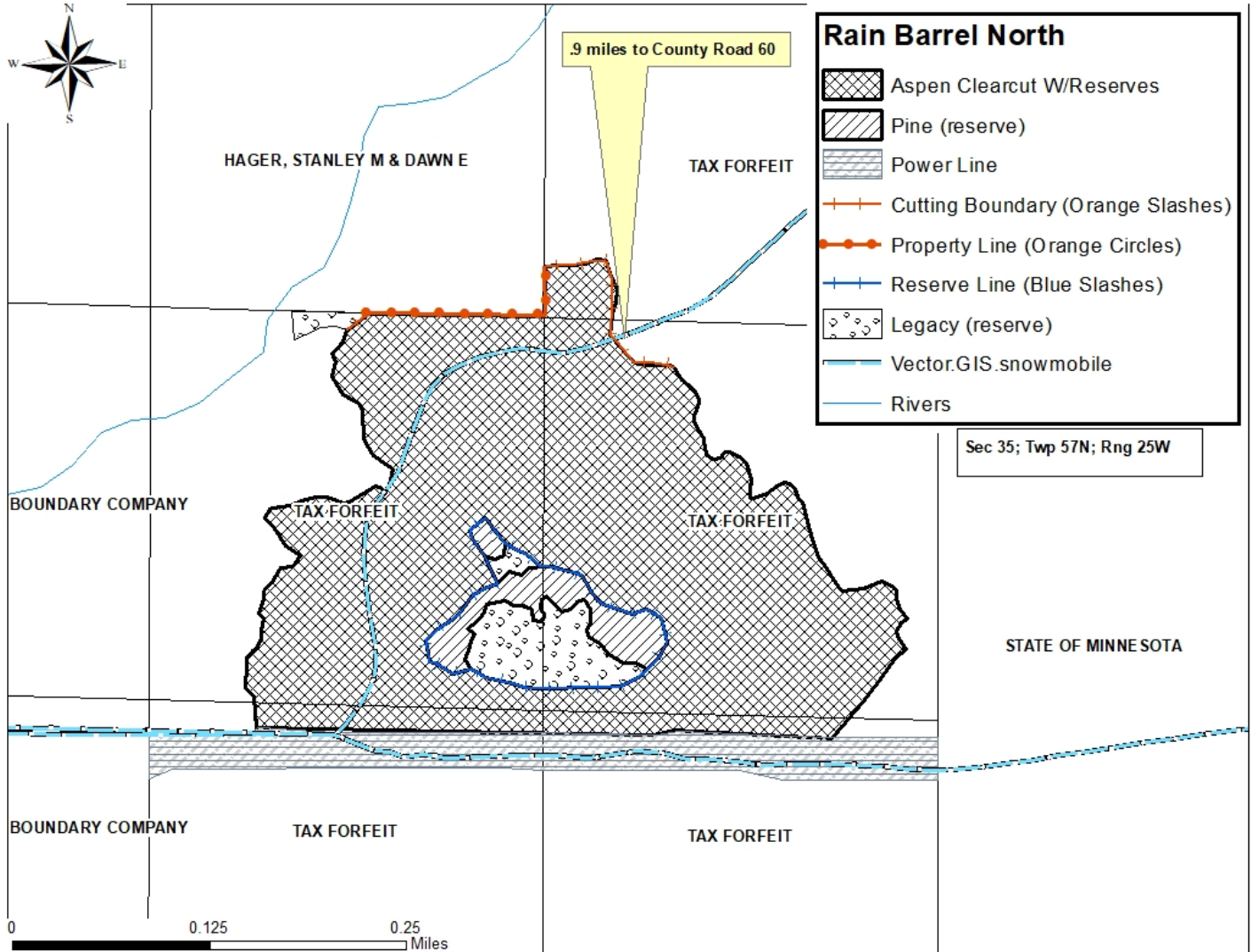

Appraisal examined and approved by \_\_\_\_\_ Forester \_\_\_\_\_ Date

Appraisal examined and approved by \_\_\_\_\_ Land Department \_\_\_\_\_ Date