

Itasca County Timber Appraisal Report

Appraised By: Loren Eide Appraisal Date: 04/06/2020	Sale Type: SEALED BID-REGULAR Auction Date: 06/12/2020	Appraisal Number: 20-04-03 Permit Number: Expiration Date: 03/01/2023 Page: 1 of 3
--	---	---

Legal Description

<u>RE Code</u>	<u>Sec.</u>	<u>Twp.</u>	<u>Rge.</u>	<u>City/Twp</u>	<u>Subd</u>		
49-021-1000	21	59	22	Unorganized	NE 1/4		
49-021-3000	21	59	22	Unorganized	SW 1/4		
49-021-4000	21	59	22	Unorganized	SE 1/4		
<u>Block 1 Species</u>	<u>Volume</u>	<u>Units</u>	<u>Unit Price</u>	<u>Value</u>	<u>Comments</u>	<u>Bolt %</u>	<u>Bid</u>
Spruce	750	Cords	\$17.00	\$12,750.00	black spruce	8	^
Aspen	400	Cords	\$23.00	\$9,200.00		15	^
Jack Pine	160	Cords	\$23.00	\$3,680.00		50	^
Balsam Fir	45	Cords	\$15.00	\$675.00		5	#
Tamarack	20	Cords	\$6.00	\$120.00			#
				\$26,425.00	Subtotal		
Total Cords =	1,375		Total MBF: 0	\$26,425.00	Total		

Bid Symbols: ^ = Bid Species; # = Non-Bid Species; + = Sold Area Estimate; * = Sold Area Estimate & Non-Bid Species
 All species woodsrun unless listed otherwise.

Species Scaled: Aspen, Balsam Fir, Jack Pine, Spruce, Tamarack
Species SAE:

Operability: Winter (frozen ground): 12/15 - 3/1 **Soil Type:** Nashwauk fine sandy loam, Greenwood Peat
Topography: Level **Cutting Acres:** 59.8

All permits must follow Itasca County Forest Management Guidelines and Specifications (can be found at <http://www.co.itasca.mn.us/DocumentCenter/View/567/Forest-Management-Guidelines-and-Specifications>).

Harvest Specifications

Comments
Black spruce clearcut (37.8 acres), aspen (18 acres) and jack pine (4 acres) clearcuts with reserves.

Harvest and Reserves
Reserve small balsam, cedar, birch, ash, red/white pine and snag/cavity trees when not a hazard.

Access
State land must be crossed to access timber sale. Logger must obtain permits/ permission from land manager. 1 mile to County #554 (if using the shortest route to sale area).

Landings and Access Roads
Location and construction of any new roads/landings must be pre-approved by the sale administrator. Timber sale administrator shall be notified at least 3 working days prior to completion of hauling and road work. This provides adequate time for permit area inspection and addressing of permit compliance requirements before hauling and road work equipment is removed.

Cutting, Felling, and Skidding
Keep upland slash in upland areas and do not fell trees outside sale boundaries. Majority of sale boundaries are painted orange. Black spruce 5-7" stands have about 30BA (3-4"dbh) of unmerchantable trees that will require felling.

Itasca County Timber Appraisal Report

Appraised By: Loren Eide Appraisal Date: 04/06/2020	Sale Type: SEALED BID-REGULAR Auction Date: 06/12/2020	Appraisal Number: 20-04-03 Permit Number: Expiration Date: 03/01/2023 Page: 2 of 3
--	---	---

Site, Soil, and Water Protection

Filter strips require <5% soil disturbance within 50' of all lowland brush wetlands.

Slash Disposal

Slash must be evenly distributed throughout permit area.

Special Conditions

All Black Spruce stems greater than 5ft. must be severed for Dwarf Mistletoe control.
Utilize spruce and tamarack 5" DBH and greater with 2 sticks to a 3" top.

Itasca County Timber Appraisal Report

Appraised By: Loren Eide	Sale Type: SEALED BID-REGULAR	Appraisal Number: 20-04-03
Appraisal Date: 04/06/2020	Auction Date: 06/12/2020	Permit Number:
		Expiration Date: 03/01/2023
		Page: 3 of 3

Site Map:

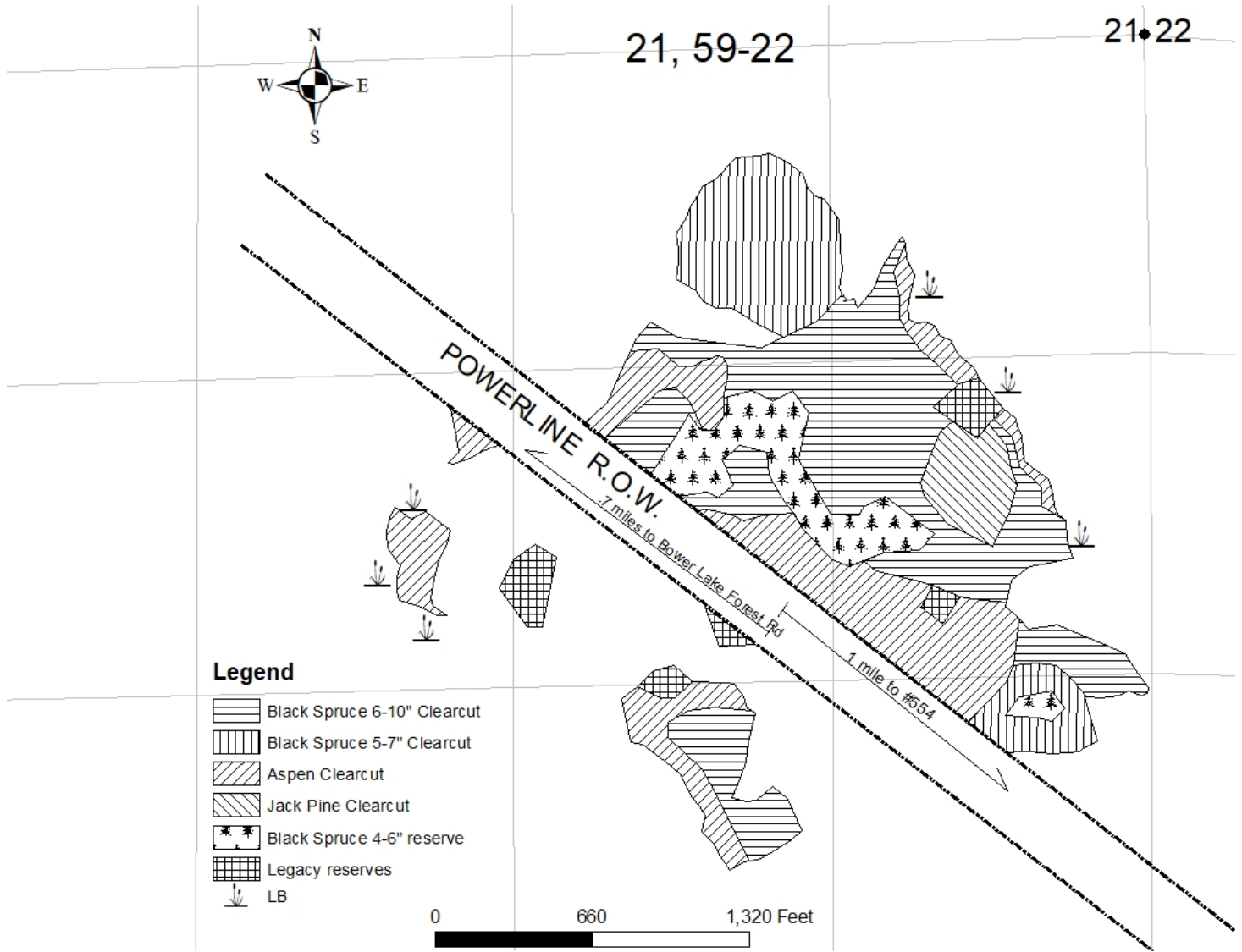

Appraisal examined and approved by _____
Forester Date

Appraisal examined and approved by _____
Land Department Date