

## Itasca County Timber Appraisal Report

<b>Appraised By:</b> Casey Dabrowski	<b>Sale Type:</b> SEALED BID-INTERMEDIATE	<b>Appraisal Number:</b> 20-02-05
<b>Appraisal Date:</b> 03/30/2020	<b>Auction Date:</b> 06/12/2020	<b>Permit Number:</b>
		<b>Expiration Date:</b> 03/01/2023
		<b>Page:</b> 1 of 3

**Legal Description**

<b>RE Code</b>	<b>Sec.</b>	<b>Twp.</b>	<b>Rge.</b>	<b>City/Twp</b>	<b>Subd</b>			
10-123-1000	23	62	23	Carpenter	NE 1/4			
<b>Block 1 Species</b>	<b>Volume</b>	<b>Units</b>	<b>Unit Price</b>	<b>Value</b>	<b>Comments</b>	<b>Bolt %</b>	<b>Bid</b>	
Aspen	580	Cords	\$22.00	\$12,760.00	6-12", 4-8 st, Good	5	^	
Balsam Fir	64	Cords	\$13.00	\$832.00	5-8", 2-4 st, Good.	5	#	
Balm	5	Cords	\$17.00	\$85.00	6-8", 4-7 st, Fair.	0	#	
White Cedar	1	Cords	\$10.00	\$10.00	Incidental damage only.	0	#	
				\$13,687.00	<b>Subtotal</b>			
<b>Total Cords =</b>	650		<b>Total MBF: 0</b>	\$13,687.00	<b>Total</b>			

Bid Symbols: ^ = Bid Species; # = Non-Bid Species; + = Sold Area Estimate; \* = Sold Area Estimate & Non-Bid Species  
All species woodsrun unless listed otherwise.

**Species Scaled:** Aspen, Balm, Balsam Fir, White Cedar

**Species SAE:**

**Operability:** Winter - Frozen Ground: 12/1 - 3/1      **Soil Type:** Effie Loam  
**Topography:** Level      **Cutting Acres:** 22.9

All permits must follow Itasca County Forest Management Guidelines and Specifications (can be found at <http://www.co.itasca.mn.us/DocumentCenter/View/567/Forest-Management-Guidelines-and-Specifications>).

**Harvest Specifications**

<b>Comments</b>
Harvest type: aspen clearcut with reserves.
<b>Harvest and Reserves</b>
Harvest: Cut all aspen, balm, and balsam. Cut and utilize cedar damaged during operation. Reserve: cedar, spruce, and balsam regeneration patches.
<b>Access</b>
1.75 miles to public road State Highway 1.
<b>Landings and Access Roads</b>
Existing roads and landings will be reused. Timber sale administrator shall be notified at least 3 working days prior to completion of hauling and road work. This provides adequate time for permit area inspection and addressing of permit compliance requirements before hauling and road work equipment is removed.
<b>Cutting, Felling, and Skidding</b>
Do not damage reserve trees. Do not fell timber into wetlands or across sale boundaries. Sale boundaries painted with orange lines (I I I), ownership boundaries painted with orange circles (O O O). Natural boundaries are also used; see sale map.
<b>Slash Disposal</b>
Slash must be evenly distributed throughout permit area.

**Itasca County Timber Appraisal Report**

<b>Appraised By:</b> Casey Dabrowski	<b>Sale Type:</b> SEALED BID-INTERMEDIATE	<b>Appraisal Number:</b> 20-02-05
<b>Appraisal Date:</b> 03/30/2020	<b>Auction Date:</b> 06/12/2020	<b>Permit Number:</b>
		<b>Expiration Date:</b> 03/01/2023
		<b>Page:</b> 2 of 3

**Regeneration Plan**

Natural regeneration to aspen, balsam, and cedar.

# Itasca County Timber Appraisal Report

<b>Appraised By:</b> Casey Dabrowski	<b>Sale Type:</b> SEALED BID-INTERMEDIATE	<b>Appraisal Number:</b> 20-02-05
<b>Appraisal Date:</b> 03/30/2020	<b>Auction Date:</b> 06/12/2020	<b>Permit Number:</b>
		<b>Expiration Date:</b> 03/01/2023
		<b>Page:</b> 3 of 3

**Site Map:**

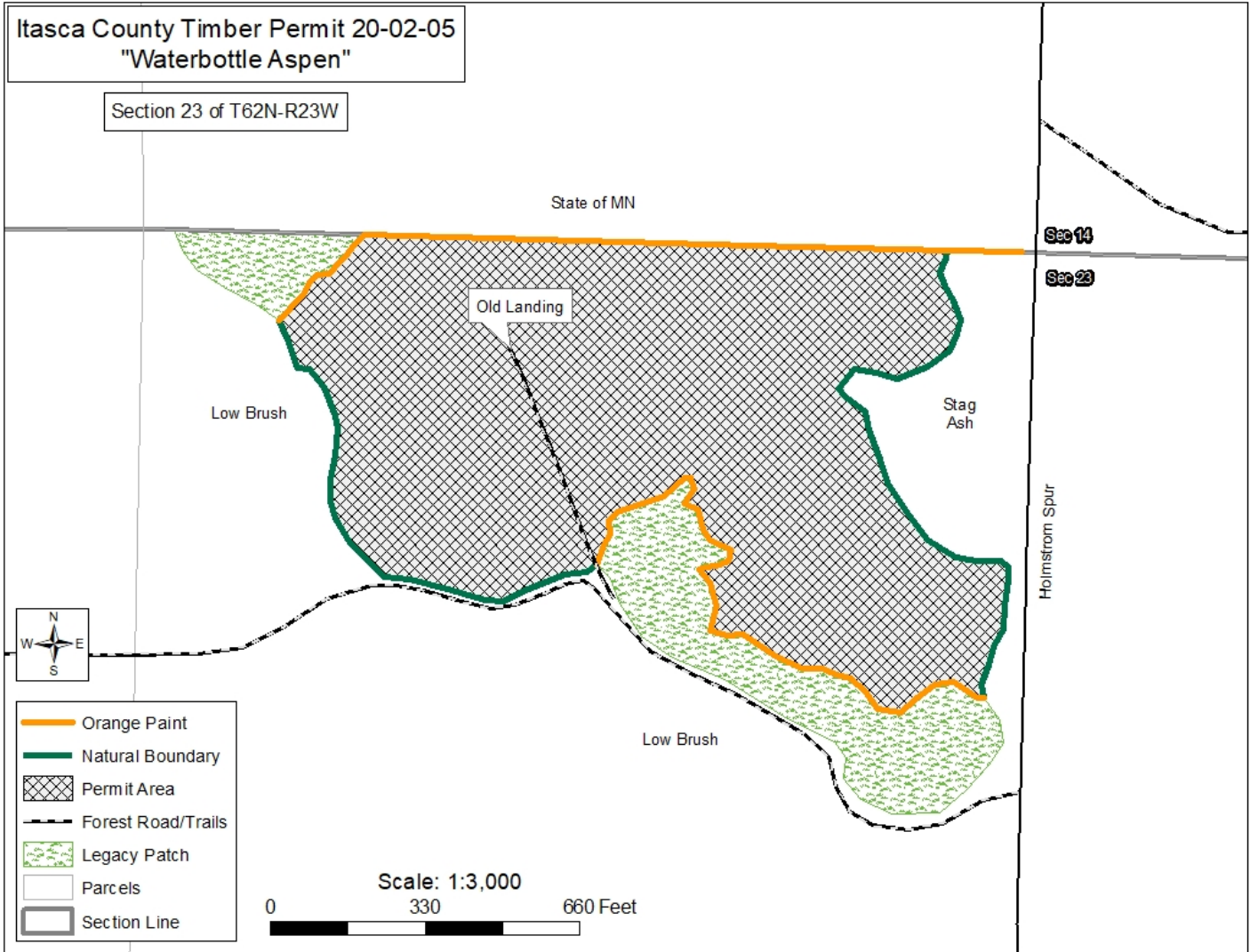

Appraisal examined and approved by \_\_\_\_\_  
Forester Date

Appraisal examined and approved by \_\_\_\_\_  
Land Department Date