

Itasca County Timber Appraisal Report

Appraised By: Jesse Lehner Appraisal Date: 08/13/2019	Sale Type: REGULAR AUCTION SALE Auction Date: 12/10/2019	Appraisal Number: 19-07-19 Permit Number: Expiration Date: 03/01/2023 Page: 1 of 3
--	---	---

Legal Description

<u>RE Code</u>	<u>Sec.</u>	<u>Twp.</u>	<u>Rge.</u>	<u>City/Twp</u>	<u>Subd</u>		
14-006-2000	6	54	22	Goodland	NW 1/4		
14-131-0000	31	55	22	Goodland	ALL SECTION 31		
<u>Block 1 Species</u>	<u>Volume</u>	<u>Units</u>	<u>Unit Price</u>	<u>Value</u>	<u>Comments</u>	<u>Bolt %</u>	<u>Bid</u>
Red Oak	330	Cords	\$22.00	\$7,260.00	15% saw, 2-5 stick, 7-18 inch Dbh, Good quality	40	^
Maple	179	Cords	\$9.00	\$1,611.00	1-4 stick, 6-12 Dbh, Fair quality	5	^
Basswood	81	Cords	\$9.00	\$729.00	3-6 stick, 8-14 Dbh, Good quality	50	^
Paper Birch	20	Cords	\$9.00	\$180.00	3-4 stick, 9-13 Dbh, Fair quality	20	#
				\$9,780.00	Subtotal		
Total Cords =	610		Total MBF: 0	\$9,780.00	Total		

Bid Symbols: ^ = Bid Species; # = Non-Bid Species; + = Sold Area Estimate; * = Sold Area Estimate & Non-Bid Species
 All species woodsrun unless listed otherwise.

Species Scaled: Basswood , Maple , Paper Birch , Red Oak

Species SAE:

Operability: Summer Dry: 7/1 - 10/1	Soil Type: Itasca-Goodland silt loams
Topography: Level to rolling	Cutting Acres: 33.9

All permits must follow Itasca County Forest Management Guidelines and Specifications (can be found at <http://www.co.itasca.mn.us/DocumentCenter/View/567/Forest-Management-Guidelines-and-Specifications>).

Harvest Specifications

Comments
Harvest type: Shelterwood (16.5 ac) & Seed tree (15.1 ac)

Harvest and Reserves
Cut all unmarked stems within permit area. Trees marked with "R" and/or ringed with blue paint are to be reserved. Reserve all non-hazardous snags.

Access
Gate must be locked at all times, except on days when 3 or more loads are hauled. Gates must remain locked during hunting season. ATV trail regulations in Itasca County Forest Management Guideline & Specifications apply. Approximately 2.2 miles to County Road 560.

Landings and Access Roads
Location and construction of any new roads/landings must be pre-approved by the sale administrator. Trails and landings need to be rehabilitated to a satisfactory condition before performance bond is returned. Access to permit area will require installation of one culvert. Itasca County Land Department can provide culvert. Timber sale administrator shall be notified at least 3 working days prior to completion of hauling and road work. This provides adequate time for permit area inspection and addressing of permit compliance requirements before hauling and road work equipment is removed.

Itasca County Timber Appraisal Report

Appraised By: Jesse Lehner Appraisal Date: 08/13/2019	Sale Type: REGULAR AUCTION SALE Auction Date: 12/10/2019	Appraisal Number: 19-07-19 Permit Number: Expiration Date: 03/01/2023 Page: 2 of 3
--	---	---

Cutting, Felling, and Skidding

Do not damage reserve trees.
 Do not fell timber into wetlands or across sale boundaries.
 Do not disturb survey markers, including witness trees.
 Sale boundaries painted with orange paint.

Site, Soil, and Water Protection

Filter strips require <5% soil disturbance within 50' of all wetlands.

Slash Disposal

Slash must be evenly distributed throughout permit area.

Regeneration Plan

Natural northern red oak regeneration

Itasca County Timber Appraisal Report

Appraised By: Jesse Lehner	Sale Type: REGULAR AUCTION SALE	Appraisal Number: 19-07-19
Appraisal Date: 08/13/2019	Auction Date: 12/10/2019	Permit Number:
		Expiration Date: 03/01/2023
		Page: 3 of 3

Site Map:

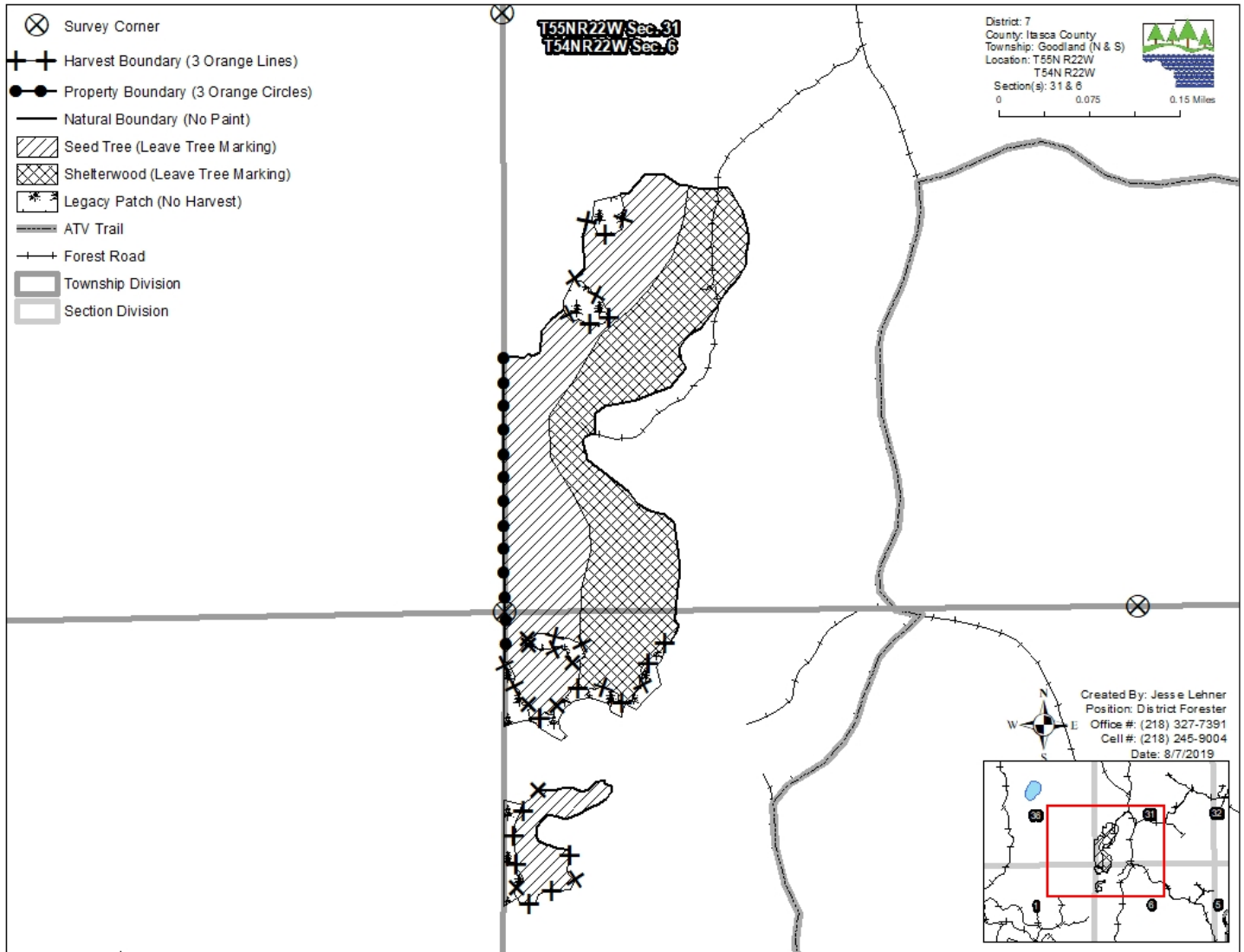

Appraisal examined and approved by _____
 Forester Date

Appraisal examined and approved by _____
 Land Department Date