

# Itasca County Timber Appraisal Report

<b>Appraised By:</b> Jesse Lehner  <b>Appraisal Date:</b> 06/24/2019	<b>Sale Type:</b> REGULAR AUCTION SALE  <b>Auction Date:</b> 12/10/2019	<b>Appraisal Number:</b> 19-07-18 <b>Permit Number:</b> <b>Expiration Date:</b> 03/01/2022 <b>Page:</b> 1 of 3
--	---	---

**Legal Description**

RE Code	Sec.	Twp.	Rge.	City/Twp	Subd		
14-129-3300	29	55	22	Goodland	SW SW		
14-130-0000	30	55	22	Goodland	ALL SECTION 30		
14-131-0000	31	55	22	Goodland	ALL SECTION 31		
14-132-2000	32	55	22	Goodland	NW 1/4		
Block 1 Species	Volume	Units	Unit Price	Value	Comments	Bolt %	Bid
Red Oak	555	Cords	\$26.00	\$14,430.00	20% saw, 3-6 stick, 10-22 inch Dbh, Good quality	50	^
Basswood	81	Cords	\$14.00	\$1,134.00	20% saw, 4-6 stick, 8-22 inch Dbh, Good quality	40	^
Maple	64	Cords	\$8.00	\$512.00	1-4 stick, 6-18 inch Dbh, Good quality		^
Aspen	18	Cords	\$22.00	\$396.00	6 stick, 16 inch Dbh, Good quality	5	#
				\$16,472.00	<b>Subtotal</b>		
<b>Total Cords =</b>	718	<b>Total MBF: 0</b>		\$16,472.00	<b>Total</b>		

Bid Symbols: ^ = Bid Species; # = Non-Bid Species; + = Sold Area Estimate; \* = Sold Area Estimate & Non-Bid Species  
 All species woodsrun unless listed otherwise.

**Species Scaled:** Aspen, Basswood , Maple , Red Oak  
**Species SAE:**

**Operability:** Winter Frozen: 12/1 - 3/1      **Soil Type:** Itasca-Goodland silt loams & Nashwauk fine sandy loams  
**Topography:** Level to rolling      **Cutting Acres:** 41.1

All permits must follow Itasca County Forest Management Guidelines and Specifications (can be found at <http://www.co.itasca.mn.us/DocumentCenter/View/567/Forest-Management-Guidelines-and-Specifications> ).

**Harvest Specifications**

Comments
Harvest type: Overstory removal

Harvest and Reserves
Reserve all non-hazardous snags. Trees marked with "R" are to be reserved for wildlife. Cut all stems within permit area.

Access
Harvest area is around the Big Ridge Cross Country Ski Trail. Snowmobile trail regulations in Itasca County Forest Management Guideline & Specifications apply. A minimum of two inches of compacted snow must remain on the trail as a running surface. 0.5 miles to public road County Road 560.

Landings and Access Roads
Location and construction of any new roads/landings must be pre-approved by the sale administrator. Timber sale administrator shall be notified at least 3 working days prior to completion of hauling and road work. This provides adequate time for permit area inspection and addressing of permit compliance requirements before hauling and road work equipment is removed.

## Itasca County Timber Appraisal Report

<b>Appraised By:</b> Jesse Lehner <b>Appraisal Date:</b> 06/24/2019	<b>Sale Type:</b> REGULAR AUCTION SALE <b>Auction Date:</b> 12/10/2019	<b>Appraisal Number:</b> 19-07-18 <b>Permit Number:</b> <b>Expiration Date:</b> 03/01/2022 <b>Page:</b> 2 of 3
--	---	---

### Cutting, Felling, and Skidding

Do not fell timber into wetlands or across sale boundaries.  
 Do not disturb survey markers, including witness trees.  
 Harvest boundaries painted orange paint. Natural (No Paint) boundaries also exist on this permit.

### Slash Disposal

Slash must be evenly distributed throughout permit area.

### Regeneration Plan

Natural Oak and Northern Hardwood Regeneration

# Itasca County Timber Appraisal Report

<b>Appraised By:</b> Jesse Lehner	<b>Sale Type:</b> REGULAR AUCTION SALE	<b>Appraisal Number:</b> 19-07-18
<b>Appraisal Date:</b> 06/24/2019	<b>Auction Date:</b> 12/10/2019	<b>Permit Number:</b>
		<b>Expiration Date:</b> 03/01/2022
		<b>Page:</b> 3 of 3

**Site Map:**

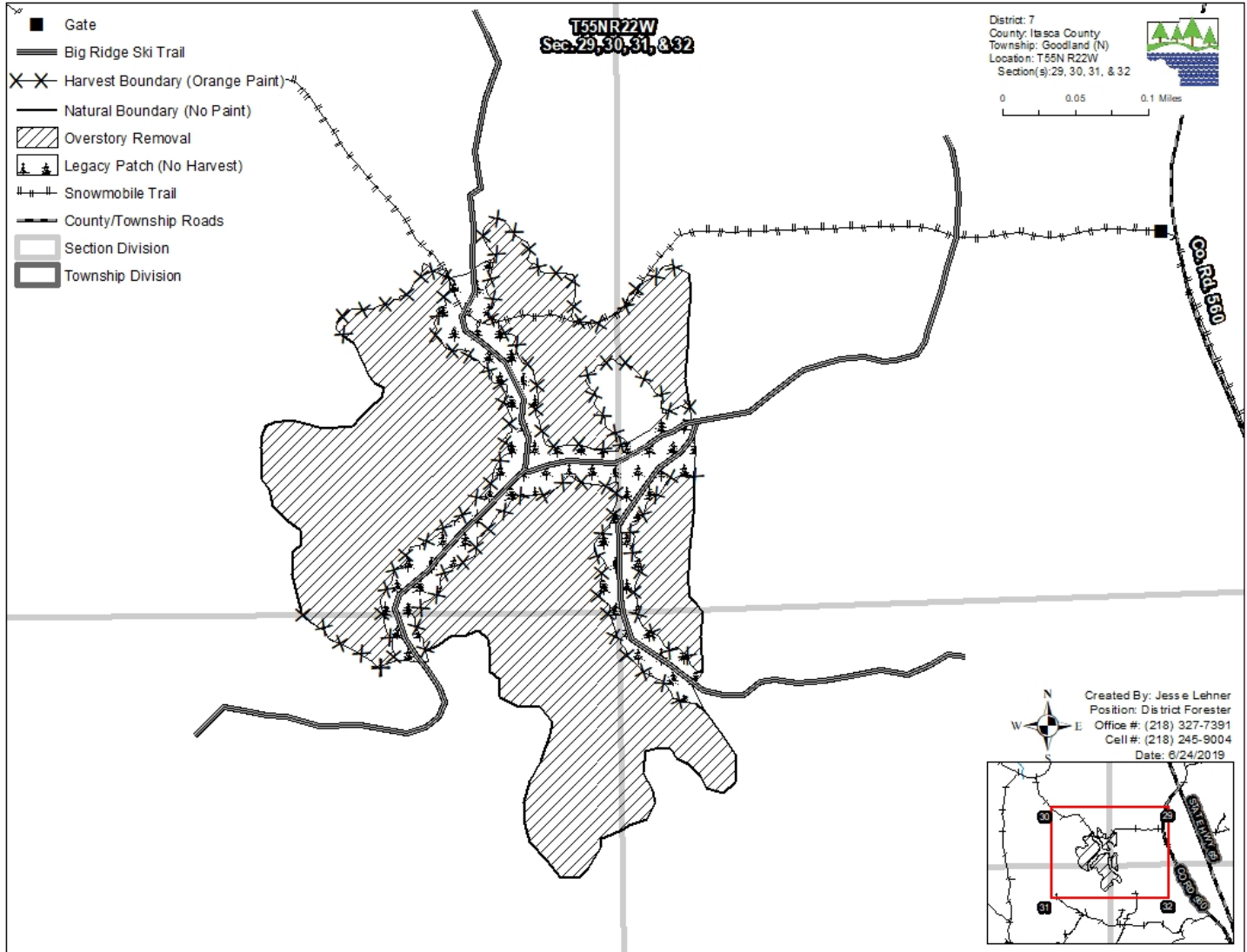

Appraisal examined and approved by \_\_\_\_\_  
Forester Date

Appraisal examined and approved by \_\_\_\_\_  
Land Department Date