

## Itasca County Timber Appraisal Report

<b>Appraised By:</b> Jesse Lehner	<b>Sale Type:</b> REGULAR AUCTION SALE	<b>Appraisal Number:</b> 19-07-16
<b>Appraisal Date:</b> 06/20/2019	<b>Auction Date:</b> 12/10/2019	<b>Permit Number:</b>
		<b>Expiration Date:</b> 03/01/2022
		<b>Page:</b> 1 of 3

**Legal Description**

<u>RE Code</u>	<u>Sec.</u>	<u>Twp.</u>	<u>Rge.</u>	<u>City/Twp</u>	<u>Subd</u>			
23-006-4000	6	57	24	Lawrence	SE 1/4			
<u>Block 1 Species</u>	<u>Volume</u>	<u>Units</u>	<u>Unit Price</u>	<u>Value</u>	<u>Comments</u>	<u>Bolt %</u>	<u>Bid</u>	
Aspen	676	Cords	\$23.00	\$15,548.00	3-7 stick, 7-14 inch Dbh, Good quality	20	^	
Ash	84	Cords	\$9.00	\$756.00	3-4 stick, 6-11 inch Dbh, Good quality	10	#	
				\$16,304.00	<b>Subtotal</b>			
<b>Total Cords =</b>	760		<b>Total MBF: 0</b>	\$16,304.00	<b>Total</b>			

Bid Symbols: ^ = Bid Species; # = Non-Bid Species; + = Sold Area Estimate; \* = Sold Area Estimate & Non-Bid Species  
All species woodsrun unless listed otherwise.

**Species Scaled:** Ash , Aspen

**Species SAE:**

**Operability:** Winter frozen: 7/1 - 10/1

**Soil Type:** Nashwauk fine sandy loam, Keewatin silt loam, Sandwick loamy sand

**Topography:** Flat

**Cutting Acres:** 23.2

All permits must follow Itasca County Forest Management Guidelines and Specifications (can be found at <http://www.co.itasca.mn.us/DocumentCenter/View/567/Forest-Management-Guidelines-and-Specifications> ).

**Harvest Specifications**

<b>Comments</b>
Harvest type: Clearcut w/reserves

**Harvest and Reserves**

Cut all aspen and ash stems within permit area. Reserve all non-aspen, non-ash species.  
Reserve all non-hazardous snags.  
Trees marked with "R" are to be reserved for wildlife.

**Access**

Access through Blandin properties, road must be kept in good condition at all times.  
Gate must be locked at all times, except on days when 3 or more loads are hauled.  
1.8 miles from County Road 50 to permit area.  
Snowmobile trail regulations in Itasca County Forest Management Guideline & Specifications apply. A minimum of two inches of compacted snow must remain on the trail as a running surface.

**Landings and Access Roads**

Location and construction of any new roads/landings must be pre-approved by the sale administrator.  
Trails and landings need to be rehabilitated to a satisfactory condition before performance bond is returned.  
Temporary water/wetland crossing needed on one or more locations. Remove crossing when harvesting activity is completed.  
Timber sale administrator shall be notified at least 3 working days prior to completion of hauling and road work. This provides adequate time for permit area inspection and addressing of permit compliance requirements before hauling and road work equipment is removed.

**Cutting, Felling, and Skidding**

Do not damage reserve trees.  
Do not fell timber into wetlands or across sale boundaries.  
Property boundaries are painted in blue paint. Harvest boundaries are painted in orange paint.

**Itasca County Timber Appraisal Report**

<b>Appraised By:</b> Jesse Lehner	<b>Sale Type:</b> REGULAR AUCTION SALE	<b>Appraisal Number:</b> 19-07-16
<b>Appraisal Date:</b> 06/20/2019	<b>Auction Date:</b> 12/10/2019	<b>Permit Number:</b>
		<b>Expiration Date:</b> 03/01/2022
		<b>Page:</b> 2 of 3

**Slash Disposal**

Slash must be evenly distributed throughout permit area.

**Regeneration Plan**

Natural Aspen Regeneration

# Itasca County Timber Appraisal Report

<b>Appraised By:</b> Jesse Lehner	<b>Sale Type:</b> REGULAR AUCTION SALE	<b>Appraisal Number:</b> 19-07-16
<b>Appraisal Date:</b> 06/20/2019	<b>Auction Date:</b> 12/10/2019	<b>Permit Number:</b>
		<b>Expiration Date:</b> 03/01/2022
		<b>Page:</b> 3 of 3

**Site Map:**

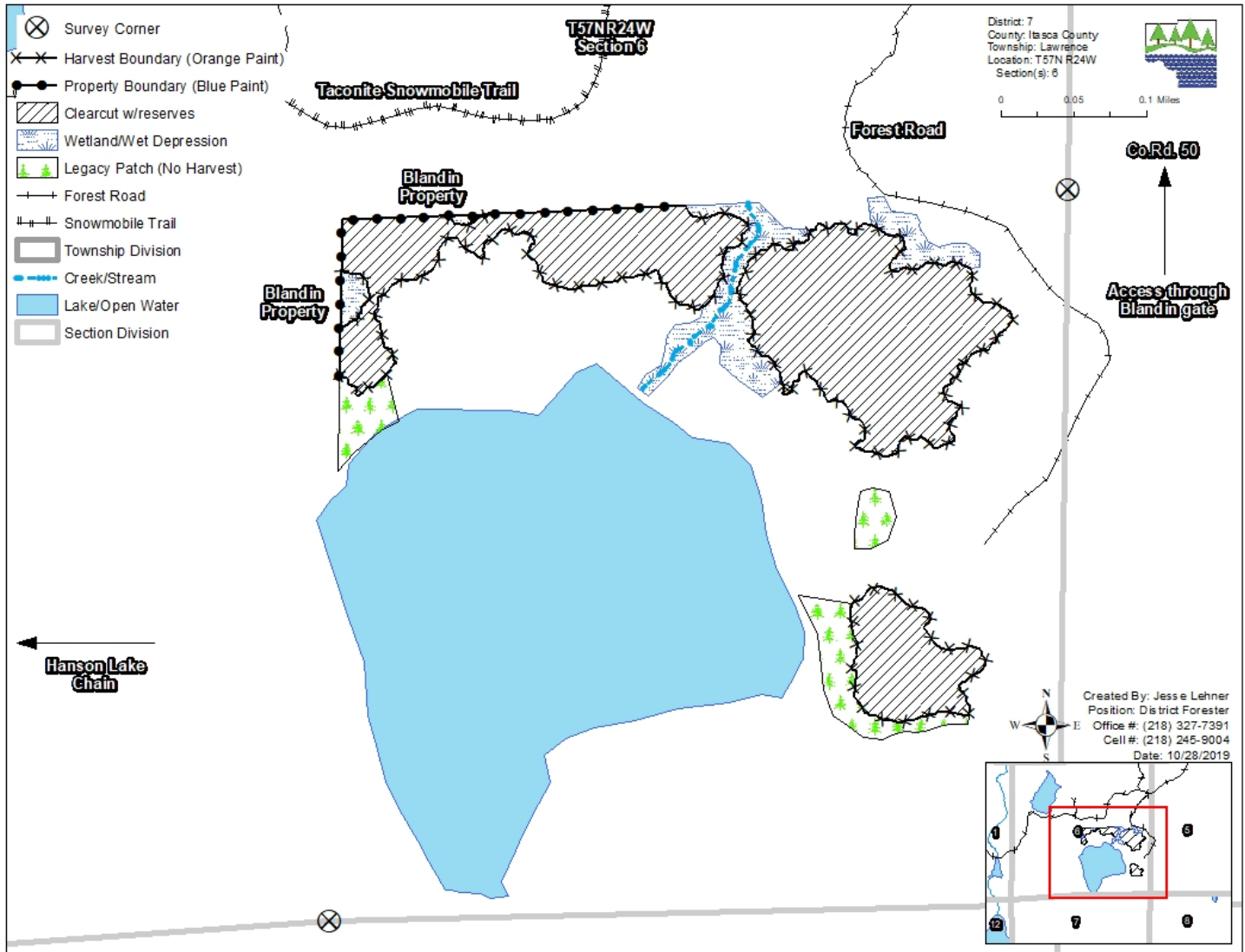

Appraisal examined and approved by \_\_\_\_\_  
Forester Date

Appraisal examined and approved by \_\_\_\_\_  
Land Department Date