

Itasca County Timber Appraisal Report

Appraised By:

Jesse Lehner

Appraisal Date:

06/19/2019

Sale Type:

REGULAR AUCTION SALE

Auction Date:

12/10/2019

Appraisal Number: 19-07-15**Permit Number:****Expiration Date:** 03/01/2023**Page:** 1 of 3**Legal Description**

RE Code	Sec.	Twp.	Rge.	City/Twp	Subd			
30-105-1300	5	57	23	Nashwauk	SW NE			
30-105-1400	5	57	23	Nashwauk	SE NE			
30-105-4200	5	57	23	Nashwauk	NW SE			
Block 1 Species	Volume	Units	Unit Price	Value	Comments	Bolt %	Bid	
Red Pine	727	Cords	\$44.00	\$31,988.00	8-9 stick, 14-26 inch Dbh, 70% saw, Good quality	20	^	
Aspen	144	Cords	\$26.00	\$3,744.00	4-6 stick, 12-16 inch Dbh, Fair quality	5	^	
Balsam Fir	92	Cords	\$14.00	\$1,288.00	3-4 stick, 7-13 inch Dbh, Fair quality	10	#	
Spruce	12	Cords	\$17.00	\$204.00	3-7 stick, 7-14 inch Dbh, Good quality, 100% white spruce		#	
Paper Birch	7	Cords	\$8.00	\$56.00			#	
Maple	4	Cords	\$8.00	\$32.00			#	
Jack Pine	4	Cords	\$8.00	\$32.00			#	
				\$37,344.00	Subtotal			
Total Cords =	990		Total MBF: 0	\$37,344.00	Total			

Bid Symbols: ^ = Bid Species; # = Non-Bid Species; + = Sold Area Estimate; * = Sold Area Estimate & Non-Bid Species
All species woodsrun unless listed otherwise.

Species Scaled: Aspen, Balsam Fir, Jack Pine, Maple, Paper Birch, Red Pine, Spruce

Species SAE:

Operability: Summer Dry: 7/1 - 10/1
Soil Type: Nashwauk fine sandy loam
Topography: Level to rolling
Cutting Acres: 17.8

All permits must follow Itasca County Forest Management Guidelines and Specifications (can be found at <http://www.co.itasca.mn.us/DocumentCenter/View/567/Forest-Management-Guidelines-and-Specifications>).

Harvest Specifications

Comments
Harvest type: Clearcut w/reserves
Harvest and Reserves
Cut all stems within the permit area except reserve species. Reserve all white pine and oak species. Reserve all non-hazardous snags. Trees marked with "R" are to be reserved for wildlife.
Access
Access is through Bray Lake Canister site. Gate must be locked at all times, even on days when multiple loads are hauled.

Itasca County Timber Appraisal Report

Appraised By: Jesse Lehner Appraisal Date: 06/19/2019	Sale Type: REGULAR AUCTION SALE Auction Date: 12/10/2019	Appraisal Number: 19-07-15 Permit Number: Expiration Date: 03/01/2023 Page: 2 of 3
--	---	---

Landings and Access Roads

Location and construction of any new roads/landings must be pre-approved by the sale administrator.
 Trails and landings need to be rehabilitated to a satisfactory condition before performance bond is returned.
 Timber sale administrator shall be notified at least 3 working days prior to completion of hauling and road work. This provides adequate time for permit area inspection and addressing of permit compliance requirements before hauling and road work equipment is removed.

Cutting, Felling, and Skidding

Do not damage reserve trees.
 Do not fell timber into wetlands or across sale boundaries.
 Property boundaries are painted with blue paint. Harvest boundaries are painted in orange paint.

Site, Soil, and Water Protection

Filter strips require <5% soil disturbance within 50' of all wetlands.
 Roads and skid trails must be stabilized. This may involve installing water bars, strike outs, and/or mulching and seeding.

Slash Disposal

Slash must be evenly distributed throughout permit area.

Special Conditions

Logging season may be restricted to August through February during high bark beetle risk. All cut pine must be hauled within 3 weeks during June through August.

Regeneration Plan

Regeneration of this stand back to red pine will be done by hand planting.

Itasca County Timber Appraisal Report

Appraised By: Jesse Lehner	Sale Type: REGULAR AUCTION SALE	Appraisal Number: 19-07-15
Appraisal Date: 06/19/2019	Auction Date: 12/10/2019	Permit Number:
		Expiration Date: 03/01/2023
		Page: 3 of 3

Site Map:

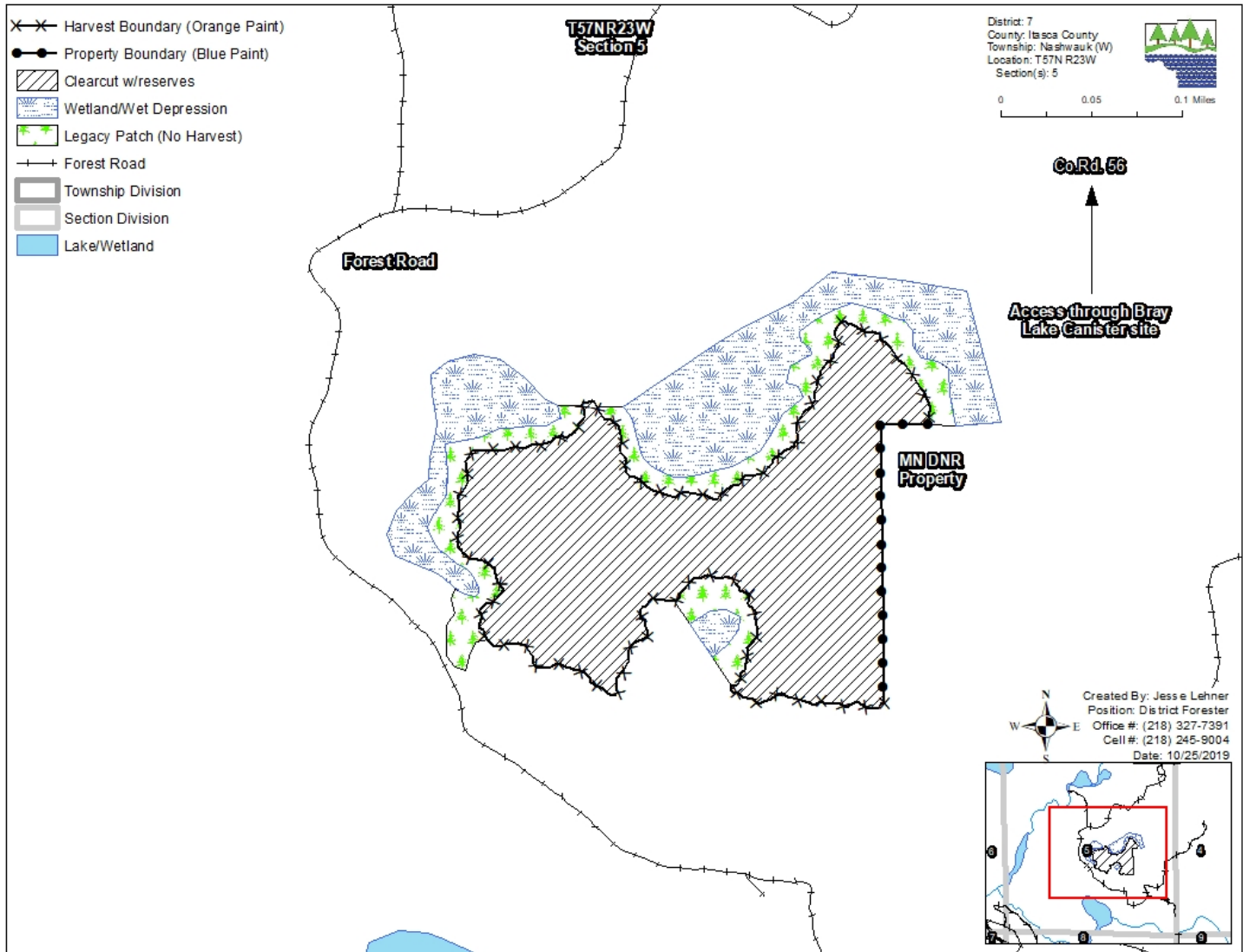

Appraisal examined and approved by _____ Forester _____ Date _____

Appraisal examined and approved by _____ Land Department _____ Date _____