

Itasca County Timber Appraisal Report

| | | |
|--|---|---|
| Appraised By: Jesse Lehner Appraisal Date: 03/13/2019 | Sale Type: REGULAR AUCTION SALE Auction Date: 06/07/2019 | Appraisal Number: 19-07-07 Permit Number: Expiration Date: 03/01/2022 Page: 2 of 3 |
|--|---|---|

Cutting, Felling, and Skidding

Timber must be processed at the stump.
 Do not damage reserve trees.
 Do not fell timber into wetlands or across sale boundaries.
 Sale boundaries painted with orange paint. Natural boundaries also exist for this permit.

Site, Soil, and Water Protection

Filter strips require <5% soil disturbance within 50' of all wetlands.
 Roads and skid trails must be stabilized. This may involve installing water bars, strike outs, and/or mulching and seeding.

Slash Disposal

Slash must be evenly distributed throughout permit area.

Special Conditions

Logging season may be restricted to August through February during high bark beetle risk. All cut pine must be hauled within 3 weeks during May through September.

Itasca County Timber Appraisal Report

| | | |
|--------------------------------------|---|------------------------------------|
| Appraised By: Jesse Lehner | Sale Type: REGULAR AUCTION SALE | Appraisal Number: 19-07-07 |
| Appraisal Date: 03/13/2019 | Auction Date: 06/07/2019 | Permit Number: |
| | | Expiration Date: 03/01/2022 |
| | | Page: 3 of 3 |

Site Map:

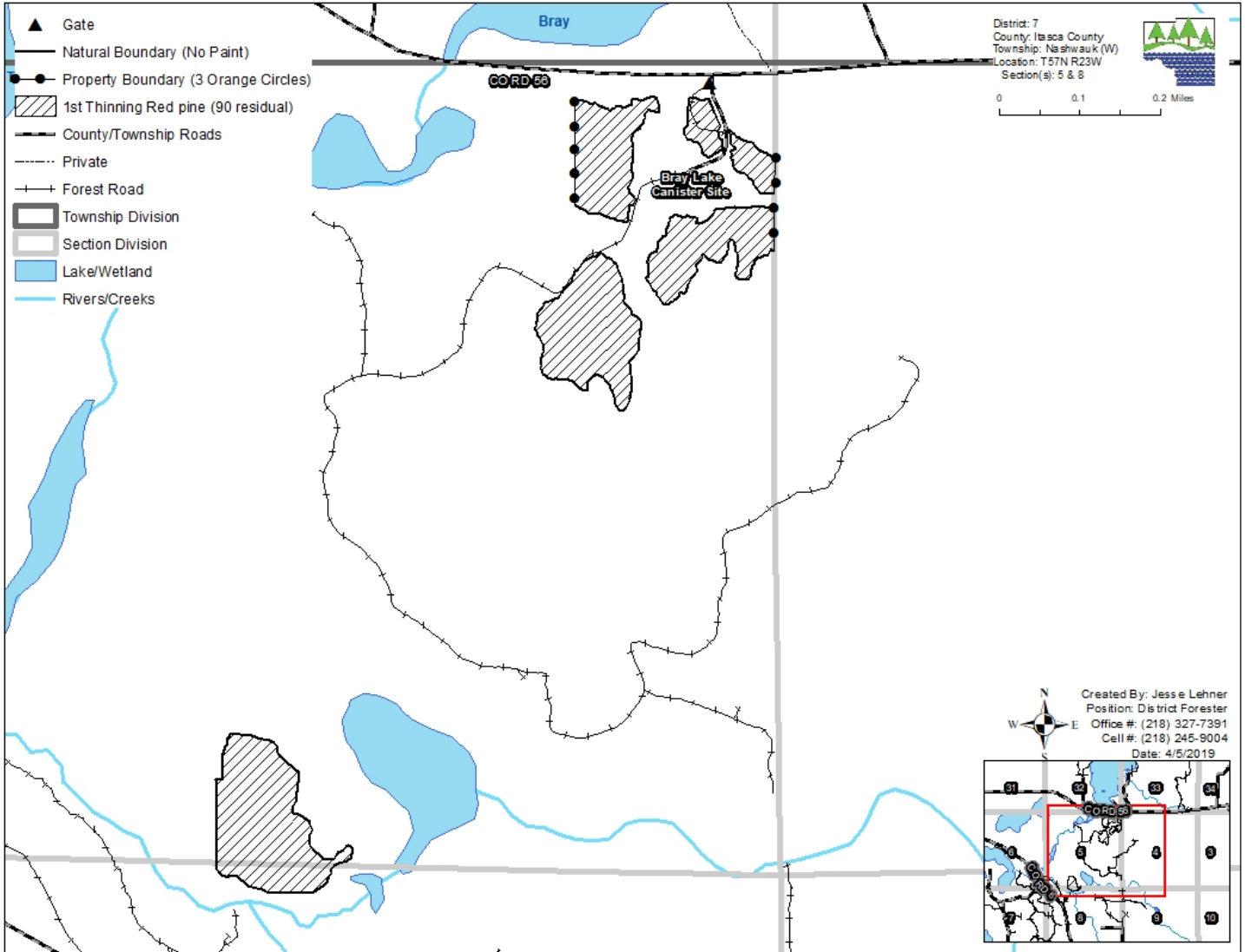

Appraisal examined and approved by _____ Forester _____ Date _____