

Itasca County Timber Appraisal Report

Appraised By: Jesse Lehner Appraisal Date: 03/04/2019	Sale Type: REGULAR AUCTION SALE Auction Date: 06/07/2019	Appraisal Number: 19-07-06 Permit Number: Expiration Date: 03/01/2022 Page: 1 of 2
--	---	---

Legal Description

<u>RE Code</u>	<u>Sec.</u>	<u>Twp.</u>	<u>Rge.</u>	<u>City/Twp</u>	<u>Subd</u>		
50-013-2300	13	55	23	Unorganized	SW NW		
50-013-2400	13	55	23	Unorganized	SE NW		
50-013-3000	13	55	23	Unorganized	SW 1/4		
<u>Block 1 Species</u>	<u>Volume</u>	<u>Units</u>	<u>Unit Price</u>	<u>Value</u>	<u>Comments</u>	<u>Bolt %</u>	<u>Bid</u>
Red Pine	187	Cords	\$26.00	\$4,862.00	6-7 stick, 9-11 Dbh, Good quality, 10% saw	60	^
				\$4,862.00	Subtotal		
Total Cords =		187	Total MBF: 0		\$4,862.00	Total	

Bid Symbols: ^ = Bid Species; # = Non-Bid Species; + = Sold Area Estimate; * = Sold Area Estimate & Non-Bid Species
 All species woodsrun unless listed otherwise.

Species Scaled: Red Pine
Species SAE:

Operability: Summer Dry: 7/1 - 10/1 **Soil Type:** Nashwauk fine sandy loam
Topography: Level to rolling **Cutting Acres:** 12.0

Harvest Specifications

Comments
Harvest type: Unmarked red pine thin (3rd thinning)

Harvest and Reserves
Reserve all non-hazardous snags. Unmarked red pine thin: Use existing clearcut strips and thin from below, removing poorest quality first, to a residual BA of 100 sqft/acre.

Access
Gate must be locked at all times, except on days when 3 or more loads are hauled. Approximately .5 miles to public road County road 560.

Landings and Access Roads
Location and construction of any new roads/landings must be pre-approved by the sale administrator. Trails and landings need to be rehabilitated to a satisfactory condition before performance bond is returned.

Cutting, Felling, and Skidding
Timber must be processed at the stump. Do not damage reserve trees. Do not fell timber into wetlands or across sale boundaries. All sale boundaries are natural, no paint has been used.

Slash Disposal
Slash must be evenly distributed throughout permit area.

Special Conditions
Logging season may be restricted to August through February during high bark beetle risk. All cut pine must be hauled within 3 weeks during May through September.

Itasca County Timber Appraisal Report

Appraised By: Jesse Lehner	Sale Type: REGULAR AUCTION SALE	Appraisal Number: 19-07-06
Appraisal Date: 03/04/2019	Auction Date: 06/07/2019	Permit Number:
		Expiration Date: 03/01/2022
		Page: 2 of 2

Site Map:

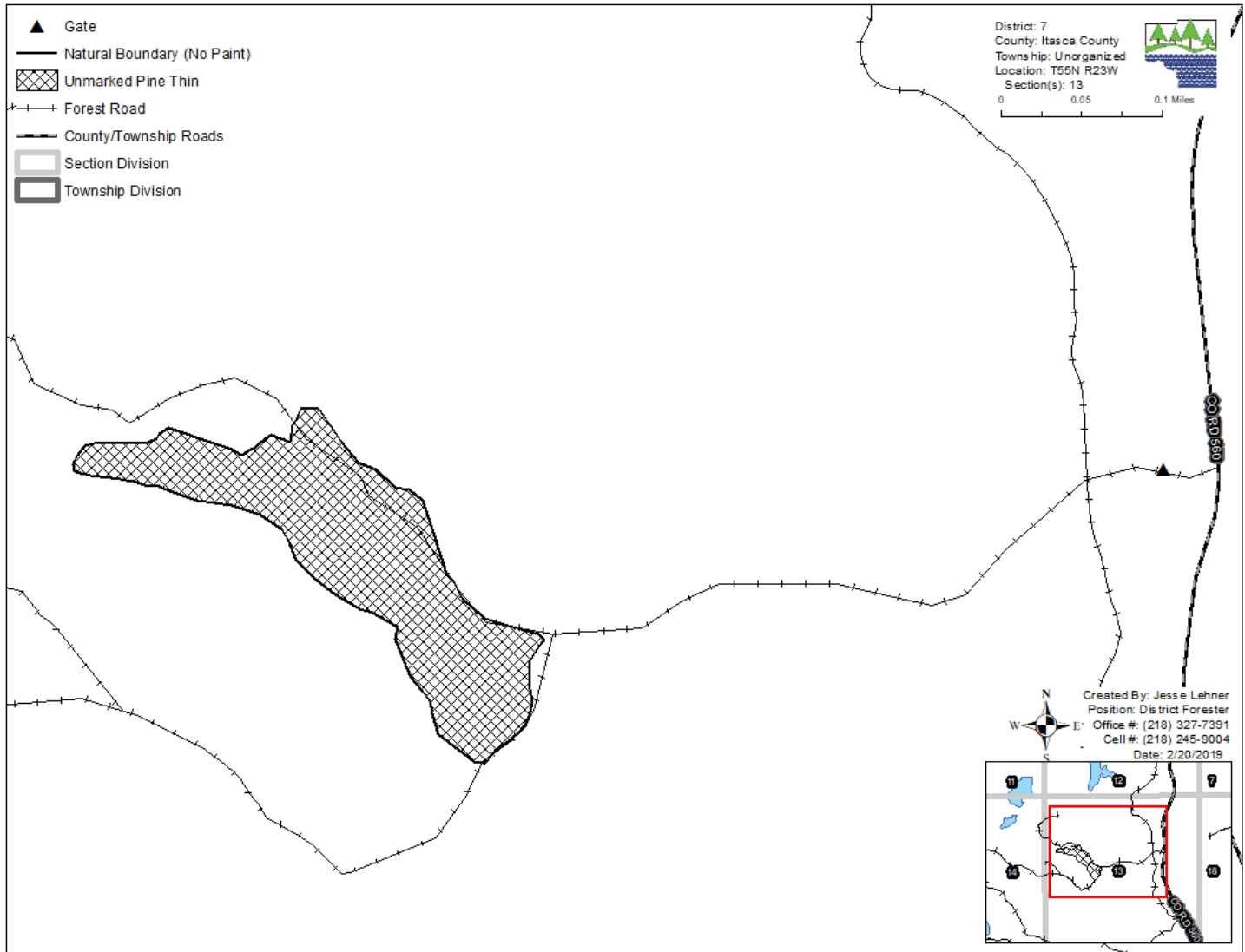

Appraisal examined and approved by _____ Forester _____ Date _____