

Itasca County Timber Appraisal Report

Appraised By: Jesse Lehner Appraisal Date: 03/04/2019	Sale Type: REGULAR AUCTION SALE Auction Date: 06/07/2019	Appraisal Number: 19-07-05 Permit Number: Expiration Date: 03/01/2022 Page: 1 of 3
--	---	---

Legal Description

<u>RE Code</u>	<u>Sec.</u>	<u>Twp.</u>	<u>Rge.</u>	<u>City/Twp</u>	<u>Subd</u>
14-109-1000	9	55	22	Goodland	NE 1/4
14-109-2100	9	55	22	Goodland	NE NW

<u>Block 1 Species</u>	<u>Volume</u>	<u>Units</u>	<u>Unit Price</u>	<u>Value</u>	<u>Comments</u>	<u>Bolt %</u>	<u>Bid</u>
Aspen	1,149	Cords	\$24.00	\$27,576.00	5-7 stick, 6-18 Dbh, Good quality	30	^
Spruce	20	Cords	\$17.00	\$340.00	4-5 stick, 6-7 Dbh, Good quality, 100% black spruce		#
Tamarack	5	Cords	\$5.00	\$25.00	4-5 stick, 6-7 Dbh, Good quality		#
				\$27,941.00	Subtotal		
Total Cords =	1,174	Total MBF: 0		\$27,941.00	Total		

Bid Symbols: ^ = Bid Species; # = Non-Bid Species; + = Sold Area Estimate; * = Sold Area Estimate & Non-Bid Species
 All species woodsrun unless listed otherwise.

Species Scaled: Aspen, Spruce , Tamarack

Species SAE:

Operability: Winter Frozen Only: 12/1 - 3/1	Soil Type: Cutaway loamy sand
Topography: Level to rolling	Cutting Acres: 34.7

Harvest Specifications

Comments
Harvest type: Clearcut w/reserves

Harvest and Reserves
Reserve all non-hazardous snags. Trees marked with "R" are to be reserved for wildlife. Aspen clearcut w/reserves: Cut all stems within aspen clearcut w/reserves area, unless they meet reserve species specifications. Reserve all non-aspen species. Reserve 5-6 individual non-aspen species scattered throughout clearcut area. If non-aspen species do not exist, reserve aspen in order to maintain 5-6 trees per acre. Spruce clearcut w/reserves: Cut all stems within spruce clearcut w/reserves area, unless they meet reserve species specifications. Reserve all species besides aspen, spruce, and tamarack within spruce clearcut area.

Landings and Access Roads
Location and construction of any new roads/landings must be pre-approved by the sale administrator. Trails and landings need to be rehabilitated to a satisfactory condition before performance bond is returned. Berm(s) must be installed after sale is completed. Reserve all non-merchantable timber within 15ft of roads.

Cutting, Felling, and Skidding
Do not damage reserve trees. Do not fell timber into wetlands or across sale boundaries. Sale boundaries are painted in Blue and Orange. See map for details.

Itasca County Timber Appraisal Report

Appraised By: Jesse Lehner Appraisal Date: 03/04/2019	Sale Type: REGULAR AUCTION SALE Auction Date: 06/07/2019	Appraisal Number: 19-07-05 Permit Number: Expiration Date: 03/01/2022 Page: 2 of 3
--	---	---

Site, Soil, and Water Protection

Reserve all non-merchantable timber within 15ft of all wetlands.

Slash Disposal

Slash must be evenly distributed throughout permit area.

Slash height must not exceed 3 ft. within view of road.

Regeneration Plan

Natural Regeneration

Itasca County Timber Appraisal Report

Appraised By:
Jesse Lehner
Appraisal Date:
03/04/2019

Sale Type:
REGULAR AUCTION SALE
Auction Date:
06/07/2019

Appraisal Number: 19-07-05
Permit Number:
Expiration Date: 03/01/2022
Page: 3 of 3

Site Map:

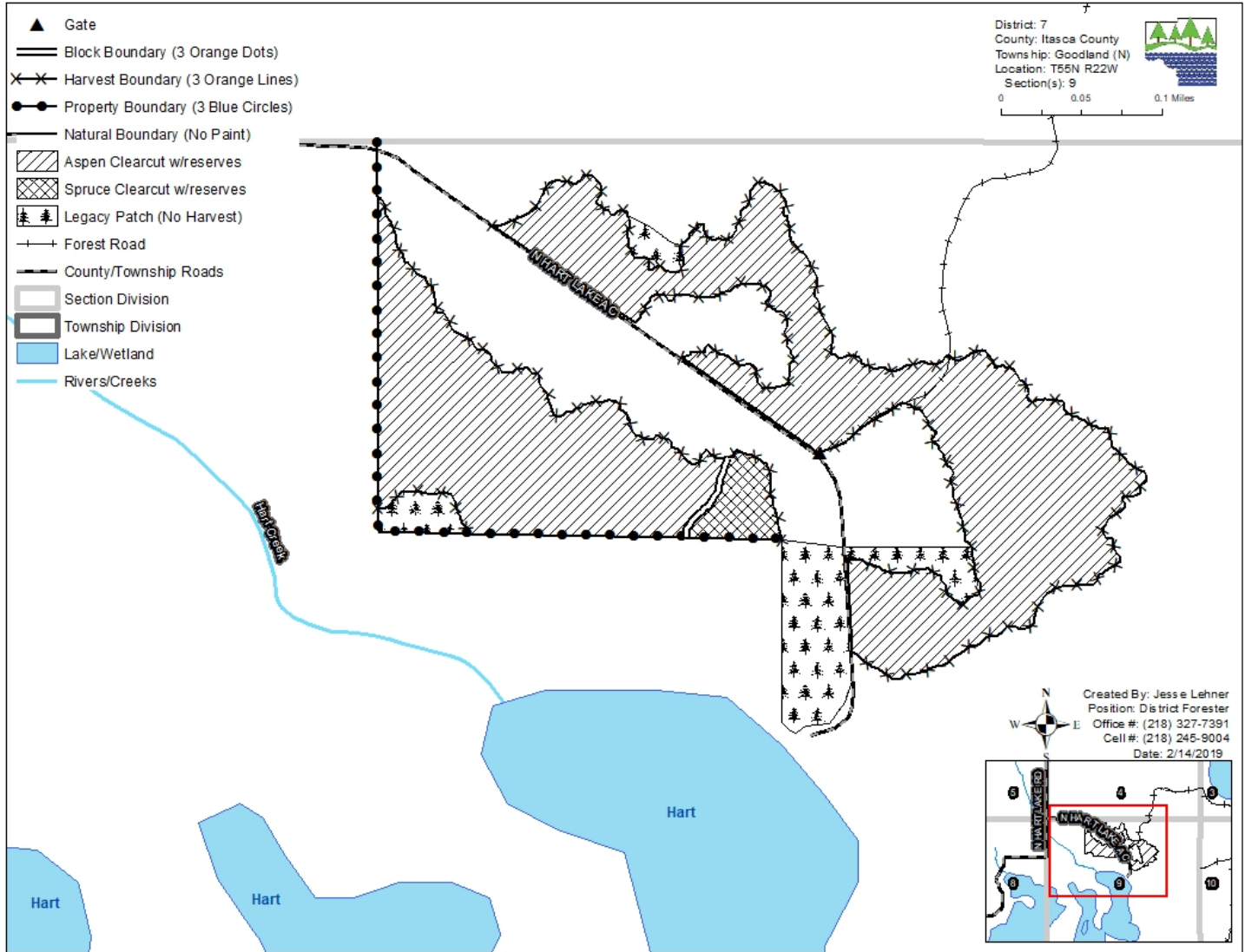

Appraisal examined and approved by _____ Forester _____ Date _____