

## Itasca County Timber Appraisal Report

<b>Appraised By:</b> Jesse Lehner <b>Appraisal Date:</b> 03/04/2019	<b>Sale Type:</b> REGULAR AUCTION SALE <b>Auction Date:</b> 06/07/2019	<b>Appraisal Number:</b> 19-07-04 <b>Permit Number:</b> <b>Expiration Date:</b> 03/01/2022 <b>Page:</b> 1 of 3
--	---	---

**Legal Description**

RE Code	Sec.	Twp.	Rge.	City/Twp	Subd		
68-002-4000	2	54	27	Unorganized	SE 1/4		
68-002-1000	2	54	27	Unorganized	NE 1/4		
68-001-0000	1	54	27	Unorganized	ALL OF SECTION 1		
Block 1 Species	Volume	Units	Unit Price	Value	Comments	Bolt %	Bid
Aspen	591	Cords	\$25.00	\$14,775.00	5-7 stick, 7-20 Dbh, Fair quality	5	^
Basswood	63	Cords	\$6.00	\$378.00	3-5 stick, 9-14 Dbh, Fair quality	15	#
Red Oak	51	Cords	\$18.00	\$918.00	5-6 stick, 12-22 Dbh, Fair quality, 10% saw	30	#
Maple	29	Cords	\$8.00	\$232.00	1-4 stick, 6-14 Dbh, Fair quality		#
Paper Birch	22	Cords	\$10.00	\$220.00	3-5 stick, 8-12 Dbh, Fair quality	20	#
				\$16,523.00	<b>Subtotal</b>		
<b>Total Cords =</b>	756			<b>Total MBF: 0</b>	<b>Total</b>		

Bid Symbols: ^ = Bid Species; # = Non-Bid Species; + = Sold Area Estimate; \* = Sold Area Estimate & Non-Bid Species  
 All species woodsrun unless listed otherwise.

**Species Scaled:** Aspen, Basswood , Maple , Paper Birch , Red Oak

**Species SAE:**

<b>Operability:</b> Summer Dry/Winter Frozen	<b>Soil Type:</b> Itasca-Goodland silt loams
<b>Topography:</b> Rolling	<b>Cutting Acres:</b> 27.3

**Harvest Specifications**

Comments
Harvest type: Clearcut w/reserves Recommend harvest to occur early in permit timeframe, due to recent windthrow and age of stand.

Harvest and Reserves
Reserve all non-hazardous snags. Trees marked with "R" are to be reserved for wildlife. Northern Block: Cut all aspen and paper birch within northern block. Reserve all other species within cutting block. Southern Block: Cut all stems within southern block unless designated as reserve. Reserve 5-6 leave tree per acre. Leave trees can be any non-aspen species currently scattered throughout the southern block. Leave trees must be single stamned and have a full crown.

Access
Gate must be locked at all times, except on days when 3 or more loads are hauled. 1.5 miles to County Road 242.

Landings and Access Roads
Location and construction of any new roads/landings must be pre-approved by the sale administrator. Trails and landings need to be rehabilitated to a satisfactory condition before performance bond is returned.

## Itasca County Timber Appraisal Report

<b>Appraised By:</b> Jesse Lehner <b>Appraisal Date:</b> 03/04/2019	<b>Sale Type:</b> REGULAR AUCTION SALE <b>Auction Date:</b> 06/07/2019	<b>Appraisal Number:</b> 19-07-04 <b>Permit Number:</b> <b>Expiration Date:</b> 03/01/2022 <b>Page:</b> 2 of 3
--	---	---

### Cutting, Felling, and Skidding

Do not damage reserve trees.  
 Do not fell timber into wetlands or across sale boundaries.  
 Do not disturb survey markers, including witness trees.  
 Sale boundaries painted in orange.

### Site, Soil, and Water Protection

Roads and skid trails must be stabilized. This may involve installing water bars, strike outs, and/or mulching and seeding.

### Slash Disposal

Slash must be evenly distributed throughout permit area.

### Regeneration Plan

Natural Regeneration

# Itasca County Timber Appraisal Report

<b>Appraised By:</b> Jesse Lehner	<b>Sale Type:</b> REGULAR AUCTION SALE	<b>Appraisal Number:</b> 19-07-04
<b>Appraisal Date:</b> 03/04/2019	<b>Auction Date:</b> 06/07/2019	<b>Permit Number:</b>
		<b>Expiration Date:</b> 03/01/2022
		<b>Page:</b> 3 of 3

**Site Map:**

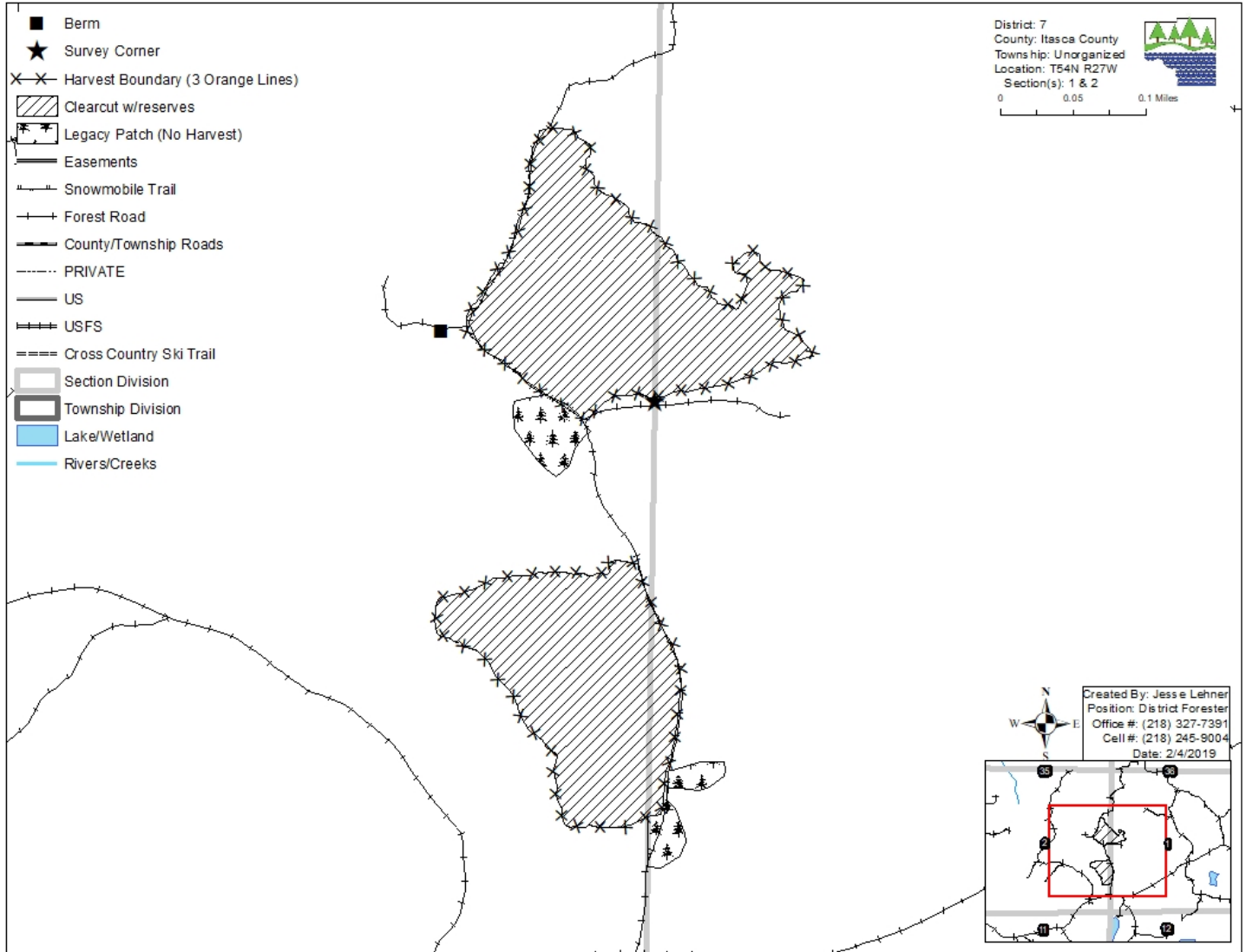

Appraisal examined and approved by \_\_\_\_\_ Forester \_\_\_\_\_ Date \_\_\_\_\_