

# Itasca County Timber Appraisal Report

<b>Appraised By:</b> Jesse Lehner  <b>Appraisal Date:</b> 03/04/2019	<b>Sale Type:</b> REGULAR AUCTION SALE  <b>Auction Date:</b> 06/07/2019	<b>Appraisal Number:</b> 19-07-03 <b>Permit Number:</b> <b>Expiration Date:</b> 03/01/2022 <b>Page:</b> 1 of 3
--	---	---

**Legal Description**

<u>RE Code</u>	<u>Sec.</u>	<u>Twp.</u>	<u>Rge.</u>	<u>City/Twp</u>	<u>Subd</u>
50-028-4000	28	55	23	Unorganized	SE 1/4
50-033-1000	33	55	23	Unorganized	NE 1/4

<u>Block 1 Species</u>	<u>Volume</u>	<u>Units</u>	<u>Unit Price</u>	<u>Value</u>	<u>Comments</u>	<u>Bolt %</u>	<u>Bid</u>
Aspen	353	Cords	\$26.00	\$9,178.00	5-6 stick, 8-9 Dbh, Good quality	20	^
Tamarack	86	Cords	\$4.00	\$344.00	3-5 stick, 7-9 Dbh		#
Spruce	73	Cords	\$14.00	\$1,022.00	3-5 stick, 7-9 Dbh, 100% black spruce		#
				<b>\$10,544.00</b>	<b>Subtotal</b>		
<b>Total Cords =</b>	<b>512</b>		<b>Total MBF: 0</b>	<b>\$10,544.00</b>	<b>Total</b>		

Bid Symbols: ^ = Bid Species; # = Non-Bid Species; + = Sold Area Estimate; \* = Sold Area Estimate & Non-Bid Species  
 All species woodsrun unless listed otherwise.

**Species Scaled:** Aspen, Spruce, Tamarack

**Species SAE:**

<b>Operability:</b> Aspen clearcut w/reserves (Dry summer): 7/1 - 10/1, Spruce clearcut w/reserves (Winter frozen): 12/1 - 3/1	<b>Soil Type:</b> Itasca Silt Loam and Mooselake & Lupton mucky peats
<b>Topography:</b> Level to rolling	<b>Cutting Acres:</b> 28.1

**Harvest Specifications**

Comments
Harvest type: Clearcut w/reserves

Harvest and Reserves
Reserve all non-hazardous snags. Aspen clearcut w/reserves: Reserve 5-6 individual non-aspen species trees per acres scattered throughout clearcut area. If non-aspen species do not exist, reserve aspen in order to maintain 5-6 trees per acre. Reserve all non-aspen species within Aspen clearcut area. Spruce clearcut w/reserves Reserve 5-6 individual Tamarack per acre scattered throughout clearcut area. All spruce greater than 5 feet in height must be severed. Reserve all northwest cedar and birch within Spruce clearcut area.

Landings and Access Roads
Location and construction of any new roads/landings must be pre-approved by the sale administrator. Berm(s) must be installed after sale is completed.

Cutting, Felling, and Skidding
Do not damage reserve trees. Do not fell timber into wetlands or across sale boundaries. Sale boundaries painted orange, but natural boundaries do exist for this permit.

Slash Disposal
Slash must be evenly distributed throughout permit area.

**Itasca County Timber Appraisal Report**

<b>Appraised By:</b> Jesse Lehner	<b>Sale Type:</b> REGULAR AUCTION SALE	<b>Appraisal Number:</b> 19-07-03
<b>Appraisal Date:</b> 03/04/2019	<b>Auction Date:</b> 06/07/2019	<b>Permit Number:</b>
		<b>Expiration Date:</b> 03/01/2022
		<b>Page:</b> 2 of 3

**Regeneration Plan**

Natural Regeneration

# Itasca County Timber Appraisal Report

**Appraised By:**  
Jesse Lehner  
**Appraisal Date:**  
03/04/2019

**Sale Type:**  
REGULAR AUCTION SALE  
**Auction Date:**  
06/07/2019

**Appraisal Number:** 19-07-03  
**Permit Number:**  
**Expiration Date:** 03/01/2022  
**Page:** 3 of 3

**Site Map:**

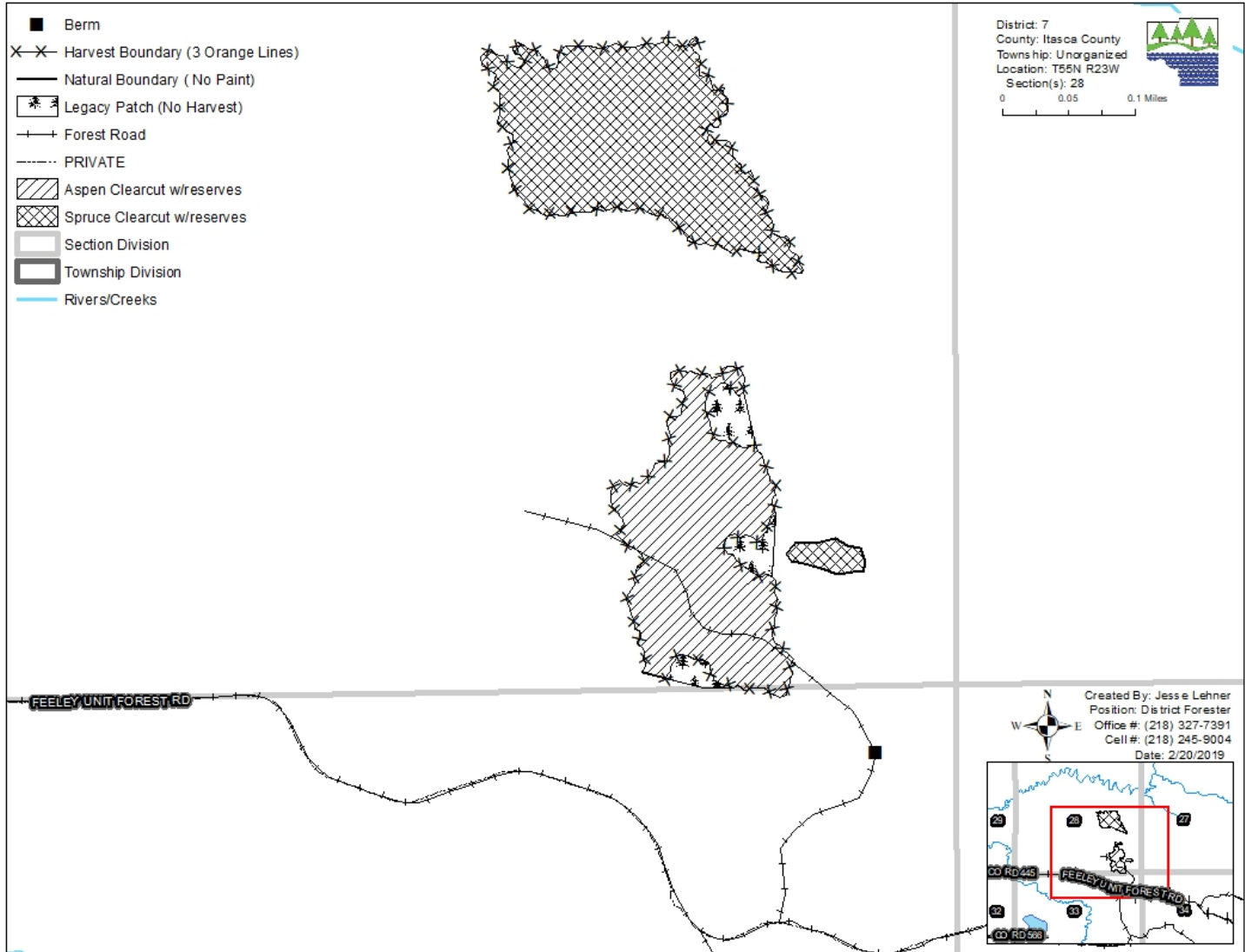

Appraisal examined and approved by \_\_\_\_\_

Forester

Date