

Itasca County Timber Appraisal Report

Appraised By: Jesse Lehner Appraisal Date: 02/08/2019	Sale Type: REGULAR AUCTION SALE Auction Date: 06/07/2019	Appraisal Number: 19-07-01 Permit Number: Expiration Date: 03/01/2022 Page: 1 of 3
--	---	---

Legal Description

<u>RE Code</u>	<u>Sec.</u>	<u>Twp.</u>	<u>Rge.</u>	<u>City/Twp</u>	<u>Subd</u>
14-119-2301	19	55	22	Goodland	THAT PT OF LOT 2 LYG N & E OF OLD R/W OF
50-013-3000	13	55	23	Unorganized	SW 1/4
50-024-1200	24	55	23	Unorganized	NW NE
50-024-1300	24	55	23	Unorganized	SW NE
50-024-1410	24	55	23	Unorganized	SE NE LESS S 300FT & EXC N 440FT OF E
50-024-2000	24	55	23	Unorganized	NW 1/4
14-119-2200	19	55	22	Goodland	LOT 1
50-024-1100	24	55	23	Unorganized	NE NE

<u>Block 1 Species</u>	<u>Volume</u>	<u>Units</u>	<u>Unit Price</u>	<u>Value</u>	<u>Comments</u>	<u>Bolt %</u>	<u>Bid</u>
Aspen	1,370	Cords	\$26.00	\$35,620.00	3-6 stick, 5-11 Dbh	20	^
Maple	70	Cords	\$9.00	\$630.00	3-6 stick, 8-14 Dbh		#
Basswood	52	Cords	\$9.00	\$468.00	5-7 stick, 11-18 Dbh, 10% saw	20	#
Red Oak	32	Cords	\$15.00	\$480.00	4-7 stick, 16-20 Dbh., 15% saw	15	#
Paper Birch	5	Cords	\$9.00	\$45.00	4-6 stick, 16 Dbh., 25% saw	5	#
				\$37,243.00	Subtotal		
Total Cords =	1,529		Total MBF: 0	\$37,243.00	Total		

Bid Symbols: ^ = Bid Species; # = Non-Bid Species; + = Sold Area Estimate; * = Sold Area Estimate & Non-Bid Species
 All species woodsrun unless listed otherwise.

Species Scaled: Aspen, Basswood , Maple , Paper Birch , Red Oak

Species SAE:

Operability: Summer Dry/Winter Frozen	Soil Type: Itasca-Goodland silt loams
Topography: Level to rolling	Cutting Acres: 59.9

Harvest Specifications

Comments
Harvest type: Clearcut w/reserves & Marked Hardwood Thin

Harvest and Reserves
Reserve all non-hazardous snags. Trees marked with "R" are to be reserved for wildlife. Clearcut w/reserves: Reserve 5-6 individual non-aspen species scattered throughout clearcut area. If non-aspen species do not exist, reserve aspen in order to maintain 5-6 trees per acre. Reserve all non-aspen species within clearcut area. Marked Hardwood Thin: Cut all stems ringed with orange paint. Severe or run over all ironwood regeneration.

Itasca County Timber Appraisal Report

Appraised By: Jesse Lehner Appraisal Date: 02/08/2019	Sale Type: REGULAR AUCTION SALE Auction Date: 06/07/2019	Appraisal Number: 19-07-01 Permit Number: Expiration Date: 03/01/2022 Page: 2 of 3
--	---	---

Access

Gate must be locked at all times, except on days when 3 or more loads are hauled.
 Gates must remain locked during hunting season.

Landings and Access Roads

Location and construction of any new roads/landings must be pre-approved by the sale administrator.
 Trails and landings need to be rehabilitated to a satisfactory condition before performance bond is returned.
 Reserve all non-merchantable timber within 15ft of all roads.
 Berm(s) must be installed after sale is completed.
 Wood cannot be landed under the powerline that runs along permit boundary.

Cutting, Felling, and Skidding

Do not damage reserve trees.
 Do not fell timber into wetlands or across sale boundaries.
 Clearcut w/reserves:
 Processing at the stump not required.
 Marked Hardwood Thin:
 Timber must be processed at the stump. In addition, do not damage unmarked trees, regeneration, or reserve trees within marked hardwood thin.

Site, Soil, and Water Protection

Filter strips require <5% soil disturbance within 50' of all wetlands.
 Roads and skid trails must be stabilized. This may involve installing water bars, strike outs, and/or mulching and seeding.
 Reserve all non-merchantable timber within 15ft of all wetlands.

Slash Disposal

Slash must be evenly distributed throughout permit area.

Special Conditions

Loads with mixed species will be scaled as the highest value species, unless consumer scales species separately using county approved methods.

Regeneration Plan

Natural Regeneration

Itasca County Timber Appraisal Report

Appraised By: Jesse Lehner	Sale Type: REGULAR AUCTION SALE	Appraisal Number: 19-07-01
Appraisal Date: 02/08/2019	Auction Date: 06/07/2019	Permit Number:
		Expiration Date: 03/01/2022
		Page: 3 of 3

Site Map:

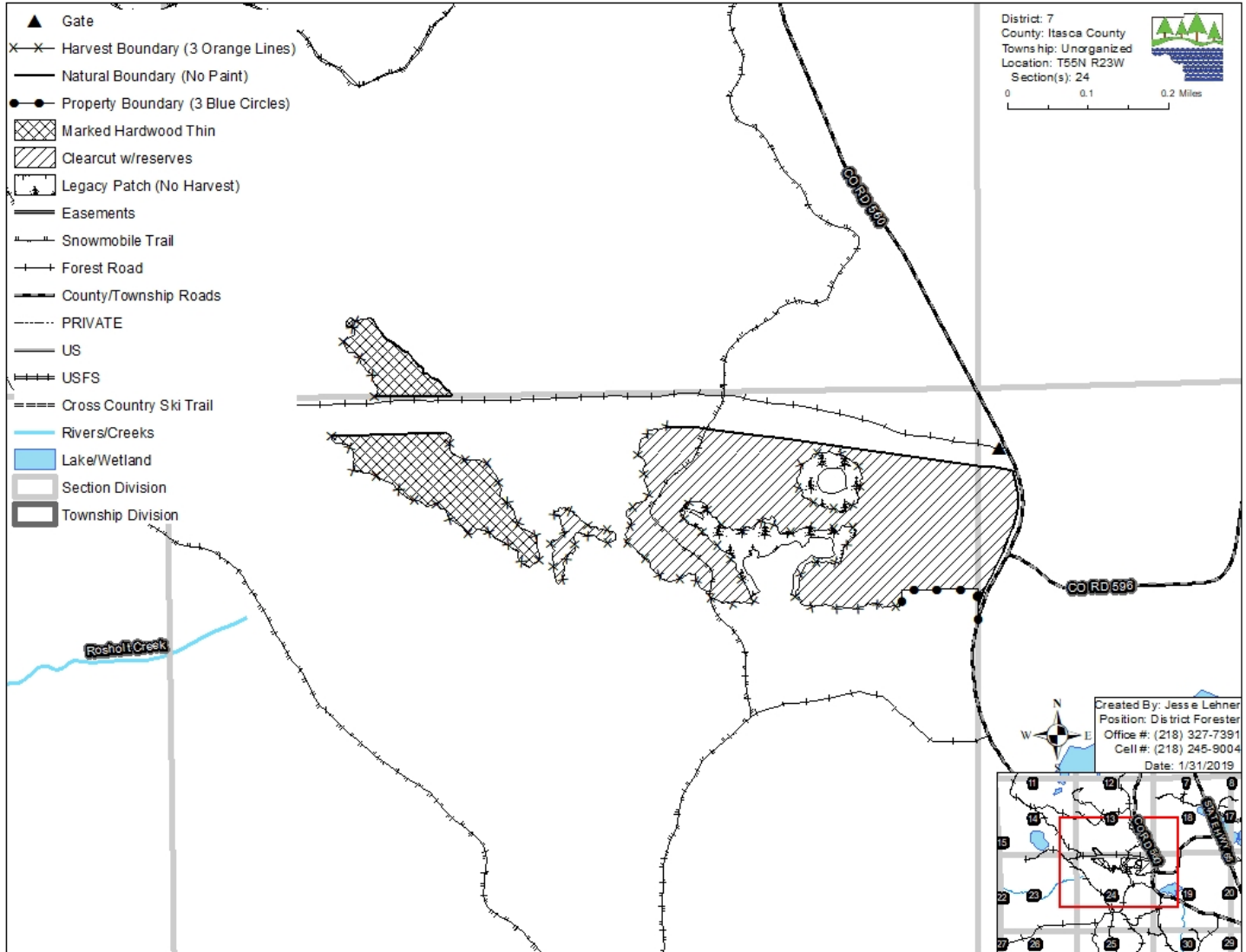

Appraisal examined and approved by _____ Forester _____ Date _____