

Itasca County Timber Appraisal Report

Appraised By: Tony Schram Appraisal Date: 04/04/2019	Sale Type: REGULAR AUCTION SALE Auction Date: 06/07/2019	Appraisal Number: 19-06-09 Permit Number: Expiration Date: 03/01/2022 Page: 1 of 3
---	---	---

Legal Description

<u>RE Code</u>	<u>Sec.</u>	<u>Twp.</u>	<u>Rge.</u>	<u>City/Twp</u>	<u>Subd</u>
07-017-3100	17	61	26	Bigfork	NE SW
07-017-3400	17	61	26	Bigfork	SE SW
07-017-4000	17	61	26	Bigfork	SE 1/4
07-019-1000	19	61	26	Bigfork	NE 1/4
07-017-1300	20	61	26	Bigfork	SW NE
07-017-2000	20	61	26	Bigfork	NW 1/4

<u>Block 1 Species</u>	<u>Volume</u>	<u>Units</u>	<u>Unit Price</u>	<u>Value</u>	<u>Comments</u>	<u>Bolt %</u>	<u>Bid</u>
Aspen	720	Cords	\$22.00	\$15,840.00	4-6 stick 6-10inch	10	^
Ash	325	Cords	\$9.00	\$2,925.00	3-5 stick 8-16inch	25	#
Spruce	300	Cords	\$17.00	\$5,100.00	3-5 stick 6-9 inch 97% Black Spruce	5	^
Balsam Fir	15	Cords	\$13.00	\$195.00			#
Balm	35	Cords	\$16.00	\$560.00			#
Tamarack	40	Cords	\$5.00	\$200.00			#
				\$24,820.00	Subtotal		
Total Cords =	1,435	Total MBF: 0		\$24,820.00	Total		

Bid Symbols: ^ = Bid Species; # = Non-Bid Species; + = Sold Area Estimate; * = Sold Area Estimate & Non-Bid Species
 All species woodsrun unless listed otherwise.

Species Scaled: Ash , Aspen, Balm , Balsam Fir, Spruce , Tamarack

Species SAE:

Operability: Frozen ground only : 12/1 - 3/1	Soil Type: Indus and Brickton, Wildwood Muck, Greenwood
Topography: Level	Cutting Acres: 77.2

Harvest Specifications

<u>Comments</u>
Harvest Type: aspen clearcut, black spruce clearcut and ash thin timber sale
Black Ash Thin: Harvest All aspen, balm, balsam along with white spruce 3 Sticks and larger and ash 8 Inches and larger. Also harvest all ash sizes within 1 tree length distance from any aspen harvested.
Aspen Clearcut: Harvest all aspen, balm, along with spruce and balsam 2 sticks and larger.
Black Spruce Clearcut: Harvest all black spruce and tamarack.

<u>Harvest and Reserves</u>
Trees marked with "R" are to be reserved for wildlife.
Aspen Clearcut: Reserve birch, maple, elm, oak, ash and basswood along with the spruce and balsam 2 sticks and smaller.
Black Spruce Clearcut: Reserve aspen, balsam and birch.
Black Ash Thin: Reserve elm, spruce 2 sticks and smaller along with ash 8 inches and smaller

Itasca County Timber Appraisal Report

Appraised By: Tony Schram Appraisal Date: 04/04/2019	Sale Type: REGULAR AUCTION SALE Auction Date: 06/07/2019	Appraisal Number: 19-06-09 Permit Number: Expiration Date: 03/01/2022 Page: 2 of 3
---	---	---

Access

Access is across Itasca County Tax Forfeit lands & State of MN Lands.
 State or Private land could be crossed to access timber sale depending on the route choosen. Logger must obtain permits/ permission from land owner/ land manager.

Landings and Access Roads

Location and construction of any new roads/landings must be pre-approved by the sale administrator.
 Temporary water/wetland crossing needed on one or more locations. Remove crossing when harvesting activity is completed.

Cutting, Felling, and Skidding

Do not damage reserve trees.
 Do not fell timber into wetlands or across sale boundaries.
 Sale boundaries painted in Orange Circles on the property lines and Orange slashes on the cutting boundary.

Site, Soil, and Water Protection

Can cross intermittent creek / drainage in 1 location. All slash must be pulled from the creek and banks rehabilitated upon sale completion.
 Filter strips require <5% soil disturbance within 50' of all wetlands.
 Reserve all non-merchantable timber within 15ft of all wetlands.
 Restricted cutting is allowed within the RMZ. Refer to sale administrator for specific basal area or species specific requirements.

Slash Disposal

Slash must be evenly distributed throughout permit area.

Special Conditions

All black spruce stems greater than 5ft. must be severed. Mistle Toe prevention

Regeneration Plan

Natural regeneration in all harvested types, suplimental Spruce seed will be used to help regenerate the black spruce stand.

Itasca County Timber Appraisal Report

Appraised By: Tony Schram	Sale Type: REGULAR AUCTION SALE	Appraisal Number: 19-06-09
Appraisal Date: 04/04/2019	Auction Date: 06/07/2019	Permit Number:
		Expiration Date: 03/01/2022
		Page: 3 of 3

Site Map:

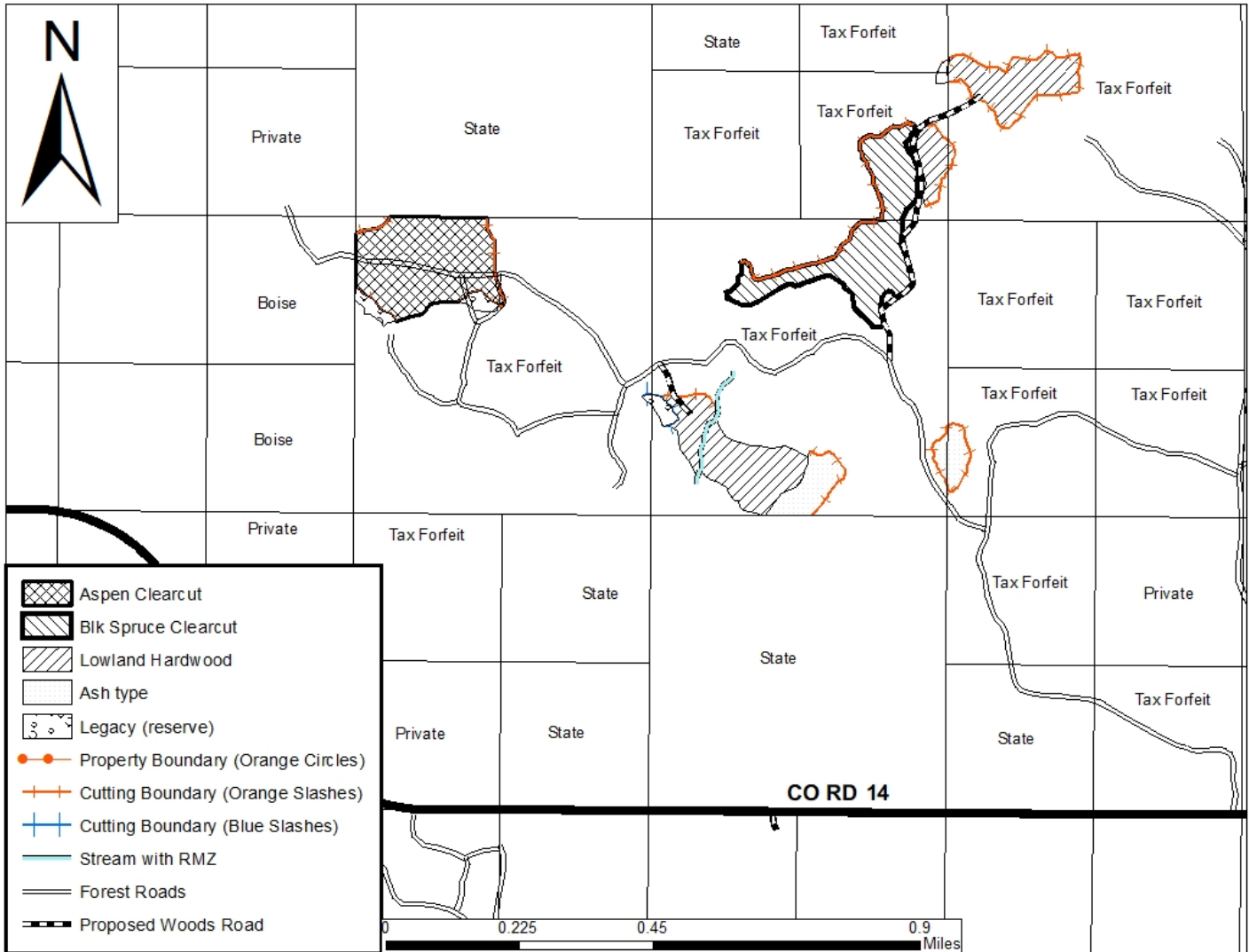

Appraisal examined and approved by _____ Forester _____ Date _____