

## Itasca County Timber Appraisal Report

<b>Appraised By:</b> Tony Schram <b>Appraisal Date:</b> 02/08/2019	<b>Sale Type:</b> REGULAR AUCTION SALE <b>Auction Date:</b> 12/10/2019	<b>Appraisal Number:</b> 19-06-02 <b>Permit Number:</b> <b>Expiration Date:</b> 03/01/2022 <b>Page:</b> 1 of 3
---	---	---

**Legal Description**

<u>RE Code</u>	<u>Sec.</u>	<u>Twp.</u>	<u>Rge.</u>	<u>City/Twp</u>	<u>Subd</u>		
09-026-1200	26	147	25	Bowstring	LOT 2		
09-026-1300	26	147	25	Bowstring	LOT 3		
<u>Block 1 Species</u>	<u>Volume</u>	<u>Units</u>	<u>Unit Price</u>	<u>Value</u>	<u>Comments</u>	<u>Bolt %</u>	<u>Bid</u>
Aspen	976	Cords	\$25.00	\$24,400.00	4-6 stick 8-14inch	15	^
Ash	285	Cords	\$12.00	\$3,420.00	2-5 stick 6-14 inch	20	#
Spruce	88	Cords	\$21.00	\$1,848.00	5-8" 3-5 stick Black Spruce	15	#
Tamarack	31	Cords	\$6.00	\$186.00			#
Balm	58	Cords	\$20.00	\$1,160.00			#
Balsam Fir	60	Cords	\$15.00	\$900.00			#
				\$31,914.00	<b>Subtotal</b>		
<b>Total Cords =</b>	1,498	<b>Total MBF: 0</b>		\$31,914.00	<b>Total</b>		

Bid Symbols: ^ = Bid Species; # = Non-Bid Species; + = Sold Area Estimate; \* = Sold Area Estimate & Non-Bid Species  
 All species woodsrun unless listed otherwise.

**Species Scaled:** Ash , Aspen, Balm , Balsam Fir, Spruce , Tamarack  
**Species SAE:**

**Operability:** Frozen Ground Conditions : 12/1 - 3/1      **Soil Type:** Suomi silt loam  
**Topography:** Level      **Cutting Acres:** 63.0

All permits must follow Itasca County Forest Management Guidelines and Specifications (can be found at <http://www.co.itasca.mn.us/DocumentCenter/View/567/Forest-Management-Guidelines-and-Specifications> ).

**Harvest Specifications**

Comments
Harvest Type: Clearcut w/reserves(37.21 AC), Ash thin(20.09 AC) & Black Spruce Clearcut(5.71 AC)

Harvest and Reserves
Reserve all non-hazardous snags. Trees marked with "R" are to be reserved for wildlife. Aspen Clearcut: Harvest Aspen, Balm, Ash and Balsam Fir >3 Sticks. Reserve Balsam Fir <2 sticks and all Birch, Maple, Elm and Spruce. Harvest all ash within 30 feet of aspen type. Black Spruce Clearcut: Harvest all Black Spruce and Tamarack. Reserve Birch, Elm and Ash. Ash Thin: Cut strips 20 feet wide with 40 feet between the strips.

Access
Possible access is across Blandin land. Another option in an approach of Hwy 6 near the NW portion of the timber sale across Itasca County land. DOT permit may be required to access timber sale off State HWY. Permit Holder needs to secure permission.

## Itasca County Timber Appraisal Report

<b>Appraised By:</b> Tony Schram <b>Appraisal Date:</b> 02/08/2019	<b>Sale Type:</b> REGULAR AUCTION SALE <b>Auction Date:</b> 12/10/2019	<b>Appraisal Number:</b> 19-06-02 <b>Permit Number:</b> <b>Expiration Date:</b> 03/01/2022 <b>Page:</b> 2 of 3
---	---	---

### Landings and Access Roads

Location and construction of any new roads/landings must be pre-approved by the sale administrator.  
 Trails and landings need to be rehabilitated to a satisfactory condition before performance bond is returned.  
 Timber sale administrator shall be notified at least 3 working days prior to completion of hauling and road work. This provides adequate time for permit area inspection and addressing of permit compliance requirements before hauling and road work equipment is removed.

### Cutting, Felling, and Skidding

Do not damage reserve trees.  
 Do not fell timber into wetlands or across sale boundaries.  
 Do not disturb survey markers, including witness trees.  
 Property lines are painted with Orange Circles. Cutting Boundries are either painted with orange slashes or are a natural boundary.

### Site, Soil, and Water Protection

Filter strips require <5% soil disturbance within 50' of all wetlands.

### Slash Disposal

Slash must be evenly distributed throughout permit area.  
 A 10 ft. wide slash free zone must be maintained along roads and trails.

### Special Conditions

All Black Spruce stems greater than 5ft. must be severed. Mistletoe prevention

### Regeneration Plan

Natural Regeneration in aspen and ash types, Black Spruce type will be aerial seeded along with any natural regeneration.

# Itasca County Timber Appraisal Report

<b>Appraised By:</b> Tony Schram	<b>Sale Type:</b> REGULAR AUCTION SALE	<b>Appraisal Number:</b> 19-06-02
<b>Appraisal Date:</b> 02/08/2019	<b>Auction Date:</b> 12/10/2019	<b>Permit Number:</b>
		<b>Expiration Date:</b> 03/01/2022
		<b>Page:</b> 3 of 3

**Site Map:**

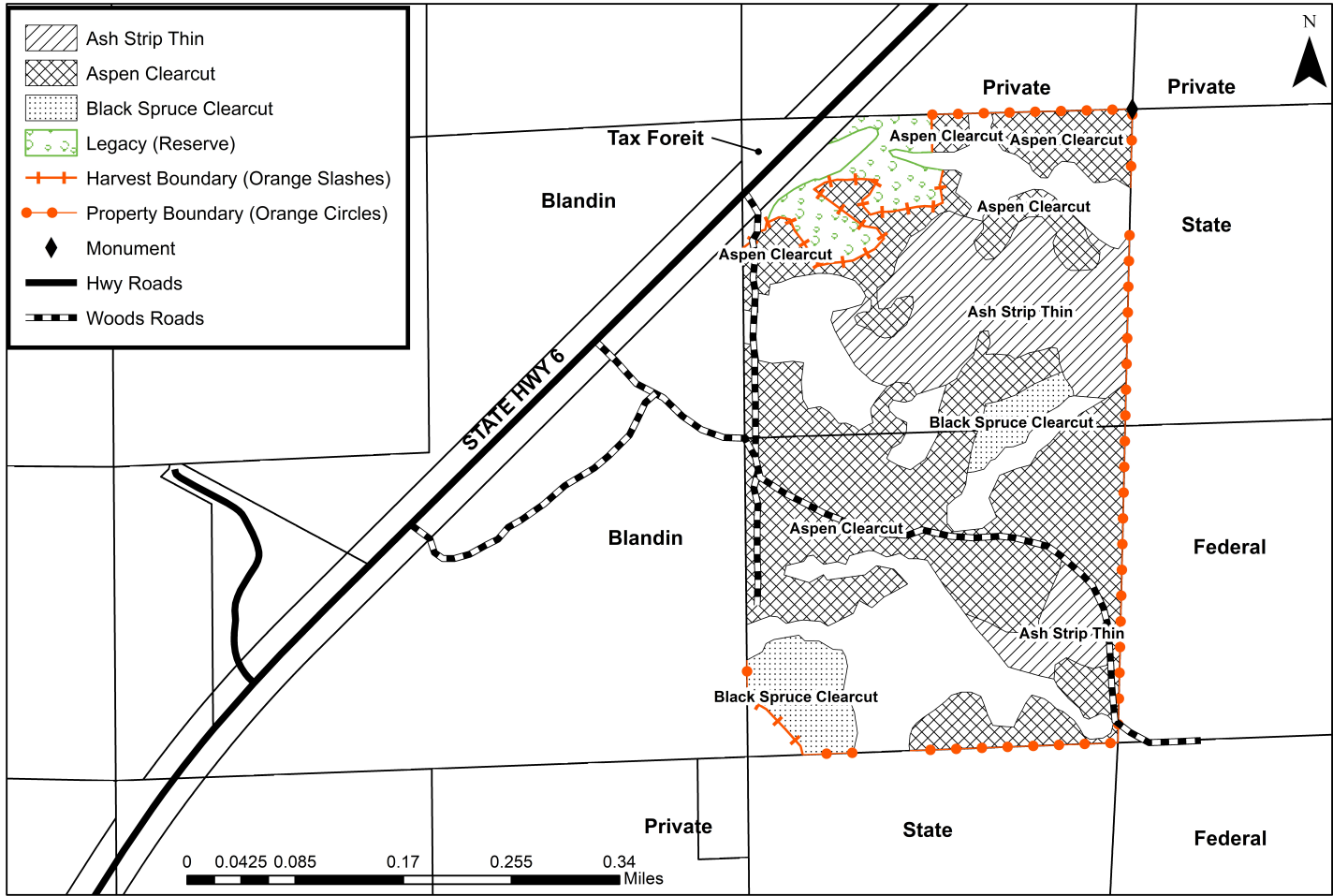

Appraisal examined and approved by \_\_\_\_\_  
Forester Date

Appraisal examined and approved by \_\_\_\_\_  
Land Department Date