

Itasca County Timber Appraisal Report

Appraised By: Loren Eide Appraisal Date: 08/08/2019	Sale Type: INTERMEDIATE AUCTION Auction Date: 12/07/2020	Appraisal Number: 19-05-14 Permit Number: Expiration Date: 03/01/2023 Page: 1 of 2
--	---	---

Legal Description

<u>RE Code</u>	<u>Sec.</u>	<u>Twp.</u>	<u>Rge.</u>	<u>City/Twp</u>	<u>Subd</u>		
06-022-4000	22	61	22	Bearville	SE 1/4		
06-023-3000	23	61	22	Bearville	SW 1/4		
<u>Block 1 Species</u>	<u>Volume</u>	<u>Units</u>	<u>Unit Price</u>	<u>Value</u>	<u>Comments</u>	<u>Bolt %</u>	<u>Bid</u>
Spruce	241	Cords	\$11.00	\$2,651.00	4-5 stick, 6"-10", White Spruce	30	^
Red Pine	129	Cords	\$13.00	\$1,677.00	3-4 stick, 8"-9"	50	^
Balsam Fir	17	Cords	\$5.00	\$85.00	3-6 stick, 6"-10"		#
Aspen	50	Cords	\$16.00	\$800.00	3-5 stick, 6"-10"		^
Jack Pine	32	Cords	\$13.00	\$416.00	2-3 stick, 6"-8"	50	^
				\$5,629.00	Subtotal		
Total Cords =		469	Total MBF: 0		\$5,629.00	Total	

Bid Symbols: ^ = Bid Species; # = Non-Bid Species; + = Sold Area Estimate; * = Sold Area Estimate & Non-Bid Species
 All species woodsrun unless listed otherwise.

Species Scaled: Aspen, Balsam Fir, Jack Pine, Red Pine, Spruce

Species SAE:

Operability: Dry or Frozen ground Conditions: 7/1 - 3/1	Soil Type: Thistledew loamy fine sand, Bearville loamy sand, Taylor and Dalbo silt loams
Topography: Level	Cutting Acres: 38.0

All permits must follow Itasca County Forest Management Guidelines and Specifications (can be found at <http://www.co.itasca.mn.us/DocumentCenter/View/567/Forest-Management-Guidelines-and-Specifications>).

Harvest Specifications

Comments
HARVEST TYPE = First time white spruce/red pine thin; operator select Re-offer

Access
Access from North Snake Trail Forest Road east along Tim Cory Snowmobile Trail approximately 1 mile to permit area. Caution truck hauling signs must be posted along snowmobile trail before any logging activity begins. Landings must be kept back approximately 100' from Tim Cory Snowmobile Trail.

Landings and Access Roads
Location and construction of any new roads/landings must be pre-approved by the sale administrator. Trails and landings need to be rehabilitated to a satisfactory condition before performance bond is returned. Timber sale administrator shall be notified at least 3 working days prior to completion of hauling and road work. This provides adequate time for permit area inspection and addressing of permit compliance requirements before hauling and road work equipment is removed.

Cutting, Felling, and Skidding
Sale boundary painted orange. Cut 12 ft. access strips reserving 40 ft. in between strips for thinning. Thin stand down to an average of 90 basal area. Favor the removal of smaller diameter, poor quality, and damaged trees. Processed at stump required.

Slash Disposal
Slash must be evenly distributed throughout permit area.

Itasca County Timber Appraisal Report

Appraised By: Loren Eide	Sale Type: INTERMEDIATE AUCTION	Appraisal Number: 19-05-14
Appraisal Date: 08/08/2019	Auction Date: 12/07/2020	Permit Number:
		Expiration Date: 03/01/2023
		Page: 2 of 2

Site Map:

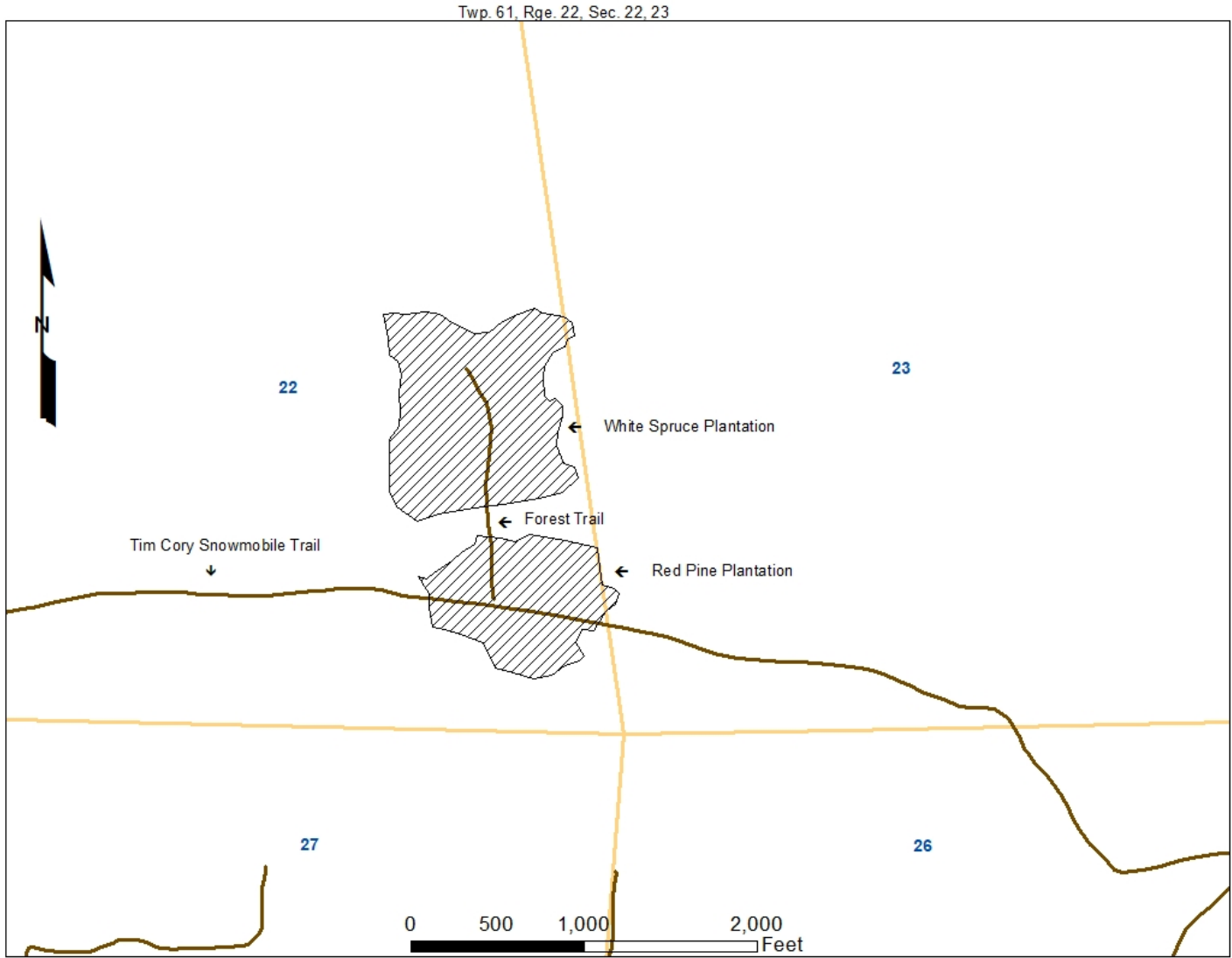

Appraisal examined and approved by _____
Forester Date

Appraisal examined and approved by _____
Land Department Date