

Itasca County Timber Appraisal Report

Appraised By: Blair Carlson Appraisal Date: 07/11/2019	Sale Type: INTERMEDIATE AUCTION Auction Date: 12/10/2019	Appraisal Number: 19-05-12 Permit Number: Expiration Date: 03/01/2022 Page: 1 of 2
---	---	---

Legal Description

RE Code	Sec.	Twp.	Rge.	City/Twp	Subd
06-029-4000	29	61	22	Bearville	SE 1/4 LESS THAT PT SHOWN AS PARCEL 8 ON
06-032-1000	32	61	22	Bearville	NE 1/4
06-032-2100	32	61	22	Bearville	NE NW
06-033-2300	33	61	22	Bearville	SW NW

Block 1 Species	Volume	Units	Unit Price	Value	Comments	Bolt %	Bid
Red Pine	284	Cords	\$15.00	\$4,260.00	3-4 stick,6"-10"	50	^
Jack Pine	26	Cords	\$11.00	\$286.00	2-3 stick, 6"-8"	20	^
Paper Birch	2	Cords	\$8.00	\$16.00			*
				\$4,562.00	Subtotal		
Total Cords =	312	Total MBF: 0		\$4,562.00	Total		

Bid Symbols: ^ = Bid Species; # = Non-Bid Species; + = Sold Area Estimate; * = Sold Area Estimate & Non-Bid Species
 All species woodsrun unless listed otherwise.

Species Scaled: Jack Pine, Red Pine
Species SAE: Paper Birch

Operability: Dry summer harvest the NW and north blocks.: 7/1 - 10/1 **Soil Type:** Menahga-Graycalm
Topography: Level to rolling **Cutting Acres:** 23.0

All permits must follow Itasca County Forest Management Guidelines and Specifications (can be found at <http://www.co.itasca.mn.us/DocumentCenter/View/567/Forest-Management-Guidelines-and-Specifications>).

Harvest Specifications

Comments
First time red pine thin, process at the stump only. Dry summer harvest the NW and north block. The two south blocks may require winter harvest due to wetter sites.

Access
Access from Hwy. 65 east along Snake Trail for approximately 1 mile. Landings must be approved by sale administrator and logging equipment must not block road. Caution signs must be posted before any logging activity begins.

Landings and Access Roads
Trails and landings need to be rehabilitated to a satisfactory condition before performance bond is returned. Timber sale administrator shall be notified at least 3 working days prior to completion of hauling and road work. This provides adequate time for permit area inspection and addressing of permit compliance requirements before hauling and road work equipment is removed.

Cutting, Felling, and Skidding
Sale boundaries painted orange except for the east side of the north east cutting block is blue. Cut 12 ft. access strips reserving 40 ft. in between strips for thinning. Thin stand down to an average of 90 basal area, do not damage reserve trees. Favor the removal of smaller diameter, poor quality, and damaged trees. All slash must remain scattered across permit area.

Special Conditions
Logging season may be restricted from August through February during high bark beetle risk. All cut pine must be hauled within 3 weeks during June through August.

Itasca County Timber Appraisal Report

Appraised By: Blair Carlson	Sale Type: INTERMEDIATE AUCTION	Appraisal Number: 19-05-12
Appraisal Date: 07/11/2019	Auction Date: 12/10/2019	Permit Number:
		Expiration Date: 03/01/2022
		Page: 2 of 2

Site Map:

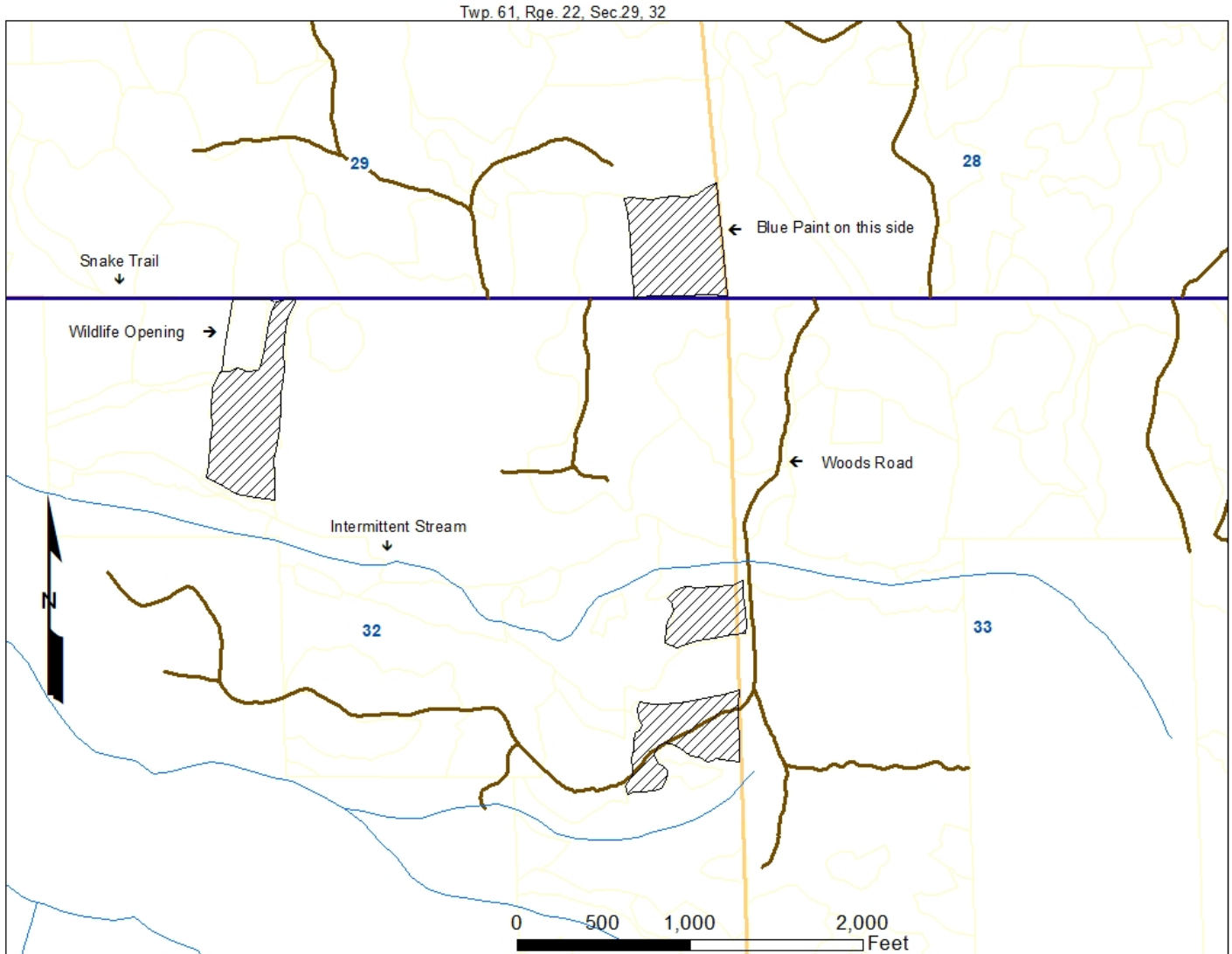

Appraisal examined and approved by _____
Forester Date

Appraisal examined and approved by _____
Land Department Date