

Itasca County Timber Appraisal Report

Appraised By:

Blair Carlson

Appraisal Date:

02/26/2019

Sale Type:

REGULAR AUCTION SALE

Auction Date:

06/07/2019

Appraisal Number: 19-05-05**Permit Number:****Expiration Date:** 03/01/2022**Page:** 1 of 3**Legal Description**

RE Code	Sec.	Twp.	Rge.	City/Twp	Subd			
54-001-4200	1	61	23	Unorganized	NW SE			
54-001-4300	1	61	23	Unorganized	SW SE			
Block 1 Species	Volume	Units	Unit Price	Value	Comments	Bolt %	Bid	
Red Pine	211	Cords	\$40.00	\$8,440.00	6-8-stick, 10"-25", 60% Saw	25	^	
Jack Pine	162	Cords	\$23.00	\$3,726.00	6-7-stick,8"-14"	50	^	
Paper Birch	539	Cords	\$10.00	\$5,390.00	5-7-stick,6"-14"	20	^	
Aspen	253	Cords	\$26.00	\$6,578.00	5-7-STICK,6"-12"		^	
Maple	70	Cords	\$9.00	\$630.00	3-5-STICK,6"-8"		#	
Balsam Fir	22	Cords	\$13.00	\$286.00	3-6-STICK,6"-10"		#	
Spruce	9	Cords	\$24.00	\$216.00	White Spruce, 7-9-STICK,10"-16"	80	#	
				\$25,266.00	Subtotal			
Total Cords =	1,266		Total MBF: 0	\$25,266.00	Total			

Bid Symbols: ^ = Bid Species; # = Non-Bid Species; + = Sold Area Estimate; * = Sold Area Estimate & Non-Bid Species
All species woodrun unless listed otherwise.

Species Scaled: Aspen, Balsam Fir, Jack Pine, Maple, Paper Birch, Red Pine, Spruce

Species SAE:

Operability: Dry summer/fall harvest only.: 6/1/2019 - 10/1/2021
Soil Type: Loamy sand

Topography: Rolling to steep
Cutting Acres: 44.0

Harvest Specifications

Comments
Clearcut Harvest, except for reserves, (white pine, large snags, oak and cedar).

Access
State land must be crossed to access timber sale. Logger must obtain permits/ permission from land manager. ATV trail regulations in Itasca County Forest Management Guideline & Specifications apply. Approximately 1/2 mile to county road 551.

Landings and Access Roads
Trails and landings need to be rehabilitated to a satisfactory condition before performance bond is returned. this may involve installing water bars, strike outs and/or mulching and seeding. Location and construction of any new roads/landings must be pre-approved by the sale administrator.

Cutting, Felling, and Skidding
There are steep slopes on this permit, which may require hand felling. Do not disturb survey markers, including witness trees. Sale boundaries painted orange.

Slash Disposal
Slash must be evenly distributed throughout permit area.

Itasca County Timber Appraisal Report

Appraised By: Blair Carlson	Sale Type: REGULAR AUCTION SALE	Appraisal Number: 19-05-05
Appraisal Date: 02/26/2019	Auction Date: 06/07/2019	Permit Number:
		Expiration Date: 03/01/2022
		Page: 2 of 3

Regeneration Plan

Allow the aspen area to regenerate back to aspen and plant the birch/jack pine area to either red or jack pine.

Itasca County Timber Appraisal Report

Appraised By: Blair Carlson	Sale Type: REGULAR AUCTION SALE	Appraisal Number: 19-05-05
Appraisal Date: 02/26/2019	Auction Date: 06/07/2019	Permit Number:
		Expiration Date: 03/01/2022
		Page: 3 of 3

Site Map:

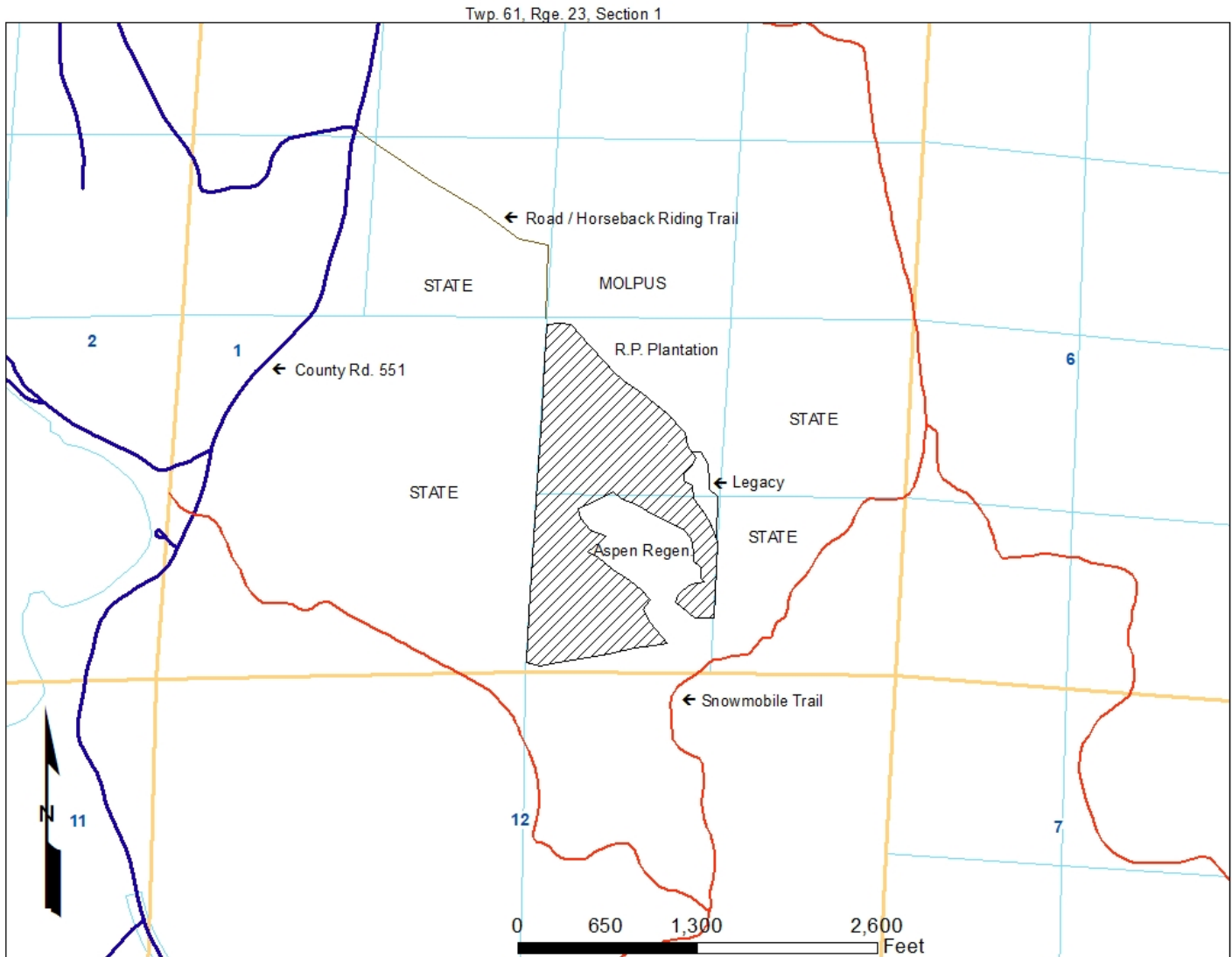

Appraisal examined and approved by _____ Forester _____ Date _____