

Itasca County Timber Appraisal Report

Appraised By: Blair Carlson Appraisal Date: 01/25/2019	Sale Type: REGULAR AUCTION SALE Auction Date: 06/07/2019	Appraisal Number: 19-05-04 Permit Number: Expiration Date: 03/01/2022 Page: 1 of 3
---	---	---

Legal Description

<u>RE Code</u>	<u>Sec.</u>	<u>Twp.</u>	<u>Rge.</u>	<u>City/Twp</u>	<u>Subd</u>		
54-012-1000	12	61	23	Unorganized	NE 1/4		
54-012-2000	12	61	23	Unorganized	NW 1/4		
<u>Block 1 Species</u>	<u>Volume</u>	<u>Units</u>	<u>Unit Price</u>	<u>Value</u>	<u>Comments</u>	<u>Bolt %</u>	<u>Bid</u>
Red Pine	934	Cords	\$40.00	\$37,360.00	6-8-stick, 14"-18", 60% Saw	20	^
Jack Pine	381	Cords	\$23.00	\$8,763.00	6-8-stick, 8"-14"	50	^
Balsam Fir	182	Cords	\$13.00	\$2,366.00	3-6-stick, 6"-12"		^
Spruce	112	Cords	\$25.00	\$2,800.00	6-8-stick, 12"-20"	70	^
White Pine	170	Cords	\$27.00	\$4,590.00	6-8-stick, 14"-20", 60% Saw	10	^
Aspen	113	Cords	\$26.00	\$2,938.00	6-7-stick, 10"-16"		^
Paper Birch	227	Cords	\$7.00	\$1,589.00	4-6-stick,6"-12"		^
Maple	5	Cords	\$9.00	\$45.00	3-4-stick,6"-8"		#
				\$60,451.00	Subtotal		
Total Cords =	2,124			Total MBF: 0	Total		

Bid Symbols: ^ = Bid Species; # = Non-Bid Species; + = Sold Area Estimate; * = Sold Area Estimate & Non-Bid Species
 All species woodsrun unless listed otherwise.

Species Scaled: Aspen, Balsam Fir, Jack Pine, Maple , Paper Birch , Red Pine, Spruce , White Pine
Species SAE:

Operability: Summer harvest only: 6-1-2019 - 10-1-1-2019 **Soil Type:** Menahga Loamy sand
Topography: Rolling to steep **Cutting Acres:** 53.0

Harvest Specifications

Comments
Clearcut Harvest

Access
It is the permit holder's responsibility to obtain approval from all affected landowners and/or management agencies before gaining access to the permit area. ATV trail regulations in Itasca County Forest Management Guideline & Specifications apply. DNR trails must be contacted before any logging activities begin and signs posted regarding logging operations at all trail heads.

Landings and Access Roads
Location and construction of any new roads/landings must be pre-approved by the sale administrator. Roads, trails and landings need to be rehabilitated to a satisfactory condition before performance bond is returned. This may involved installing water bars, strike outs, and/or mulching and seeding.

Cutting, Felling, and Skidding
Clearcut, Do not damage reserve trees, (large snags and all white pine marked with a orange painted S). Some steep slopes occur on this permit, which may require hand felling. Sale boundaries painted orange. Cutting will only be allowed during dry summer and fall periods, no winter harvesting will be allowed in this high use snowmobile area.

Itasca County Timber Appraisal Report

Appraised By: Blair Carlson Appraisal Date: 01/25/2019	Sale Type: REGULAR AUCTION SALE Auction Date: 06/07/2019	Appraisal Number: 19-05-04 Permit Number: Expiration Date: 03/01/2022 Page: 2 of 3
---	---	---

Slash Disposal

Slash must be evenly distributed throughout permit area.

Regeneration Plan

This area will be mechanically site prepped and replanted back to jack pine or red pine. The white pine reserve trees should be maintained as a component throughout all future forest management work done within this high recreational area.

Itasca County Timber Appraisal Report

Appraised By: Blair Carlson	Sale Type: REGULAR AUCTION SALE	Appraisal Number: 19-05-04
Appraisal Date: 01/25/2019	Auction Date: 06/07/2019	Permit Number:
		Expiration Date: 03/01/2022
		Page: 3 of 3

Site Map:

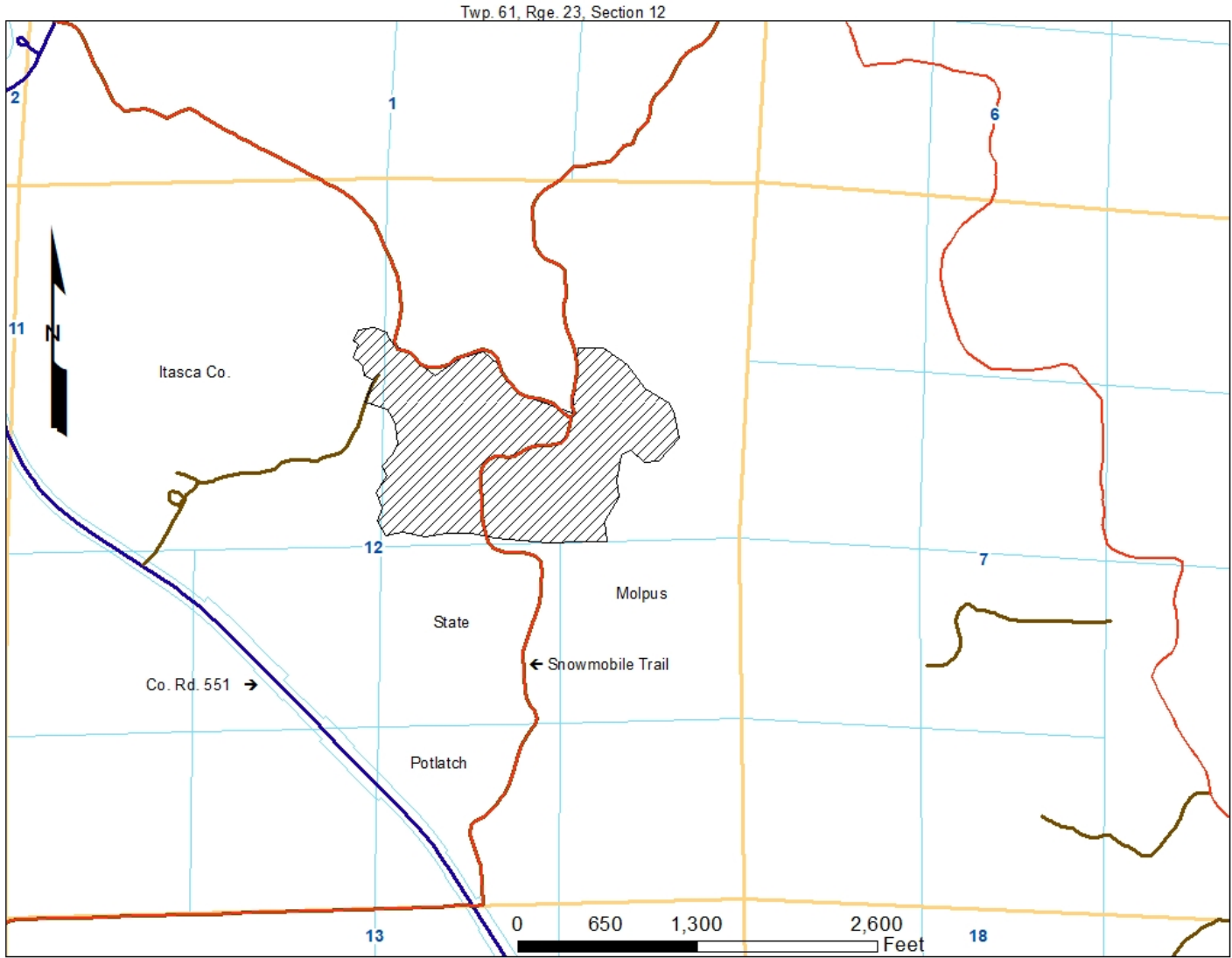

Appraisal examined and approved by _____ Forester _____ Date _____