

## Itasca County Timber Appraisal Report

<b>Appraised By:</b> Loren Eide  <b>Appraisal Date:</b> 04/22/2019	<b>Sale Type:</b> INTERMEDIATE AUCTION  <b>Auction Date:</b> 06/07/2019	<b>Appraisal Number:</b> 19-04-04 <b>Permit Number:</b> <b>Expiration Date:</b> 03/01/2022 <b>Page:</b> 1 of 3
--	---	---

**Legal Description**

RE Code	Sec.	Twp.	Rge.	City/Twp	Subd
49-021-1000	21	59	22	Unorganized	NE 1/4
49-021-2100	21	59	22	Unorganized	NE NW
49-021-2200	21	59	22	Unorganized	NW NW
49-021-2400	21	59	22	Unorganized	SE NW

Block 1 Species	Volume	Units	Unit Price	Value	Comments	Bolt %	Bid
Aspen	480	Cords	\$23.00	\$11,040.00		25	^
Spruce	135	Cords	\$18.00	\$2,430.00	mostly black spruce	5	^
Balsam Fir	95	Cords	\$13.00	\$1,235.00		10	^
Jack Pine	15	Cords	\$25.00	\$375.00		60	#
Tamarack	25	Cords	\$6.00	\$150.00			#
Maple	15	Cords	\$9.00	\$135.00			#
Paper Birch	10	Cords	\$9.00	\$90.00			#
Ash	10	Cords	\$9.00	\$90.00		25	#

\$15,545.00    **Subtotal**

**Total Cords =**    785                                    **Total MBF: 0**    \$15,545.00    **Total**

Bid Symbols: ^ = Bid Species; # = Non-Bid Species; + = Sold Area Estimate; \* = Sold Area Estimate & Non-Bid Species  
 All species woodsrun unless listed otherwise.

**Species Scaled:**    Ash , Aspen, Balsam Fir, Jack Pine, Maple , Paper Birch , Spruce , Tamarack

**Species SAE:**

<b>Operability:</b> Winter frozen ground: 12/15 - 3/1	<b>Soil Type:</b> Nashwauk fine sandy loam,Keewatin silt loam,Greenwood Peat
<b>Topography:</b> Level to rolling	<b>Cutting Acres:</b> 32.1

**Harvest Specifications**

Comments
Harvest Type: Aspen and Black Spruce clearcuts.

Harvest and Reserves
Reserve all non-hazardous snag and cavity trees, cedar, small balsam and advanced regeneration pockets. Reserve any unmerchantable trees within 30' of Bower Lake Forest Road right of way.

Access
2 miles to maintained public road (#583) to west.

Landings and Access Roads
Landings must be kept back at least 100' from the Bower Lk Forest Road and must be pre- approved by sale administrator. Berm(s) must be installed after sale is completed.

Cutting, Felling, and Skidding
Do not disturb survey markers, including witness trees. Majority of cutting boundaries painted orange. The north 1/2 of line on the west side of the black spruce type has natural cutting boundaries.

## Itasca County Timber Appraisal Report

<b>Appraised By:</b> Loren Eide <b>Appraisal Date:</b> 04/22/2019	<b>Sale Type:</b> INTERMEDIATE AUCTION <b>Auction Date:</b> 06/07/2019	<b>Appraisal Number:</b> 19-04-04 <b>Permit Number:</b> <b>Expiration Date:</b> 03/01/2022 <b>Page:</b> 2 of 3
--	---	---

### Slash Disposal

Slash must be evenly distributed throughout permit area. No upland slash to remain in black spruce or lowland areas.  
Slash height must not exceed 3 ft. within view of road and 20' slash free zone to be left along the road right of way.

### Special Conditions

All Black Spruce stems greater than 5ft. must be severed to aid in Dwarf Mistletoe prevention.

### Regeneration Plan

Natural Regeneration of aspen and black spruce. Aerial seeding of the black spruce area will also be recommended to aid in regeneration.

# Itasca County Timber Appraisal Report

<b>Appraised By:</b> Loren Eide	<b>Sale Type:</b> INTERMEDIATE AUCTION	<b>Appraisal Number:</b> 19-04-04
<b>Appraisal Date:</b> 04/22/2019	<b>Auction Date:</b> 06/07/2019	<b>Permit Number:</b>
		<b>Expiration Date:</b> 03/01/2022
		<b>Page:</b> 3 of 3

**Site Map:**

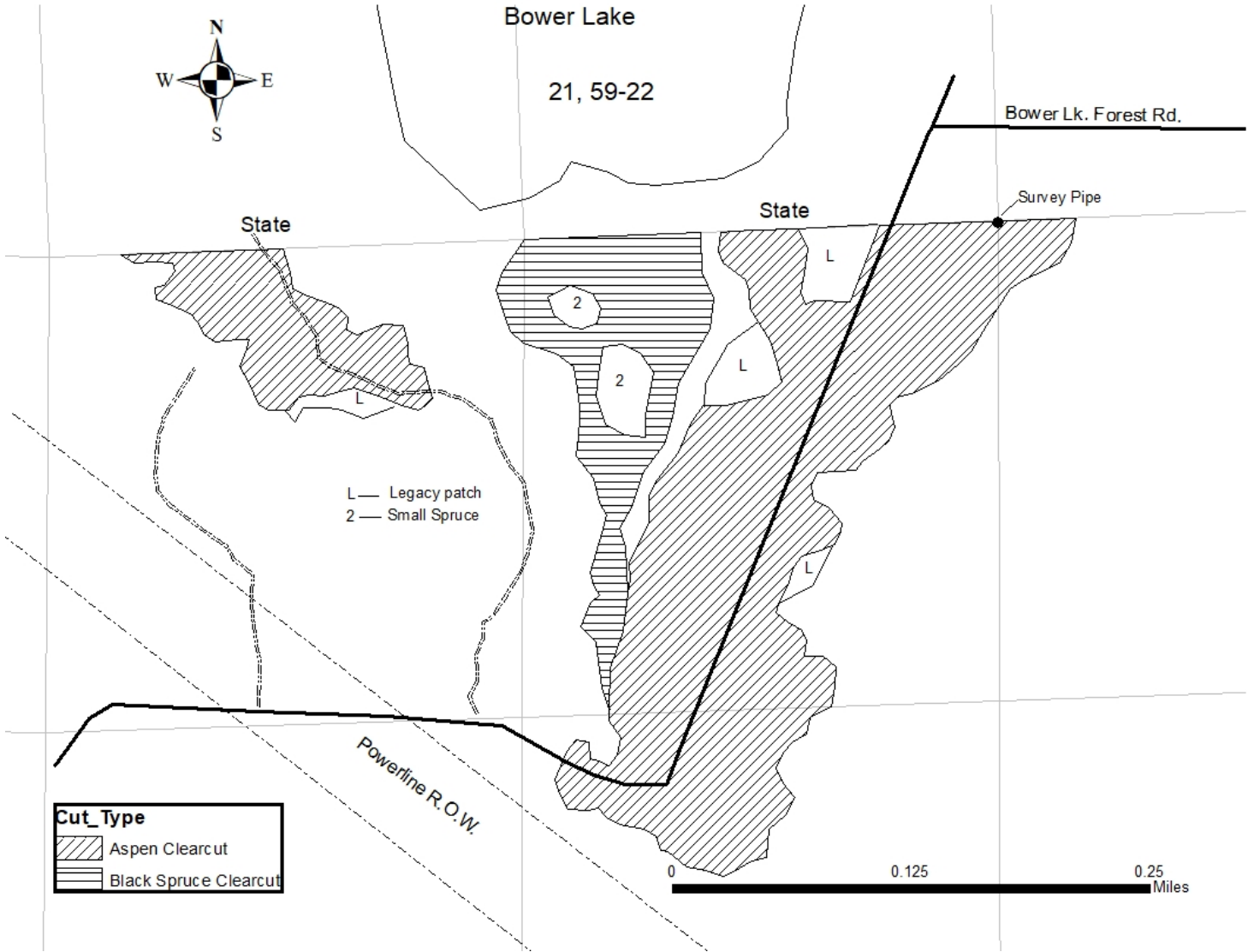

Appraisal examined and approved by \_\_\_\_\_ Forester \_\_\_\_\_ Date \_\_\_\_\_