

Itasca County Timber Appraisal Report

Appraised By: Loren Eide Appraisal Date: 04/17/2019	Sale Type: INTERMEDIATE AUCTION Auction Date: 06/07/2019	Appraisal Number: 19-04-03 Permit Number: Expiration Date: 03/01/2022 Page: 1 of 2
--	---	---

Legal Description

<u>RE Code</u>	<u>Sec.</u>	<u>Twp.</u>	<u>Rge.</u>	<u>City/Twp</u>	<u>Subd</u>
49-030-1000	30	59	22	Unorganized	NE 1/4
49-032-3400	32	59	22	Unorganized	SE SW

<u>Block 1 Species</u>	<u>Volume</u>	<u>Units</u>	<u>Unit Price</u>	<u>Value</u>	<u>Comments</u>	<u>Bolt %</u>	<u>Bid</u>
Red Pine	280	Cords	\$22.00	\$6,160.00		65	^
Aspen	10	Cords	\$17.00	\$170.00			#

	\$6,330.00	Subtotal
Total Cords = 290	Total MBF: 0	Total \$6,330.00

Bid Symbols: ^ = Bid Species; # = Non-Bid Species; + = Sold Area Estimate; * = Sold Area Estimate & Non-Bid Species
 All species woodsrun unless listed otherwise.

Species Scaled: Aspen, Red Pine

Species SAE:

Operability: Summer chance: 7/1 - 10/1, winter chance: 12/1 - 3/1	Soil Type: Nashwauk fine sandy loam
Topography: Level to rolling	Cutting Acres: 17.3

Harvest Specifications

Comments
Harvest type: Second time red pine thins (operator select). Sale involves 2 stands that are located 3 miles apart.

Access
landowner has given permission to cross their property (w/270' of lot 5, of sec. 19, 59-22) for access to the north stand of the sale using the existing trail (used on previos thinning) as long as it remains in as good or better condition as found. Public access for part of sale south in section 32.

Landings and Access Roads
Private access on north part of sale has room to pile some 100' close to county rd. Trucks will need to back in from county rd. to load.

Cutting, Felling, and Skidding
Timber must be processed at the stump. Use existing clearcut strips and thin pine from below to 90BA. Operator select Sale boundaries include natural cutting boundaries and some painted property lines.

Slash Disposal
Slash must be evenly distributed throughout permit area.

Special Conditions
Logging season may be restricted to September through February during high bark beetle risk. All cut pine must be hauled within 3 weeks during June through August.

Itasca County Timber Appraisal Report

Appraised By: Loren Eide	Sale Type: INTERMEDIATE AUCTION	Appraisal Number: 19-04-03
Appraisal Date: 04/17/2019	Auction Date: 06/07/2019	Permit Number:
		Expiration Date: 03/01/2022
		Page: 2 of 2

Site Map:

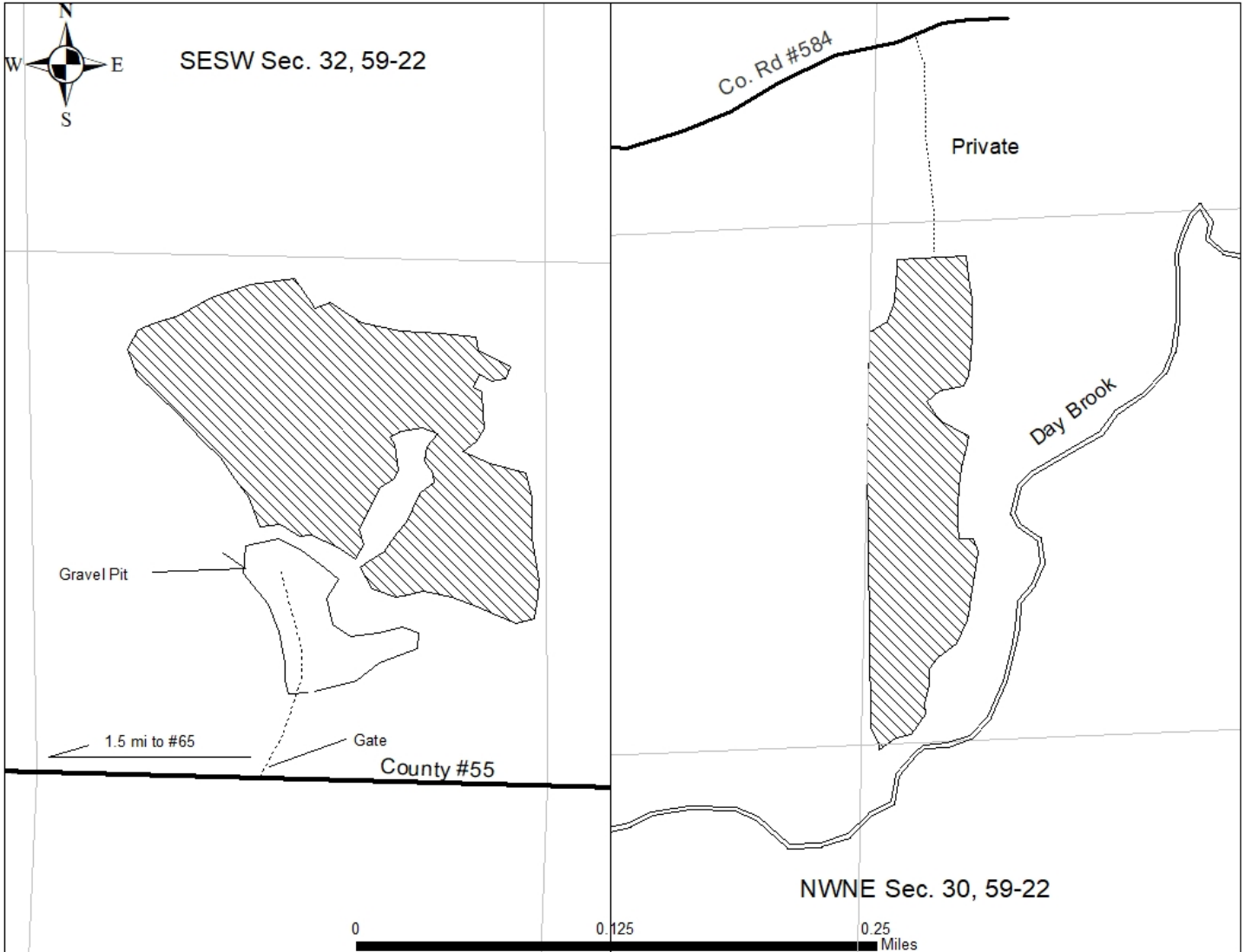

Appraisal examined and approved by _____ Forester _____ Date _____