

Itasca County Timber Appraisal Report

Appraised By: Loren Eide Appraisal Date: 04/18/2019	Sale Type: REGULAR AUCTION SALE Auction Date: 06/07/2019	Appraisal Number: 19-04-02 Permit Number: Expiration Date: 03/01/2022 Page: 1 of 3
--	---	---

Legal Description

<u>RE Code</u>	<u>Sec.</u>	<u>Twp.</u>	<u>Rge.</u>	<u>City/Twp</u>	<u>Subd</u>
06-127-2000	27	60	22	Bearville	NW 1/4
06-128-1400	28	60	22	Bearville	SE NE
06-128-2000	28	60	22	Bearville	NW 1/4
06-128-3200	28	60	22	Bearville	NW SW
06-128-4100	28	60	22	Bearville	NE SE
06-129-1000	29	60	22	Bearville	NE 1/4
06-129-4100	29	60	22	Bearville	NE SE
06-131-4200	31	60	22	Bearville	NW SE

<u>Block 1 Species</u>	<u>Volume</u>	<u>Units</u>	<u>Unit Price</u>	<u>Value</u>	<u>Comments</u>	<u>Bolt %</u>	<u>Bid</u>
Aspen	1,570	Cords	\$22.00	\$34,540.00		20	^
Balsam Fir	20	Cords	\$13.00	\$260.00			#
Ash	13	Cords	\$8.00	\$104.00			*
Paper Birch	11	Cords	\$8.00	\$88.00			*
Maple	10	Cords	\$8.00	\$80.00			*

\$35,072.00 **Subtotal**

Total Cords = 1,624 **Total MBF: 0** \$35,072.00 **Total**

Bid Symbols: ^ = Bid Species; # = Non-Bid Species; + = Sold Area Estimate; * = Sold Area Estimate & Non-Bid Species
 All species woodsrun unless listed otherwise.

Species Scaled: Aspen, Balsam Fir
Species SAE: Ash , Maple , Paper Birch

Operability: Winter frozen ground: 12/15 - 3/1 **Soil Type:** Nashwauk fine sandy loam. Some rocks.
Topography: Level to rolling **Cutting Acres:** 55.9

Harvest Specifications

Comments
Harvest Type: Aspen clearcuts

Access
4.7mi on Sherry Lk. trail to maintained public road (#65). Taconite snowmobile trail crosses access trail .5 mi east of #65. No snow berms to be left at trail crossing when access is plowed opened.

Landings and Access Roads
Little new road development will be required (besides opening the rd. system in the winter), since harvest areas are mostly on or close to existing roads. Location and construction of any new roads/landings must be pre-approved by the sale administrator. Access road needs to remain frozen for all sale activities or will likely require rehabilitation to a satisfactory condition before performance bond is returned.

Cutting, Felling, and Skidding
Do not damage regeneration outside of harvest area. Reserve all non-hazardous snag and cavity trees, pine, cedar and small balsam. Majority of harvest area has natural cutting boundaries. There are some orange painted line segments and reserve areas.

Itasca County Timber Appraisal Report

Appraised By: Loren Eide	Sale Type: REGULAR AUCTION SALE	Appraisal Number: 19-04-02
Appraisal Date: 04/18/2019	Auction Date: 06/07/2019	Permit Number:
		Expiration Date: 03/01/2022
		Page: 2 of 3

Slash Disposal

Slash must be evenly distributed throughout permit area.

A 10 ft. wide slash free zone must be maintained along roads and trails.

Regeneration Plan

Natural Regeneration of aspen is anticipated.

Itasca County Timber Appraisal Report

Appraised By: Loren Eide	Sale Type: REGULAR AUCTION SALE	Appraisal Number: 19-04-02
Appraisal Date: 04/18/2019	Auction Date: 06/07/2019	Permit Number:
		Expiration Date: 03/01/2022
		Page: 3 of 3

Site Map:

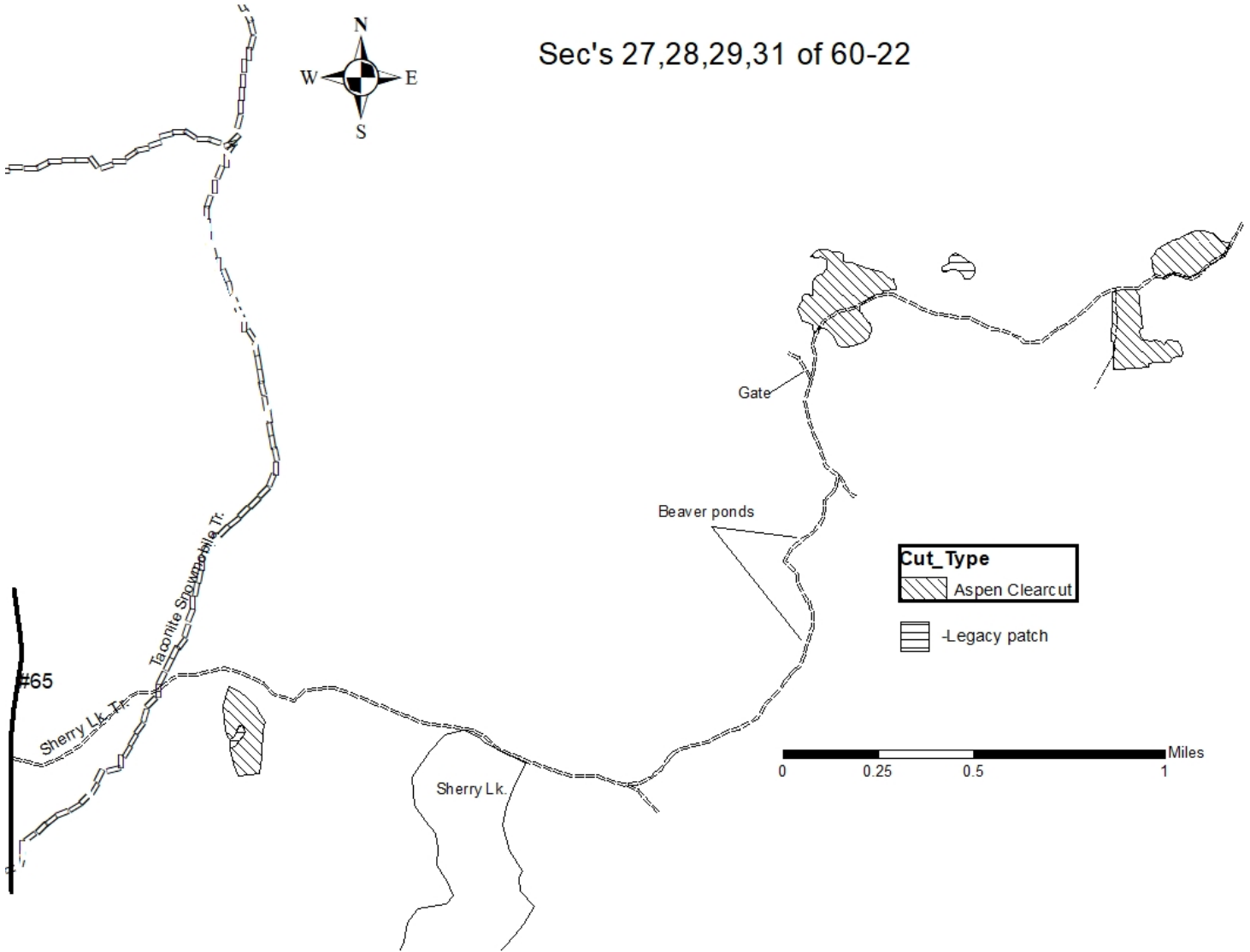

Appraisal examined and approved by _____ Forester _____ Date _____