

Itasca County Timber Appraisal Report

<b>Appraised By:</b> Loren Eide	<b>Sale Type:</b> REGULAR AUCTION SALE	<b>Appraisal Number:</b> 19-04-01
<b>Appraisal Date:</b> 04/08/2019	<b>Auction Date:</b> 06/07/2019	<b>Permit Number:</b>
		<b>Expiration Date:</b> 03/01/2022
		<b>Page:</b> 1 of 3

Legal Description

<u>RE Code</u>	<u>Sec.</u>	<u>Twp.</u>	<u>Rge.</u>	<u>City/Twp</u>	<u>Subd</u>			
49-002-3000	2	59	22	Unorganized	SW 1/4			
49-003-1300	3	59	22	Unorganized	SW NE			
49-003-1400	3	59	22	Unorganized	SE NE			
49-003-2400	3	59	22	Unorganized	SE NW			
49-003-3000	3	59	22	Unorganized	SW 1/4			
49-003-4100	3	59	22	Unorganized	NE SE			

<u>Block 1 Species</u>	<u>Volume</u>	<u>Units</u>	<u>Unit Price</u>	<u>Value</u>	<u>Comments</u>	<u>Bolt %</u>	<u>Bid</u>
Aspen	850	Cords	\$21.00	\$17,850.00		30	^
Jack Pine	160	Cords	\$14.00	\$2,240.00		25	^
Red Pine	20	Cords	\$14.00	\$280.00	10% saw	50	^
Spruce	190	Cords	\$15.00	\$2,850.00	black spruce		^
Balsam Fir	110	Cords	\$14.00	\$1,540.00			#
Paper Birch	95	Cords	\$8.00	\$760.00			#
Maple	40	Cords	\$8.00	\$320.00			#
Tamarack	20	Cords	\$5.00	\$100.00			*
Ash	5	Cords	\$8.00	\$40.00			*

\$25,980.00 Subtotal

Total Cords = 1,490 Total MBF: 0 \$25,980.00 Total

Bid Symbols: ^ = Bid Species; # = Non-Bid Species; + = Sold Area Estimate; \* = Sold Area Estimate & Non-Bid Species  
All species woodsrun unless listed otherwise.

Species Scaled: Aspen, Balsam Fir, Jack Pine, Maple , Paper Birch , Red Pine, Spruce

Species SAE: Ash , Tamarack

Operability: winter sale: 12/15 - 3/1 Soil Type: Menage-Graycalm-Nashwauk Complex

Topography: Level to rolling Cutting Acres: 58.1

Harvest Specifications

<u>Comments</u>
Harvest Type: Aspen, Birch, Black spruce and jack Pine clearcuts

<u>Harvest and Reserves</u>
Reserve all non-hazardous snags, cedar, white pine and small balsam fir.

<u>Access</u>
State land must be crossed to access timber sale (if accessed from east). Logger must obtain permits/ permission from land owner/ land manager.

<u>Cutting, Felling, and Skidding</u>
Do not damage reserve trees.
Do not disturb survey markers, including witness trees.
Sale boundaries have both painted orange and natural cutting boundaries.

## Itasca County Timber Appraisal Report

<b>Appraised By:</b> Loren Eide <b>Appraisal Date:</b> 04/08/2019	<b>Sale Type:</b> REGULAR AUCTION SALE <b>Auction Date:</b> 06/07/2019	<b>Appraisal Number:</b> 19-04-01 <b>Permit Number:</b> <b>Expiration Date:</b> 03/01/2022 <b>Page:</b> 2 of 3
--	---	---

### Slash Disposal

Slash must be evenly distributed throughout permit area.

A 10 ft. wide slash free zone must be maintained along roads and trails.

### Special Conditions

All Black Spruce stems greater than 5ft. must be severed to aid in Dwarf Mistletoe prevention.

### Regeneration Plan

Natural Regeneration of aspen, spruce, jack pine. Aerial seed black spruce

# Itasca County Timber Appraisal Report

<b>Appraised By:</b> Loren Eide	<b>Sale Type:</b> REGULAR AUCTION SALE	<b>Appraisal Number:</b> 19-04-01
<b>Appraisal Date:</b> 04/08/2019	<b>Auction Date:</b> 06/07/2019	<b>Permit Number:</b>
		<b>Expiration Date:</b> 03/01/2022
		<b>Page:</b> 3 of 3

**Site Map:**

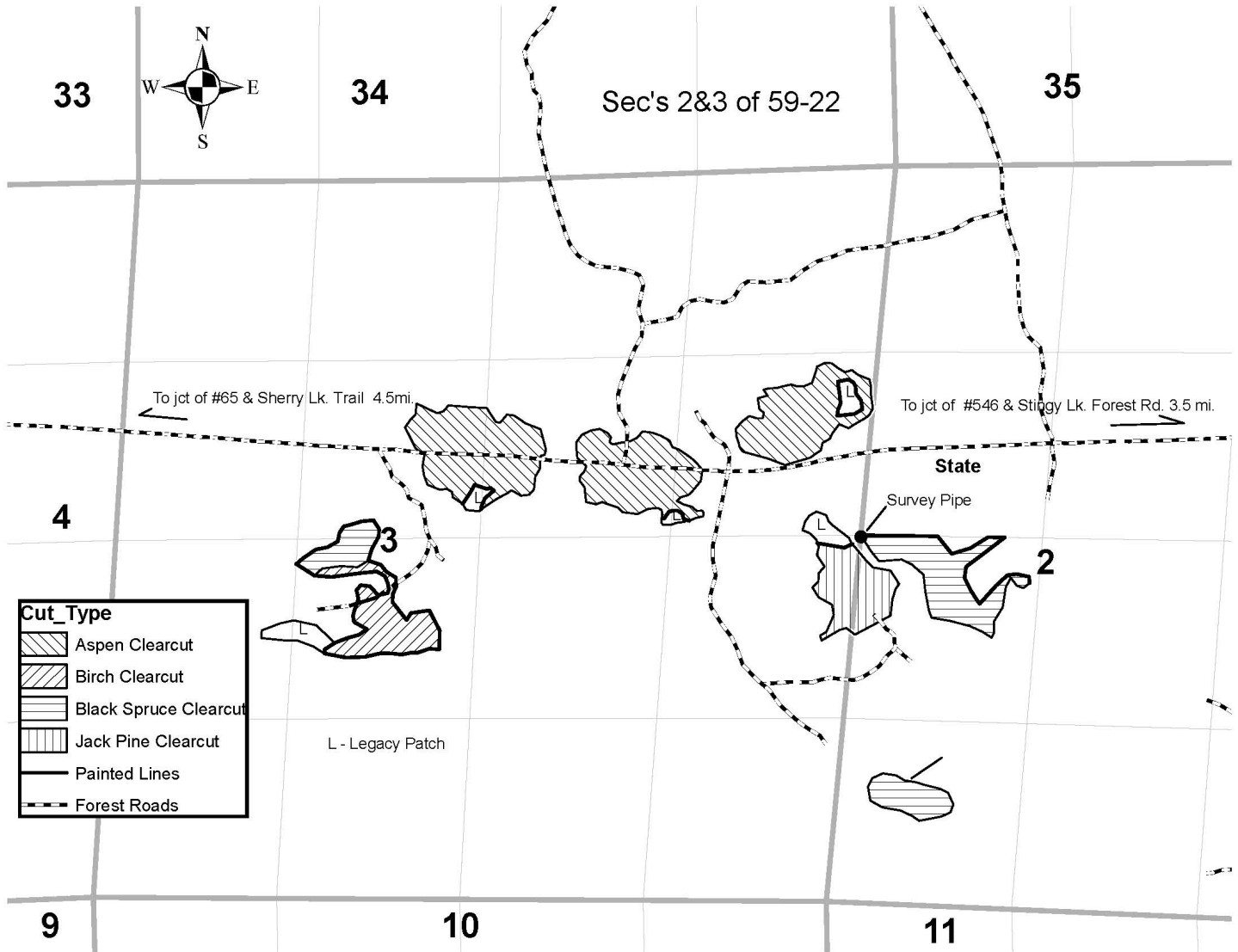

Appraisal examined and approved by \_\_\_\_\_ Forester \_\_\_\_\_ Date