

# Itasca County Timber Appraisal Report

<b>Appraised By:</b> Casey Dabrowski  <b>Appraisal Date:</b> 10/15/2019	<b>Sale Type:</b> REGULAR AUCTION SALE  <b>Auction Date:</b> 12/10/2019	<b>Appraisal Number:</b> 19-02-16 <b>Permit Number:</b> <b>Expiration Date:</b> 03/01/2022 <b>Page:</b> 1 of 3
---	---	---

**Legal Description**

<u>RE Code</u>	<u>Sec.</u>	<u>Twp.</u>	<u>Rge.</u>	<u>City/Twp</u>	<u>Subd</u>		
10-107-2200	7	62	23	Carpenter	LOT 1		
<u>Block 1 Species</u>	<u>Volume</u>	<u>Units</u>	<u>Unit Price</u>	<u>Value</u>	<u>Comments</u>	<u>Bolt %</u>	<u>Bid</u>
Aspen	1,156	Cords	\$24.00	\$27,744.00	5-13", 4-7 st, Fair.	5	^
Balm	25	Cords	\$17.00	\$425.00	6-8", 3-5 st, Poor.	0	#
Balsam Fir	23	Cords	\$13.00	\$299.00	5-7", 2-4 st, Good.	0	#
Ash	20	Cords	\$10.00	\$200.00	6-15", 3-6 st, Good.	20	#
				\$28,668.00	<b>Subtotal</b>		
<b>Total Cords =</b>	1,224	<b>Total MBF: 0</b>		\$28,668.00	<b>Total</b>		

Bid Symbols: ^ = Bid Species; # = Non-Bid Species; + = Sold Area Estimate; \* = Sold Area Estimate & Non-Bid Species  
 All species woodsrun unless listed otherwise.

**Species Scaled:** Ash , Aspen, Balm , Balsam Fir  
**Species SAE:**

**Operability:** Winter - Frozen Ground: 12/1 - 3/1      **Soil Type:** Effie Loam  
**Topography:** Level      **Cutting Acres:** 32.8

All permits must follow Itasca County Forest Management Guidelines and Specifications (can be found at <http://www.co.itasca.mn.us/DocumentCenter/View/567/Forest-Management-Guidelines-and-Specifications> ).

**Harvest Specifications**

Comments
Harvest type: aspen clearcut with reserves. Ash swale in center may be managed in an addendum if operator can harvest using single tree selection and process timber at the stump.

Harvest and Reserves
Harvest: clearcut all non-reserved timber. In windthrow damaged old timber in south, only remove standing aspen. Reserve: reserve all cedar, yellow birch, paper birch, elm, maple, spruce, pine, and balsam fir regeneration patches. Reserve all non-hazardous snags. Trees marked with "R" are to be reserved for wildlife.

Access
If private land is crossed to access timber sale, logger must obtain permits/permission from land owner/land manager. On Horseshoe Trail, snowmobile trail regulations in the Itasca County Forest Management Guideline & Specifications apply. A minimum of two inches of compacted snow must remain on the trail as a running surface. .5 miles to Horseshoe Lake Forest Road, 5 miles to Co Rd 542.

Landings and Access Roads
Location and construction of any new roads/landings must be pre-approved by the sale administrator. Trails and landings need to be rehabilitated to a satisfactory condition before performance bond is returned. Temporary snow/ice crossing needed for intermittent stream. Do not push dirt or debris into channel or pools. Timber sale administrator shall be notified at least 3 working days prior to completion of hauling and road work. This provides adequate time for permit area inspection and addressing of permit compliance requirements before hauling and road work equipment is removed.

## Itasca County Timber Appraisal Report

<b>Appraised By:</b> Casey Dabrowski <b>Appraisal Date:</b> 10/15/2019	<b>Sale Type:</b> REGULAR AUCTION SALE <b>Auction Date:</b> 12/10/2019	<b>Appraisal Number:</b> 19-02-16 <b>Permit Number:</b> <b>Expiration Date:</b> 03/01/2022 <b>Page:</b> 2 of 3
---	---	---

### Cutting, Felling, and Skidding

Do not fell timber into wetlands or across sale boundaries.

Do not disturb survey markers, including witness trees which have been painted orange.

Sale boundaries painted with orange lines (I I I) and ownership boundaries painted with orange circles (O O O). Some natural boundary is used; refer to sale map.

### Site, Soil, and Water Protection

Filter strips require <5% soil disturbance within 50' of all wetlands.

### Slash Disposal

Slash must be evenly distributed throughout permit area.

### Regeneration Plan

Natural regeneration to aspen.

# Itasca County Timber Appraisal Report

<b>Appraised By:</b> Casey Dabrowski	<b>Sale Type:</b> REGULAR AUCTION SALE	<b>Appraisal Number:</b> 19-02-16
<b>Appraisal Date:</b> 10/15/2019	<b>Auction Date:</b> 12/10/2019	<b>Permit Number:</b>
		<b>Expiration Date:</b> 03/01/2022
		<b>Page:</b> 3 of 3

**Site Map:**

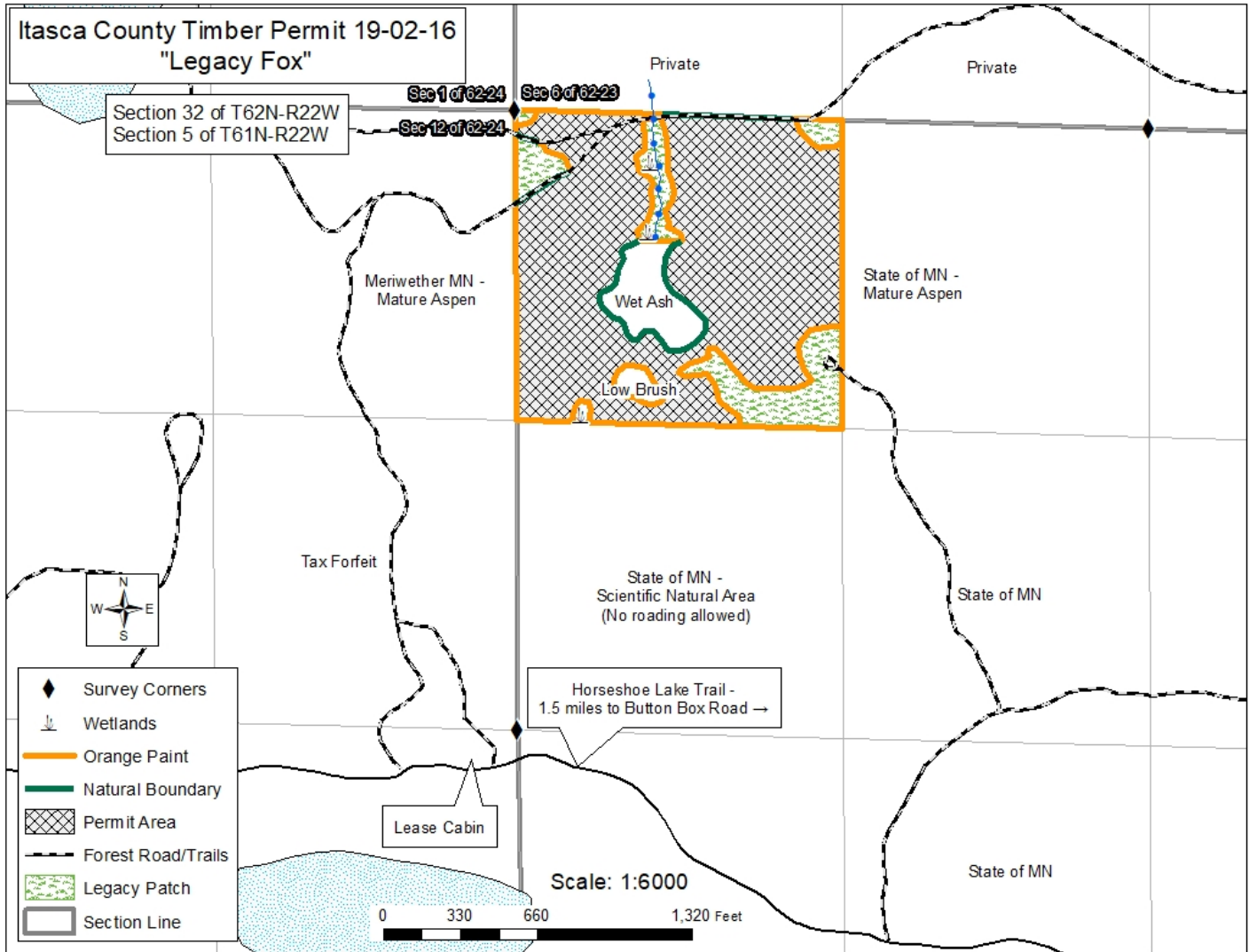

Appraisal examined and approved by \_\_\_\_\_  
Forester Date

Appraisal examined and approved by \_\_\_\_\_  
Land Department Date