

# Itasca County Timber Appraisal Report

<b>Appraised By:</b> Casey Dabrowski <b>Appraisal Date:</b> 09/18/2019	<b>Sale Type:</b> REGULAR AUCTION SALE <b>Auction Date:</b> 12/10/2019	<b>Appraisal Number:</b> 19-02-11 <b>Permit Number:</b> <b>Expiration Date:</b> 03/01/2022 <b>Page:</b> 1 of 3
---	---	---

**Legal Description**

<u>RE Code</u>	<u>Sec.</u>	<u>Twp.</u>	<u>Rge.</u>	<u>City/Twp</u>	<u>Subd</u>
10-015-1000	15	62	22	Carpenter	NE 1/4
10-015-2000	15	62	22	Carpenter	NW 1/4

<u>Block 1 Species</u>	<u>Volume</u>	<u>Units</u>	<u>Unit Price</u>	<u>Value</u>	<u>Comments</u>	<u>Bolt %</u>	<u>Bid</u>
Aspen	759	Cords	\$18.00	\$13,662.00	5-22", 3-8 st, Poor/Fair. (70-85 yrs)	0	^
Spruce	108	Cords	\$16.00	\$1,728.00	5-13", 2-5 st, Poor/Fair. White.	20	^
Balsam Fir	83	Cords	\$11.00	\$913.00	6-12", 3-5 st, Fair.	10	^
Ash	21	Cords	\$8.00	\$168.00	6-10", 3-4 st, Fair.	0	#
Balm	2	Cords	\$17.00	\$34.00	7-9", 3-4 st, Poor.	0	#

\$16,505.00    **Subtotal**

**Total Cords =**    973                                    **Total MBF: 0**    \$16,505.00    **Total**

Bid Symbols: ^ = Bid Species; # = Non-Bid Species; + = Sold Area Estimate; \* = Sold Area Estimate & Non-Bid Species  
All species woodsrun unless listed otherwise.

**Species Scaled:**    Ash , Aspen, Balm , Balsam Fir, Spruce

**Species SAE:**

<b>Operability:</b> Winter - Frozen Ground: 12/1 - 3/1	<b>Soil Type:</b> Effie Loam
<b>Topography:</b> Level	<b>Cutting Acres:</b> 41.0

All permits must follow Itasca County Forest Management Guidelines and Specifications (can be found at <http://www.co.itasca.mn.us/DocumentCenter/View/567/Forest-Management-Guidelines-and-Specifications> ).

**Harvest Specifications**

<b>Comments</b>
Harvest type: clearcut with reserves -- 36 ac aspen, 5 ac white spruce plantation.

<b>Harvest and Reserves</b>
Harvest: clearcut all aspen, spruce, balsam, ash and balm.
Reserve: Reserve patches of aspen and balsam regeneration (<5") and all birch, maple, elm, and trees marked with "R--R".
Reserve all non-hazardous snags.

<b>Access</b>
New winter road and snow approach to be constructed off Hwy 65 to facilitate future public access to timber. Grown over section line road and driveway to north is private property.
¼-¾ miles to public road State Hwy 65.
DOT permit may be required for snow approach off State Hwy.

<b>Landings and Access Roads</b>
Location and construction of any new roads/landings must be pre-approved by the sale administrator.
Trails and landings need to be rehabilitated to a satisfactory condition before performance bond is returned.
Timber sale administrator shall be notified at least 3 working days prior to completion of hauling and road work. This provides adequate time for permit area inspection and addressing of permit compliance requirements before hauling and road work equipment is removed.

<b>Cutting, Felling, and Skidding</b>
Sale boundaries painted with orange lines ( I I I ). Natural boundary is used on all blocks; see sale map.

**Itasca County Timber Appraisal Report**

<b>Appraised By:</b> Casey Dabrowski	<b>Sale Type:</b> REGULAR AUCTION SALE	<b>Appraisal Number:</b> 19-02-11
<b>Appraisal Date:</b> 09/18/2019	<b>Auction Date:</b> 12/10/2019	<b>Permit Number:</b> <b>Expiration Date:</b> 03/01/2022
		<b>Page:</b> 2 of 3

**Slash Disposal**

Slash must be evenly distributed throughout permit area.

**Regeneration Plan**

Natural regeneration to aspen

# Itasca County Timber Appraisal Report

<b>Appraised By:</b> Casey Dabrowski <b>Appraisal Date:</b> 09/18/2019	<b>Sale Type:</b> REGULAR AUCTION SALE <b>Auction Date:</b> 12/10/2019	<b>Appraisal Number:</b> 19-02-11 <b>Permit Number:</b> <b>Expiration Date:</b> 03/01/2022 <b>Page:</b> 3 of 3
---	---	---

**Site Map:**

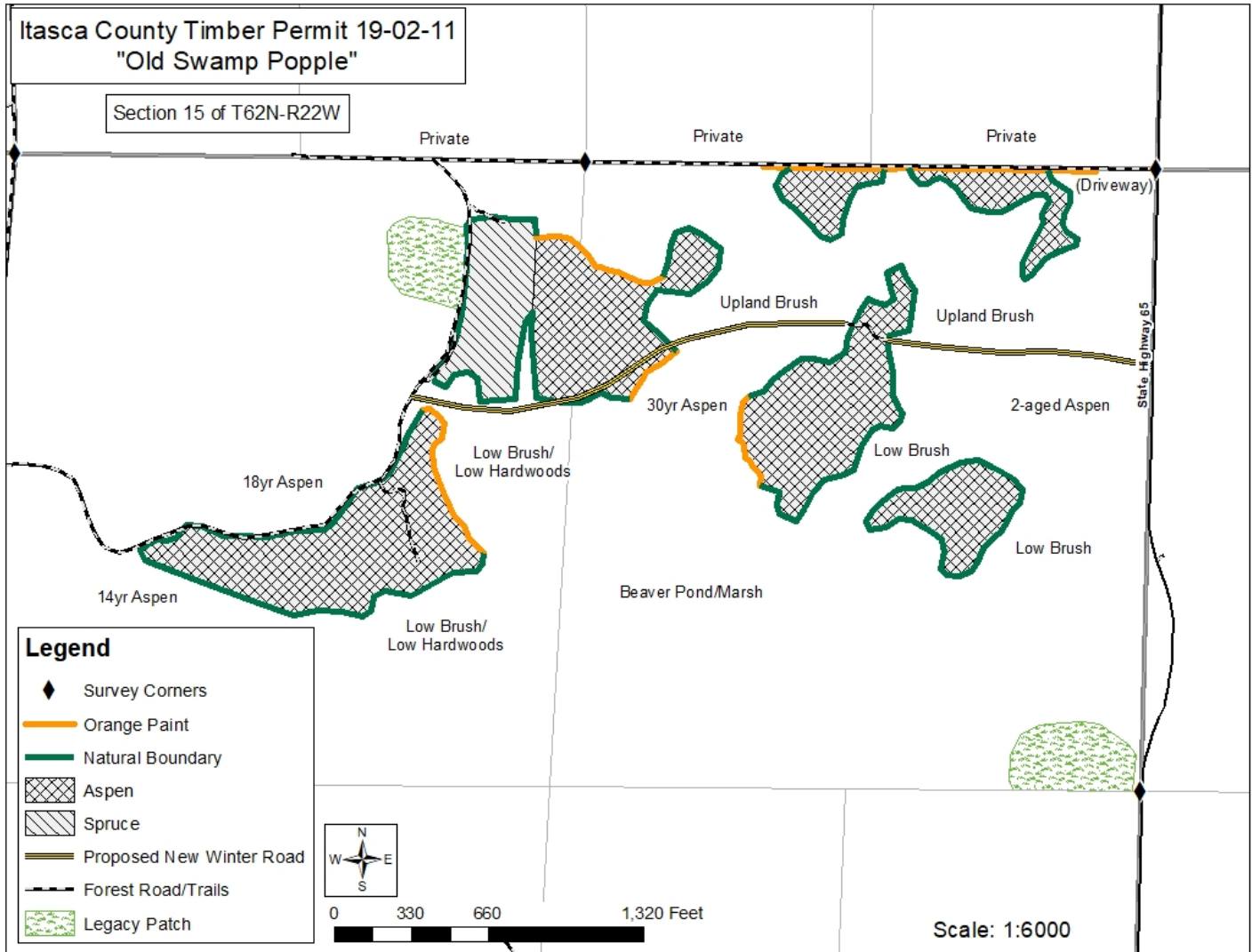

Appraisal examined and approved by \_\_\_\_\_  
Forester
Date

Appraisal examined and approved by \_\_\_\_\_  
Land Department
Date