

# Itasca County Timber Appraisal Report

<b>Appraised By:</b> Casey Dabrowski  <b>Appraisal Date:</b> 08/05/2019	<b>Sale Type:</b> SEALED BID-REGULAR  <b>Auction Date:</b> 06/12/2020	<b>Appraisal Number:</b> 19-02-09 <b>Permit Number:</b> <b>Expiration Date:</b> 03/01/2023 <b>Page:</b> 1 of 3
---	---	---

**Legal Description**

<u>RE Code</u>	<u>Sec.</u>	<u>Twp.</u>	<u>Rge.</u>	<u>City/Twp</u>	<u>Subd</u>		
10-221-1000	21	62	24	Carpenter	NE 1/4		
<u>Block 1 Species</u>	<u>Volume</u>	<u>Units</u>	<u>Unit Price</u>	<u>Value</u>	<u>Comments</u>	<u>Bolt %</u>	<u>Bid</u>
Red Pine	304	Cords	\$10.00	\$3,040.00	6-12", 2-6 st, Poor. (crook)	25	^
Balsam Fir	55	Cords	\$9.00	\$495.00	6-15", 2-5 st, Fair.	5	#
Aspen	1	Cords	\$17.00	\$17.00	5-7", 3-4 st, Fair.	0	#
Spruce	1	Cords	\$10.00	\$10.00	5-7", 2-4 st, Fair. White.	0	#
				<b>Subtotal</b>			
<b>Total Cords =</b>		361	<b>Total MBF: 0</b>		<b>Total</b>		

Bid Symbols: ^ = Bid Species; # = Non-Bid Species; + = Sold Area Estimate; \* = Sold Area Estimate & Non-Bid Species  
 All species woodsrun unless listed otherwise.

**Species Scaled:** Aspen, Balsam Fir, Red Pine, Spruce  
**Species SAE:**

**Operability:** Winter - Frozen ground: 12/1 - 3/1, Summer - DRY ground: 7/15 - 9/1      **Soil Type:** Nashwauk fine sandy loam  
**Topography:** Level to rolling      **Cutting Acres:** 25.3

All permits must follow Itasca County Forest Management Guidelines and Specifications (can be found at <http://www.co.itasca.mn.us/DocumentCenter/View/567/Forest-Management-Guidelines-and-Specifications> ).

**Harvest Specifications**

Comments
Harvest type: First time red pine thin.

Harvest and Reserves
Favor retention of spruce over pine. Reserve all non-hazardous snags. Trees marked with "R" are to be reserved for wildlife.

Access
State and/or Molpus land must be crossed to access timber sale. Logger must obtain permits/ permission from land owner/ land manager. 2 miles to public road State Hwy 1. Significant road work will be necessary for summer access.

Landings and Access Roads
Use existing roads and landings. Location and construction of any new roads/landings must be pre-approved by the sale administrator. Existing roads, trails and landings need to be rehabilitated to a satisfactory condition before performance bond is returned. Timber sale administrator shall be notified at least 3 working days prior to completion of hauling and road work. This provides adequate time for permit area inspection and addressing of permit compliance requirements before hauling and road work equipment is removed.

# Itasca County Timber Appraisal Report

<b>Appraised By:</b> Casey Dabrowski	<b>Sale Type:</b> SEALED BID-REGULAR	<b>Appraisal Number:</b> 19-02-09
<b>Appraisal Date:</b> 08/05/2019	<b>Auction Date:</b> 06/12/2020	<b>Permit Number:</b>
		<b>Expiration Date:</b> 03/01/2023
		<b>Page:</b> 2 of 3

### Cutting, Felling, and Skidding

Timber must be processed at the stump.

Do not fell timber into wetlands or across sale boundaries.

Cut 12 ft. access strips reserving 40 ft. in between strips for thinning. Thin stand down to an average of 90 basal area. Favor the removal of smaller diameter, poor quality, and damaged trees.

Do not disturb survey markers, including witness trees which have been painted orange.

Sale boundaries painted with orange lines (I I I). Ownership boundaries painted with orange circles (O O O). Some natural boundaries are used; see sale map.

Clay soils limit season of operability. Soils must be DRY for summer operability.

### Site, Soil, and Water Protection

Filter strips require <5% soil disturbance within 50' of all wetlands.

# Itasca County Timber Appraisal Report

<b>Appraised By:</b> Casey Dabrowski	<b>Sale Type:</b> SEALED BID-REGULAR	<b>Appraisal Number:</b> 19-02-09
<b>Appraisal Date:</b> 08/05/2019	<b>Auction Date:</b> 06/12/2020	<b>Permit Number:</b>
		<b>Expiration Date:</b> 03/01/2023
		<b>Page:</b> 3 of 3

**Site Map:**

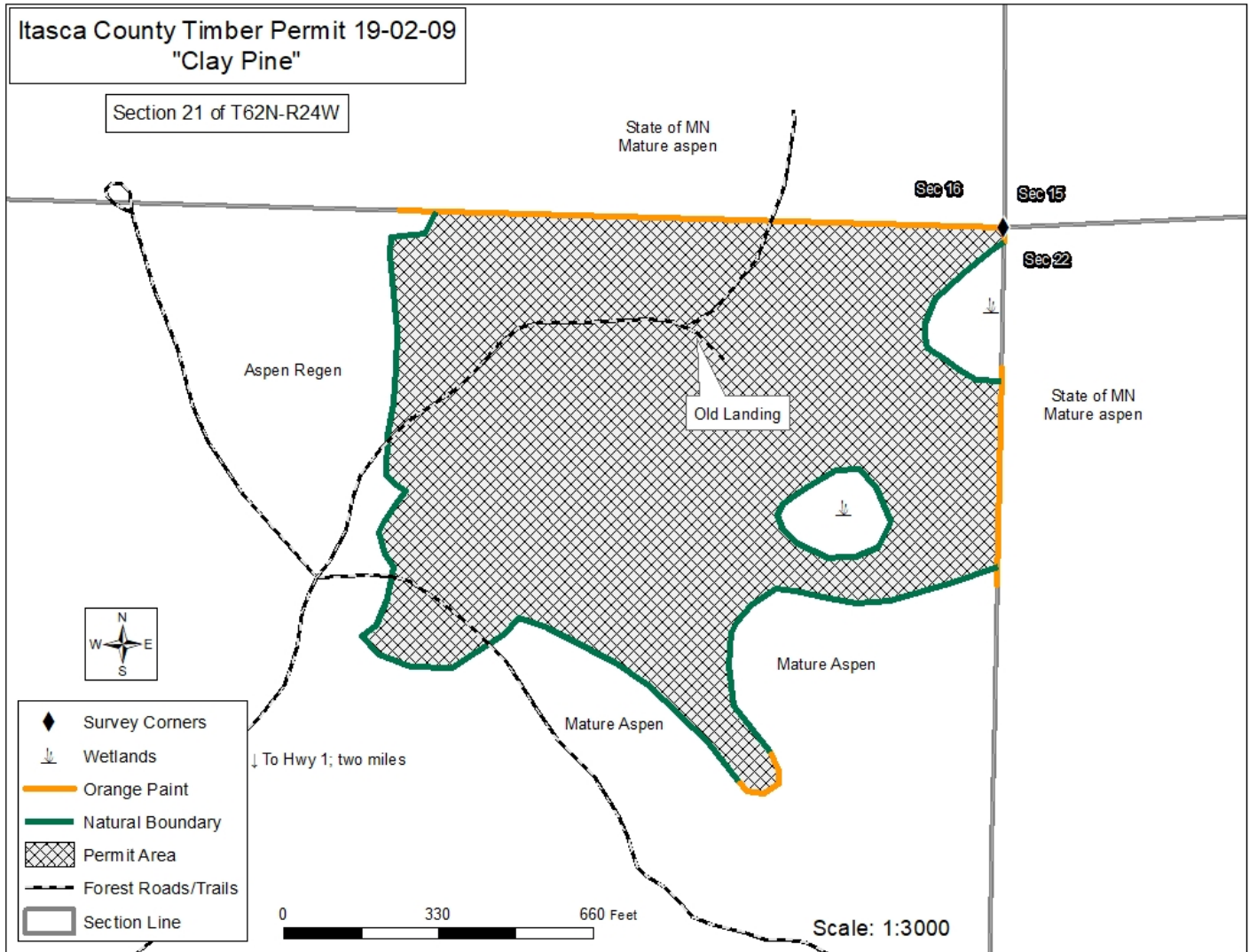

Appraisal examined and approved by \_\_\_\_\_  
Forester Date

Appraisal examined and approved by \_\_\_\_\_  
Land Department Date