

Itasca County Timber Appraisal Report

Appraised By: Casey Dabrowski Appraisal Date: 02/20/2019	Sale Type: INTERMEDIATE AUCTION Auction Date: 06/07/2019	Appraisal Number: 19-02-04 Permit Number: Expiration Date: 03/01/2022 Page: 1 of 3
---	---	---

Legal Description

RE Code	Sec.	Twp.	Rge.	City/Twp	Subd
10-219-1400	19	62	24	Carpenter	SE NE
10-219-4100	19	62	24	Carpenter	NE SE

Block 1 Species	Volume	Units	Unit Price	Value	Comments	Bolt %	Bid
Aspen	510	Cords	\$22.00	\$11,220.00	6-15", 4-6 st, Good.	5	^
Spruce	85	Cords	\$11.00	\$935.00	6-10", 2-5 st, Fair.	5	^
Balsam Fir	53	Cords	\$14.00	\$742.00	5-10", 3-5 st, Fair.	10	#
Maple	2	Cords	\$8.00	\$16.00	8-10", 3-4 st, Poor.	0	#
Ash	1	Cords	\$8.00	\$8.00	7-12", 3-4 st, Fair.	5	#
				\$12,921.00	Subtotal		
Total Cords =	651	Total MBF: 0		\$12,921.00	Total		

Bid Symbols: ^ = Bid Species; # = Non-Bid Species; + = Sold Area Estimate; * = Sold Area Estimate & Non-Bid Species
All species woodsrun unless listed otherwise.

Species Scaled: Ash , Aspen, Balsam Fir, Maple , Spruce

Species SAE:

Operability: Winter - Frozen Ground: 12/1 - 3/1	Soil Type: Keewatin silt loam, Nashwauk fine sandy loam
Topography: Level	Cutting Acres: 28.4

Harvest Specifications

Comments
Harvest type: Clearcut and 1st time thin; frozen ground harvest only.

Harvest and Reserves
Harvest: In aspen, cut all non-reserved species. In spruce, cut 12 ft. access strips reserving 40 ft. in between strips for thinning. Thin stand down to an average of 90 basal area. Consider all species equally when favoring the removal of smaller diameter, poor quality, and damaged trees.
Reserve: In aspen, reserve spruce and balsam under 6", maple regeneration, plus all birch, pine, and elm. In spruce, reserve aspen not overtopping crop trees.
Reserve all non-hazardous snags.
Trees marked with "R" are to be reserved for wildlife.

Access
0 miles to public road County Road 525.

Landings and Access Roads
Location and construction of roads and landings must be pre-approved by the sale administrator.
Reserve all non-merchantable timber within 15ft of county road.

Itasca County Timber Appraisal Report

Appraised By: Casey Dabrowski Appraisal Date: 02/20/2019	Sale Type: INTERMEDIATE AUCTION Auction Date: 06/07/2019	Appraisal Number: 19-02-04 Permit Number: Expiration Date: 03/01/2022 Page: 2 of 3
---	---	---

Cutting, Felling, and Skidding

Timber must be processed at the stump within spruce block.

Do not damage reserve trees.

Do not fell timber into wetlands or across sale boundaries.

Do not disturb survey markers, including bearing trees which have been painted orange.

Sale boundaries painted with orange slashes "I I I" and ownership boundaries are painted with orange circles "O O O". Some areas are natural boundary; refer to map.

Slash Disposal

Slash must be evenly distributed throughout permit area.

A 10 ft. wide slash free zone must be maintained along roads and trails.

Slash height must not exceed 3 ft. within view of road.

Itasca County Timber Appraisal Report

Appraised By:
Casey Dabrowski
Appraisal Date:
02/20/2019

Sale Type:
INTERMEDIATE AUCTION
Auction Date:
06/07/2019

Appraisal Number: 19-02-04
Permit Number:
Expiration Date: 03/01/2022
Page: 3 of 3

Site Map:

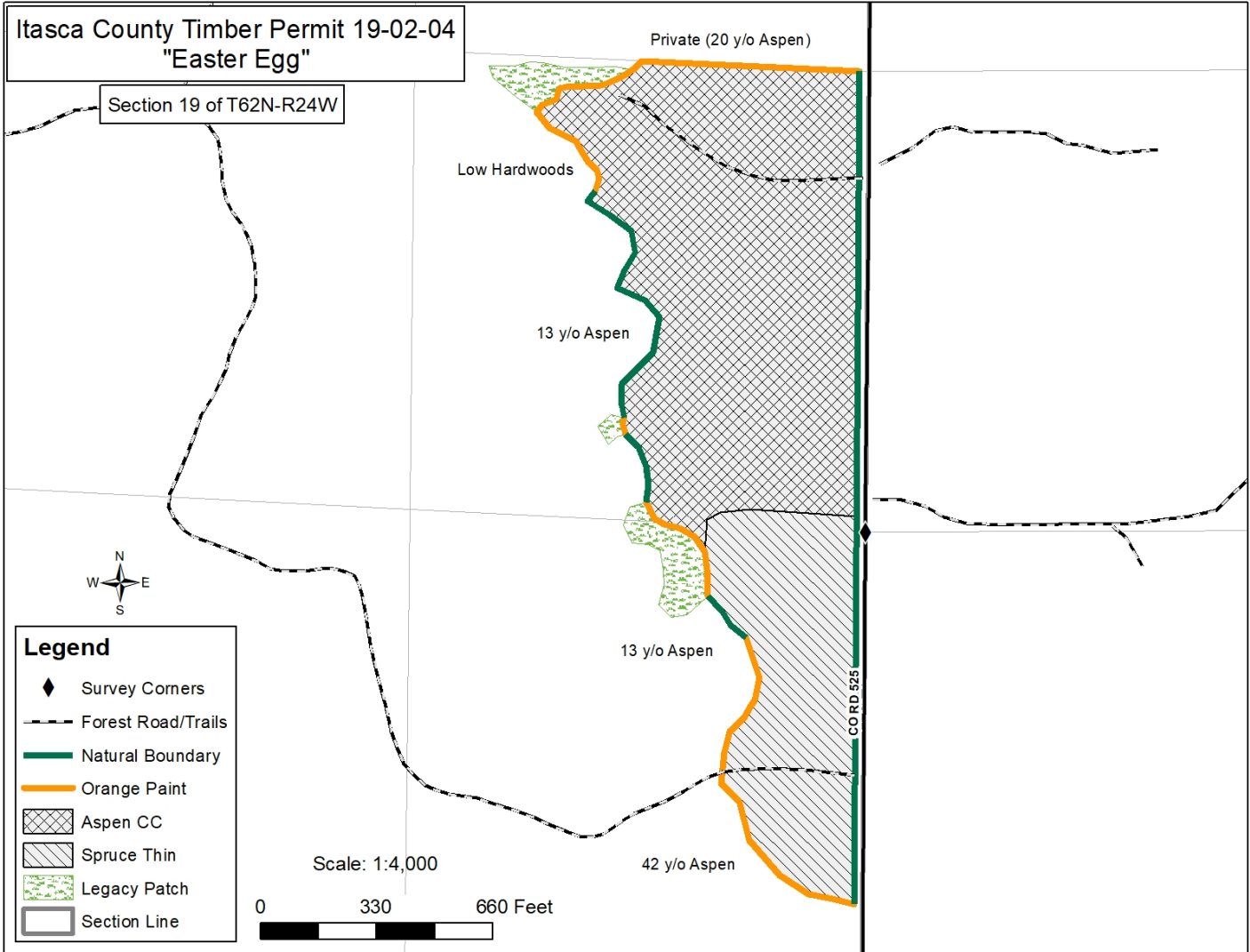

Appraisal examined and approved by _____ Forester _____ Date _____