

Itasca County Timber Appraisal Report

Appraised By: Jesse Lehner Appraisal Date: 06/05/2018	Sale Type: INTERMEDIATE AUCTION Auction Date: 12/11/2018	Appraisal Number: 18-07-10 Permit Number: Expiration Date: 03/01/2021 Page: 1 of 3
--	---	---

Legal Description

RE Code	Sec.	Twp.	Rge.	City/Twp	Subd				
50-013-3000	13	55	23	Unorganized	SW 1/4				
50-024-2000	24	55	23	Unorganized	NW 1/4				
Block 1 Species	Volume	Units	Unit Price	Value	Comments	Bolt %	Bid		
Maple	70	Cords	\$7.00	\$490.00			^		
Basswood	52	Cords	\$8.00	\$416.00	10% saw	20	^		
Red Oak	32	Cords	\$15.00	\$480.00	15% Saw, 17 inch DBH	15	#		
Paper Birch	5	Cords	\$8.00	\$40.00	25% saw	5	#		
Aspen	4	Cords	\$15.00	\$60.00			#		
				\$1,486.00	Subtotal				
Total Cords =		163	Total MBF: 0		\$1,486.00	Total			

Bid Symbols: ^ = Bid Species; # = Non-Bid Species; + = Sold Area Estimate; * = Sold Area Estimate & Non-Bid Species
 All species woodsrun unless listed otherwise.

Species Scaled: Aspen, Basswood , Maple , Paper Birch , Red Oak

Species SAE:

Operability: Summer Dry: 7/15 - 10/1	Soil Type: Itasca-Goodland silt loams
Topography: Level to rolling	Cutting Acres: 14.2

Harvest Specifications

Comments
Harvest type: Marked Hardwood Thin Cut all stems ringed with orange paint.

Harvest and Reserves

Reserve all non-hazardous snags.
Trees marked with "R" are to be reserved for wildlife.

Access

Gate must be locked at all times, except on days when 3 or more loads are hauled.
Gates must remain locked during hunting season.

Landings and Access Roads

Location and construction of any new roads/landings must be pre-approved by the sale administrator.

Cutting, Felling, and Skidding

Timber must be processed at the stump.
Minimize damage to reserve species.
Do not damage unmarked trees / regeneration / reserve trees.

Site, Soil, and Water Protection

If site/soil damage becomes apparent, alter or cease operations and contact sale administrator immediately.
Filter strips require <5% soil disturbance within 50' of all wetlands.

Itasca County Timber Appraisal Report

Appraised By: Jesse Lehner Appraisal Date: 06/05/2018	Sale Type: INTERMEDIATE AUCTION Auction Date: 12/11/2018	Appraisal Number: 18-07-10 Permit Number: Expiration Date: 03/01/2021 Page: 2 of 3
--	---	---

Slash Disposal

Slash must be scattered throughout permit area.

Special Conditions

Loads with mixed species will be scaled as the highest value species unless the consumer scales species separately using County approved methods.

Regeneration Plan

Natural Regeneration

Itasca County Timber Appraisal Report

Appraised By: Jesse Lehner	Sale Type: INTERMEDIATE AUCTION	Appraisal Number: 18-07-10
Appraisal Date: 06/05/2018	Auction Date: 12/11/2018	Permit Number:
		Expiration Date: 03/01/2021
		Page: 3 of 3

Site Map:

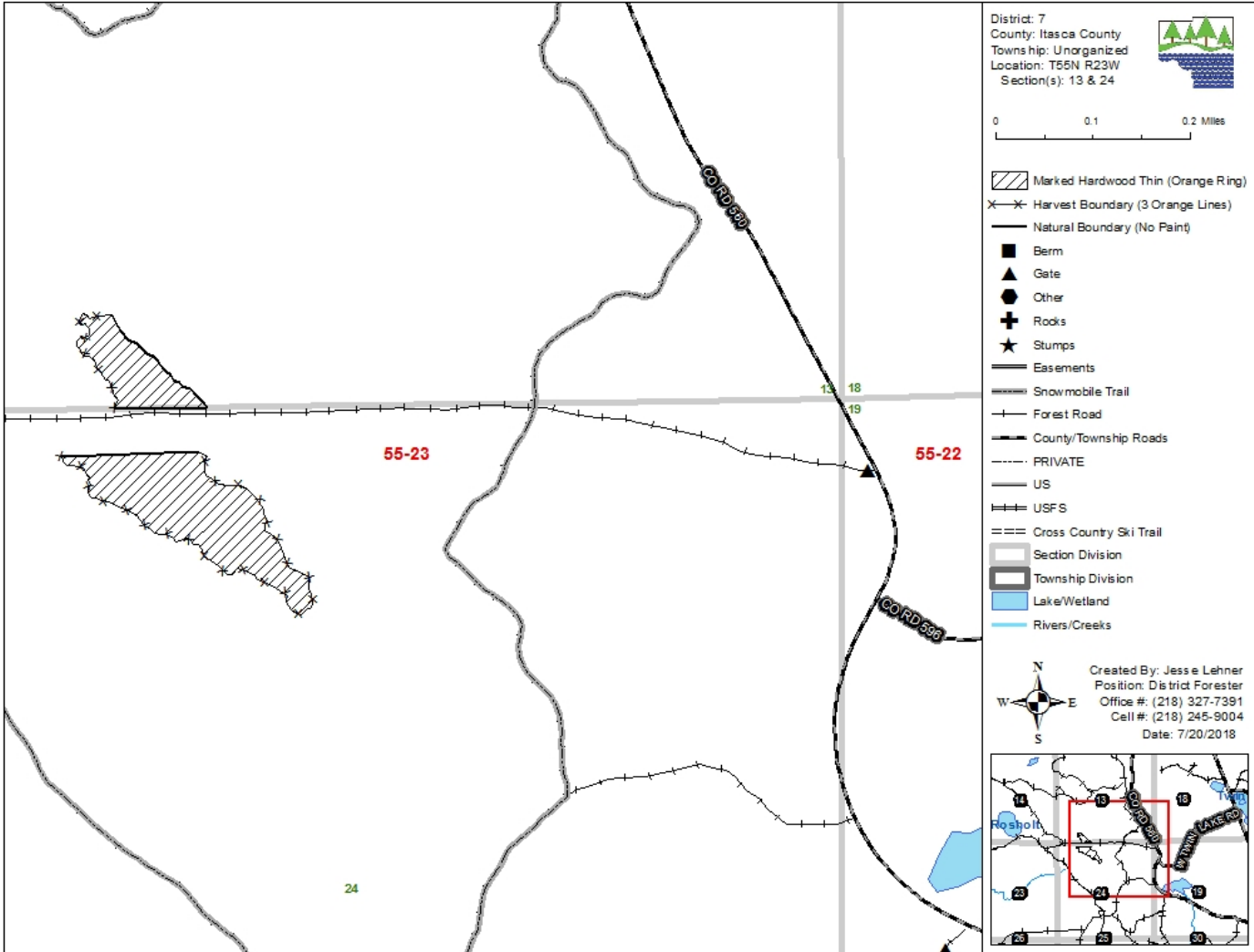

Appraisal examined and approved by _____ Forester _____ Date _____