

Itasca County Timber Appraisal Report

Appraised By: Jesse Lehner Appraisal Date: 05/24/2018	Sale Type: REGULAR AUCTION SALE Auction Date: 12/11/2018	Appraisal Number: 18-07-09 Permit Number: Expiration Date: 03/01/2021 Page: 1 of 3
--	---	---

Legal Description

RE Code	Sec.	Twp.	Rge.	City/Twp	Subd
14-115-3200	15	55	22	Goodland	NW SW
14-115-3300	15	55	22	Goodland	SW SW
14-121-0000	21	55	22	Goodland	ALL OF SECTION
14-122-2000	22	55	22	Goodland	NW 1/4

Block 1 Species	Volume	Units	Unit Price	Value	Comments	Bolt %	Bid
Aspen	305	Cords	\$26.00	\$7,930.00	5-8 stick, 7-17 in. Dbh	10	^
Paper Birch	255	Cords	\$9.00	\$2,295.00	3-7 stick, 7-14 in. Dbh	20	^
Red Pine	251	Cords	\$45.00	\$11,295.00	+/- 60% Saw	30	^
Maple	95	Cords	\$8.00	\$760.00			#
Red Oak	27	Cords	\$8.00	\$216.00			#
Balsam Fir	18	Cords	\$11.00	\$198.00			#
				\$22,694.00	Subtotal		
Total Cords =	951			Total MBF: 0	Total		

Bid Symbols: ^ = Bid Species; # = Non-Bid Species; + = Sold Area Estimate; * = Sold Area Estimate & Non-Bid Species
 All species woodsrun unless listed otherwise.

Species Scaled: Aspen, Balsam Fir, Maple , Paper Birch , Red Oak, Red Pine

Species SAE:

Operability: Summer Dry: 7/1 - 10/1	Soil Type: Menahga-Itasca Complex
Topography: Rolling	Cutting Acres: 28.7

Harvest Specifications

Comments
Harvest type: Clear-cut w/reserves & Birch seed tree

Harvest and Reserves
Clear-cut w/reserves: Cut all stems, except reserve species.
Birch seed tree: Reserve 4-6 single stemmed, full crowned Birch per acre scattered throughout seed tree units.
Reserve all White pine, Yellow birch, and Balsam fir with 2 or fewer sticks.
Reserve all non-hazardous snags and cavity trees.

Access
Federal / State / Private must be crossed to access timber sale. Logger must obtain permits/ permission from land owner/ land manager.

Landings and Access Roads
Location and construction of any new roads/landings must be pre-approved by the sale administrator.
Trails and landings need to be rehabilitated to a satisfactory condition before performance bond is returned.
Roads and landings must be approved by forester.

Itasca County Timber Appraisal Report

Appraised By: Jesse Lehner Appraisal Date: 05/24/2018	Sale Type: REGULAR AUCTION SALE Auction Date: 12/11/2018	Appraisal Number: 18-07-09 Permit Number: Expiration Date: 03/01/2021 Page: 2 of 3
--	---	---

Cutting, Felling, and Skidding

Minimize damage to reserve species.
 Do not damage unmarked trees / regeneration / reserve trees.
 Do not fell timber into wetlands or across ownership boundaries.

Site, Soil, and Water Protection

If site/soil damage becomes apparent, alter or cease operations and contact sale administrator immediately.
 No cutting is allowed within RMZs on this permit.
 Reserve all non-merchantable timber within 15ft of all wetlands.
 Filter strips require <5% soil disturbance within 50' of all wetlands.

Slash Disposal

Slash must be scattered throughout permit area.

Regeneration Plan

Natural Regeneration
 Plant Red Pine

Itasca County Timber Appraisal Report

Appraised By: Jesse Lehner	Sale Type: REGULAR AUCTION SALE	Appraisal Number: 18-07-09
Appraisal Date: 05/24/2018	Auction Date: 12/11/2018	Permit Number:
		Expiration Date: 03/01/2021
		Page: 3 of 3

Site Map:

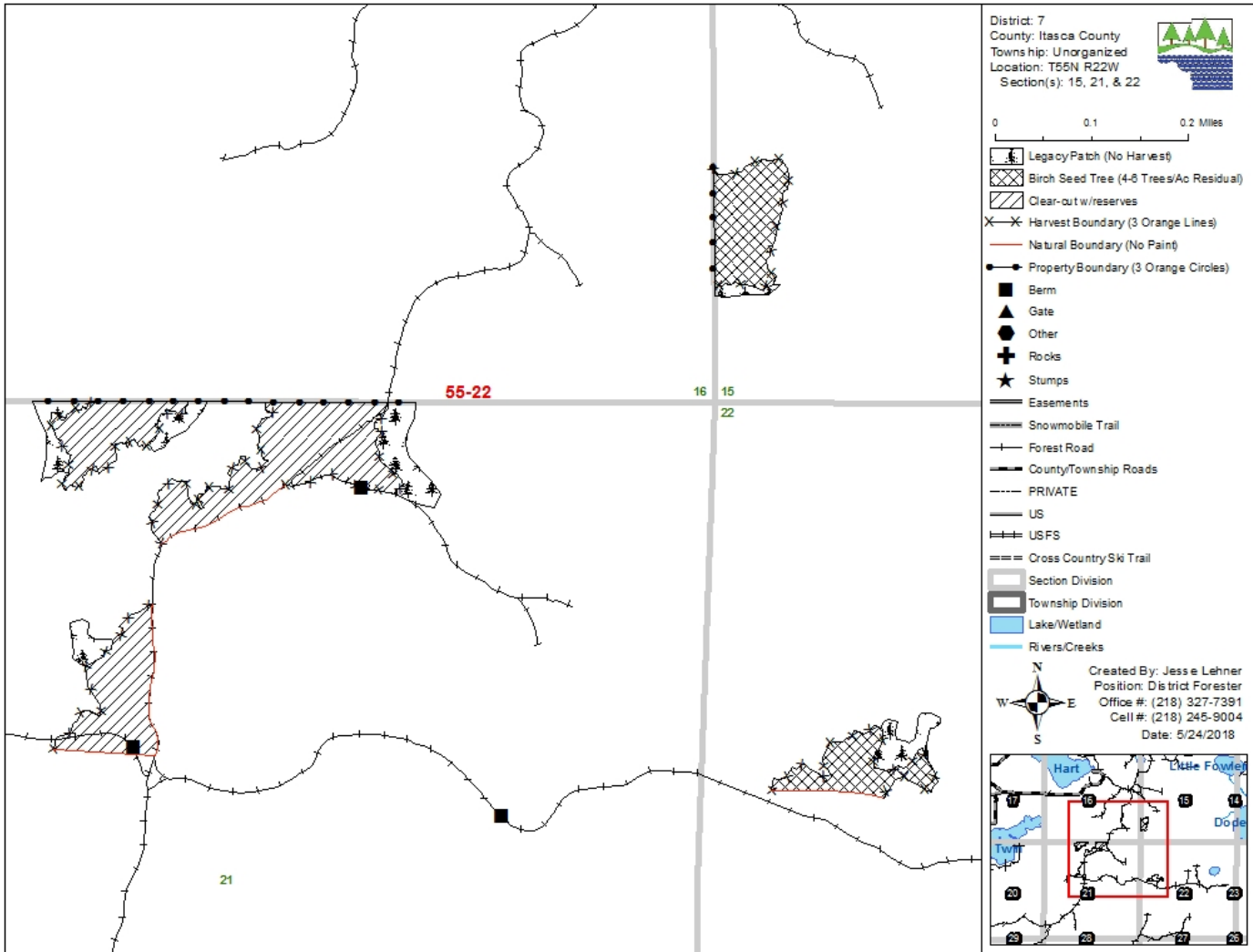

Appraisal examined and approved by _____ Forester _____ Date _____