

Itasca County Timber Appraisal Report

Appraised By: Jesse Lehner Appraisal Date: 07/12/2018	Sale Type: INTERMEDIATE AUCTION Auction Date: 12/11/2018	Appraisal Number: 18-07-07 Permit Number: Expiration Date: 03/01/2021 Page: 1 of 3
--	---	---

Legal Description

<u>RE Code</u>	<u>Sec.</u>	<u>Twp.</u>	<u>Rge.</u>	<u>City/Twp</u>	<u>Subd</u>		
14-110-3000	10	55	22	Goodland	SW 1/4		
14-115-2100	15	55	22	Goodland	NE NW		
<u>Block 1 Species</u>	<u>Volume</u>	<u>Units</u>	<u>Unit Price</u>	<u>Value</u>	<u>Comments</u>	<u>Bolt %</u>	<u>Bid</u>
Maple	130	Cords	\$8.00	\$1,040.00	1-5 stick, 7-20 Dbh, Fair condition		^
Paper Birch	79	Cords	\$17.00	\$1,343.00	2-7 stick, 9-19 Dbh, 30% saw, Fair condition	30	^
Red Oak	67	Cords	\$26.00	\$1,742.00	3-7 stick, 8-23 Dbh, 20% saw, Good condition	50	^
Aspen	38	Cords	\$26.00	\$988.00	8 stick, 22-27 Dbh, Poor condition		#
Basswood	19	Cords	\$14.00	\$266.00	6-8 stick, 14-20 Dbh, 35% saw, Good condition	20	#
				\$5,379.00	Subtotal		
Total Cords =	333			Total MBF: 0	Total		

Bid Symbols: ^ = Bid Species; # = Non-Bid Species; + = Sold Area Estimate; * = Sold Area Estimate & Non-Bid Species
 All species woodsrun unless listed otherwise.

Species Scaled: Aspen, Basswood, Maple, Paper Birch, Red Oak

Species SAE:

Operability: Dry Summer: 7/1 - 10/1	Soil Type: Menahga-Itasca Complex
Topography: Level to rolling	Cutting Acres: 24.1

Harvest Specifications

Comments
Harvest type: Marked Hardwood Thinning REOFFER

Harvest and Reserves
Cut all stems ringed with orange paint. Also, severe or run over Ironwood regeneration. Reserve all unmarked trees, non-hazardous snags and cavity trees. All individual trees marked with an orange "R" are to be reserved due to high wildlife value.

Access
ATV trail regulations in Itasca County Forest Management Guideline & Specifications apply. Gate must be locked at all times, except on days when 3 or more loads are hauled. Gates must remain locked during hunting season.

Landings and Access Roads
Location and construction of any new roads/landings must be pre-approved by the sale administrator. Trails and landings need to be rehabilitated to a satisfactory condition before performance bond is returned. Berm(s) must be installed when hauling and road work is complete. District Forester will determine material, size, and location.

Itasca County Timber Appraisal Report

Appraised By: Jesse Lehner Appraisal Date: 07/12/2018	Sale Type: INTERMEDIATE AUCTION Auction Date: 12/11/2018	Appraisal Number: 18-07-07 Permit Number: Expiration Date: 03/01/2021 Page: 2 of 3
--	---	---

Cutting, Felling, and Skidding

Utilize all merchantable timber felled during road/trail construction.
 Timber must be processed at the stump.
 Minimize damage to reserve species.
 Do not damage unmarked trees / regeneration / reserve trees.
 Do not fell timber into wetlands or across ownership boundaries.

Site, Soil, and Water Protection

Filter strips require <5% soil disturbance within 50' of all wetlands.
 If site/soil damage becomes apparent, alter or cease operations and contact sale administrator immediately.
 Roads and skid trails must be stabilized. This may involve slashing, installing water bar, strikeouts, and / or mulching and seeding.

Slash Disposal

Slash must be scattered throughout permit area.
 If chipping, 20% of tops and limbs must be scattered throughout the permit area per Site Level Forest Management Guideline. The 20% is in addition to incidental breakage.

Regeneration Plan

Natural Regeneration

Itasca County Timber Appraisal Report

Appraised By: Jesse Lehner	Sale Type: INTERMEDIATE AUCTION	Appraisal Number: 18-07-07
Appraisal Date: 07/12/2018	Auction Date: 12/11/2018	Permit Number:
		Expiration Date: 03/01/2021
		Page: 3 of 3

Site Map:

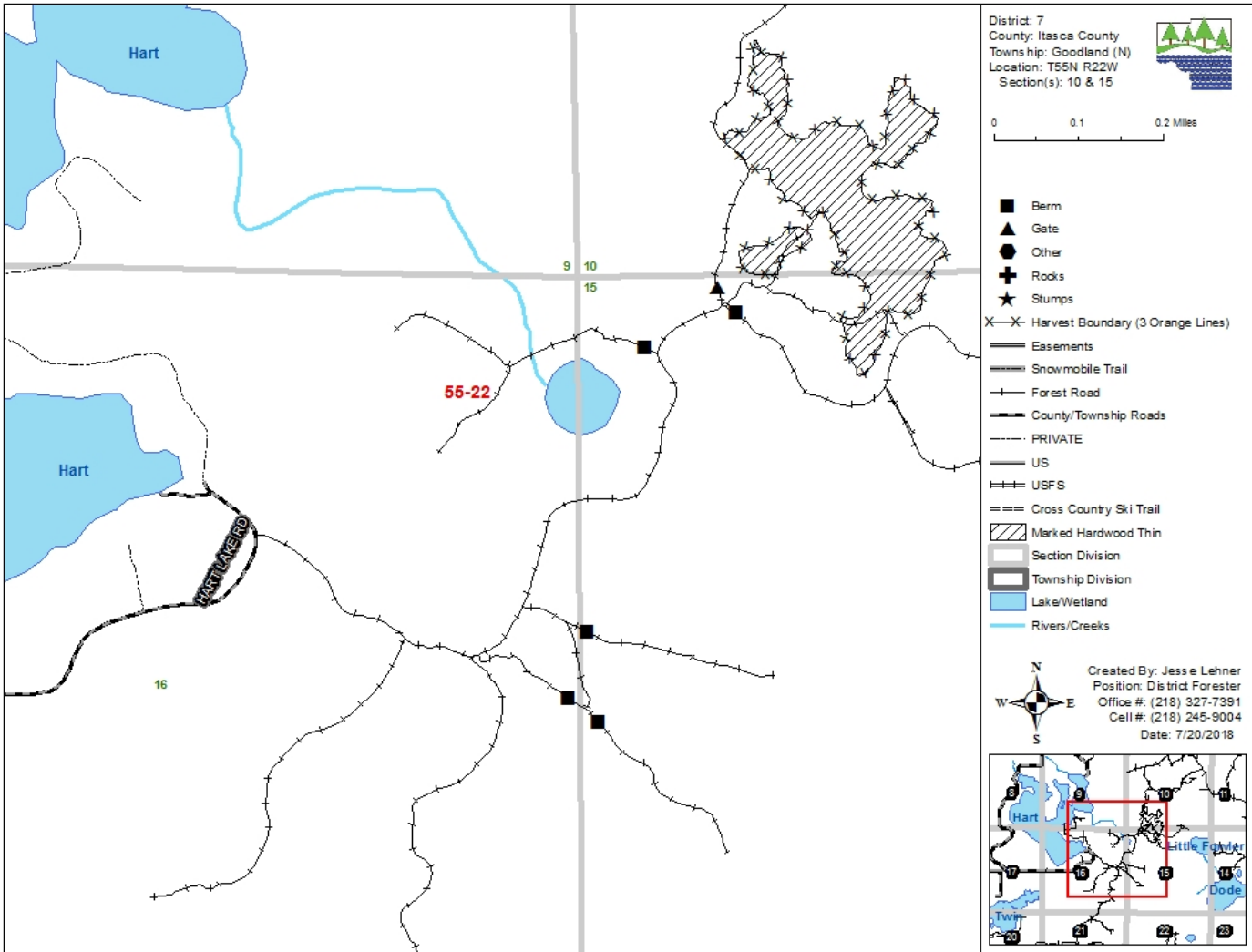

Appraisal examined and approved by _____ Forester _____ Date _____