

## Itasca County Timber Appraisal Report

<b>Appraised By:</b> Jesse Lehner <b>Appraisal Date:</b> 05/24/2018	<b>Sale Type:</b> REGULAR AUCTION SALE <b>Auction Date:</b> 12/11/2018	<b>Appraisal Number:</b> 18-07-06 <b>Permit Number:</b> <b>Expiration Date:</b> 03/01/2021 <b>Page:</b> 1 of 3
--	---	---

**Legal Description**

<u>RE Code</u>	<u>Sec.</u>	<u>Twp.</u>	<u>Rge.</u>	<u>City/Twp</u>	<u>Subd</u>
88-020-1100	20	56	24	Iron Range	NE-NE
88-021-2201	21	56	24	Iron Range	NW-NW
88-021-2301	21	56	24	Iron Range	SW-NW
88-029-2200	29	56	24	Iron Range	NW-NW

<u>Block 1 Species</u>	<u>Volume</u>	<u>Units</u>	<u>Unit Price</u>	<u>Value</u>	<u>Comments</u>	<u>Bolt %</u>	<u>Bid</u>
Aspen	925	Cords	\$26.00	\$24,050.00	6-8 stick, 11-16 in. Dbh	10	^
Balm	66	Cords	\$17.00	\$1,122.00	6-7 stick, 12-15 in. Dbh		#
Balsam Fir	31	Cords	\$15.00	\$465.00	3-5 stick, 8-10 in. Dbh	30	#
Paper Birch	16	Cords	\$6.00	\$96.00			#
Ash	8	Cords	\$6.00	\$48.00			#

\$25,781.00    **Subtotal**

**Total Cords =**    1,046                      **Total MBF: 0**    \$25,781.00    **Total**

Bid Symbols: ^ = Bid Species; # = Non-Bid Species; + = Sold Area Estimate; \* = Sold Area Estimate & Non-Bid Species  
 All species woodsrun unless listed otherwise.

**Species Scaled:**    Ash , Aspen, Balm , Balsam Fir, Paper Birch

**Species SAE:**

<b>Operability:</b> Dry summer/Winter Frozen 7/1-9/15, 12/1-3/1	<b>Soil Type:</b> Nashwauk fine sandy loam
<b>Topography:</b> Level to rolling	<b>Cutting Acres:</b> 33.9

**Harvest Specifications**

<b>Comments</b>
Harvest type: Clear-cut with reserves. NON-FSC FIBER SOURCE

<b>Harvest and Reserves</b>
Also, reserve all Red pine, White pine, Maple, Basswood, and Oak species. In addition, reserve all Balsam fir with 2 or less sticks and all non-hazardous snags.

<b>Access</b>
Gate must be locked at all times, except on days when 3 or more loads are hauled. Gates must remain locked during hunting season. It is the permit holder's responsibility to obtain approval from all affected landowners and/or management agencies before gaining access to the permit area. The permit holder shall pay all access fees and road charges.

<b>Landings and Access Roads</b>
Location and construction of any new roads/landings must be pre-approved by the sale administrator. Trails and landings need to be rehabilitated to a satisfactory condition before performance bond is returned.

<b>Cutting, Felling, and Skidding</b>
Minimize damage to reserve species. Do not damage unmarked trees / regeneration / reserve trees. Do not fell timber into wetlands or across ownership boundaries.

## Itasca County Timber Appraisal Report

<b>Appraised By:</b> Jesse Lehner <b>Appraisal Date:</b> 05/24/2018	<b>Sale Type:</b> REGULAR AUCTION SALE <b>Auction Date:</b> 12/11/2018	<b>Appraisal Number:</b> 18-07-06 <b>Permit Number:</b> <b>Expiration Date:</b> 03/01/2021 <b>Page:</b> 2 of 3
--	---	---

### Site, Soil, and Water Protection

Filter strips require <5% soil disturbance within 50' of all wetlands.

If site/soil damage becomes apparent, alter or cease operations and contact sale administrator immediately.

Roads and skid trails must be stabilized. This may involve slashing, installing water bar, strikeouts, and / or mulching and seeding.

Reserve all non-merchantable timber within 15ft of all wetlands.

### Slash Disposal

Slash must be scattered throughout permit area.

### Special Conditions

Timber must be removed from site by the end of the same season as harvesting operations.

Loads with mixed species will be scaled as the highest value species unless the consumer scales species separately using County approved methods.

### Regeneration Plan

Natural Regeneration

# Itasca County Timber Appraisal Report

<b>Appraised By:</b> Jesse Lehner	<b>Sale Type:</b> REGULAR AUCTION SALE	<b>Appraisal Number:</b> 18-07-06
<b>Appraisal Date:</b> 05/24/2018	<b>Auction Date:</b> 12/11/2018	<b>Permit Number:</b>
		<b>Expiration Date:</b> 03/01/2021
		<b>Page:</b> 3 of 3

**Site Map:**

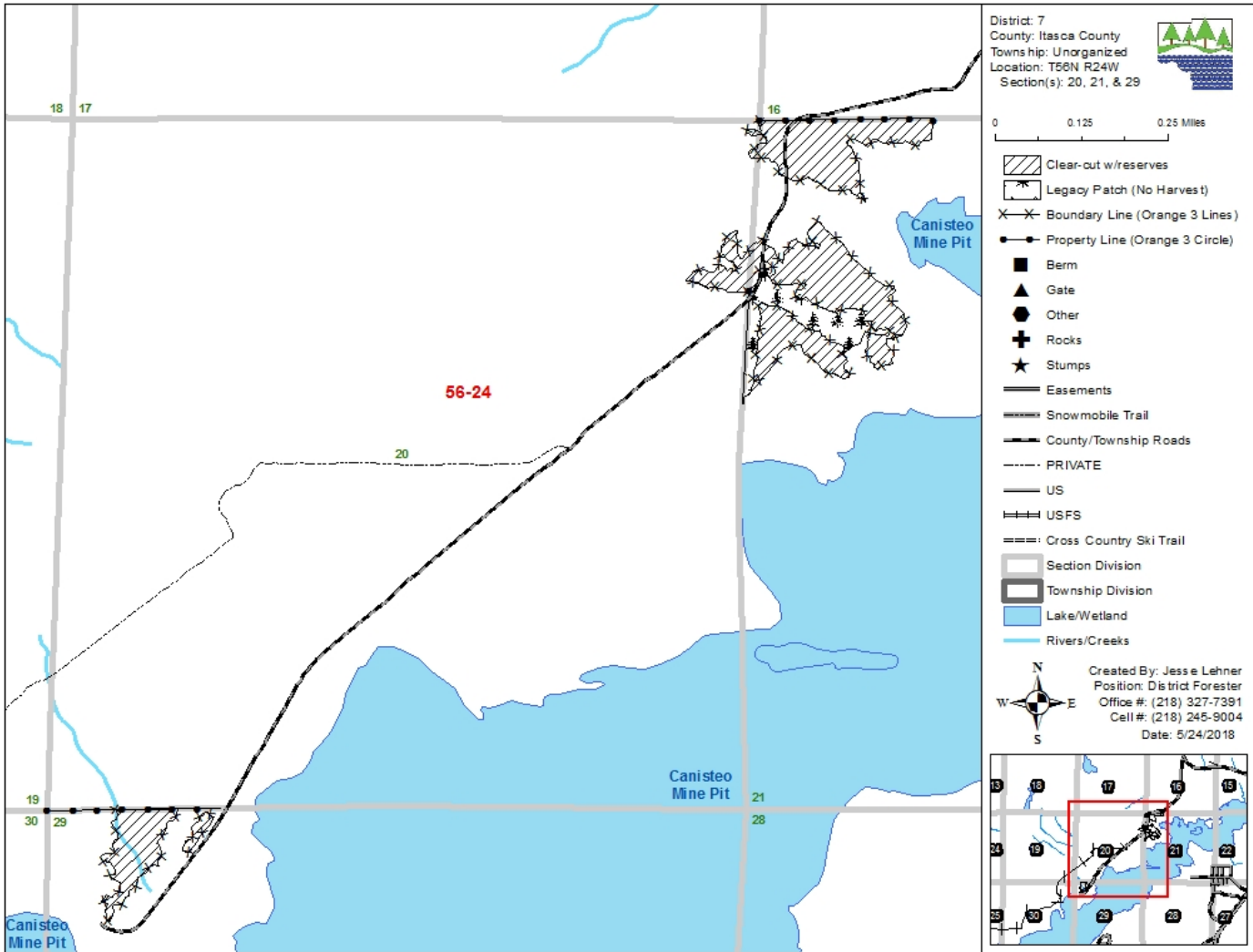

Appraisal examined and approved by \_\_\_\_\_

Forester

Date