

Itasca County Timber Appraisal Report

Appraised By:

Tony Schram

Appraisal Date:

07/20/2018

Sale Type:

REGULAR AUCTION SALE

Auction Date:

12/11/2018

Appraisal Number: 18-06-07**Permit Number:****Expiration Date:** 03/01/2021**Page:** 1 of 3**Legal Description**

RE Code	Sec.	Twp.	Rge.	City/Twp	Subd			
28-019-3100	19	149	29	Moose Park	NE SW			
28-019-4200	19	149	29	Moose Park	NW SE			
Block 1 Species	Volume	Units	Unit Price	Value	Comments	Bolt %	Bid	
Paper Birch	457	Cords	\$12.00	\$5,484.00	6-15", 3-7 st., Good.	30	^	
Ash	229	Cords	\$9.00	\$2,061.00	5-12", 3-6 st., Good.	5	^	
Basswood	233	Cords	\$12.00	\$2,796.00	8-20", 4-7 st., Good.	50	^	
Balm	210	Cords	\$17.00	\$3,570.00	10-17", 4-8 st., Fair.	0	^	
Aspen	116	Cords	\$22.00	\$2,552.00	12-20", 6-9 st., Poor.	0	^	
Maple	61	Cords	\$9.00	\$549.00	5-10", 3-5 st, Fair. 75% sugar maple	0	#	
				\$17,012.00	Subtotal			
Total Cords =	1,306		Total MBF: 0	\$17,012.00	Total			

Bid Symbols: ^ = Bid Species; # = Non-Bid Species; + = Sold Area Estimate; * = Sold Area Estimate & Non-Bid Species
All species woodsrun unless listed otherwise.

Species Scaled: Ash , Aspen, Balm , Basswood , Maple , Paper Birch

Species SAE:

Operability: Winter - Frozen Ground: 12/15 - 3/1

Soil Type: Suomi silt loam

Topography: Level to rolling

Cutting Acres: 37.9

Harvest Specifications**Comments**

"Beighley Road Hardwoods" Birch Seed Tree with maked reserves

Harvest and Reserves

Harvest: Cut all unmarked aspen, balm, ash, maple.

Reserve trees marked with an "R" and all oak, elm, spruce; reserve birch/basswood < 6".

Reserve 1 well formed birch every 80 feet. If no birch available reserve a well formed Basswood or Maple in its place.

Access

Gated Federal roads must be used to access timber sale. Logger must abide by terms of road use permit.

Landings and Access Roads

Location and construction of any new roads/landings must be pre-approved by the sale administrator.

Cutting, Felling, and Skidding

Do not damage "R" marked reserve trees or reserve species.

Do not fell timber into wetlands or across ownership boundaries.

Harvest & wetland/legacy boundaries painted with orange lines; property lines painted orange circles.

Site, Soil, and Water Protection

Filter strips require <5% soil disturbance within 50' of all wetlands and ash flowage marked with "R" trees in center.

Reserve all non-merchantable timber within 15ft of all wetlands.

Itasca County Timber Appraisal Report

Appraised By: Tony Schram Appraisal Date: 07/20/2018	Sale Type: REGULAR AUCTION SALE Auction Date: 12/11/2018	Appraisal Number: 18-06-07 Permit Number: Expiration Date: 03/01/2021 Page: 2 of 3
---	---	---

Slash Disposal

Slash must be scattered throughout permit area.

Special Conditions

Timber is overmature and susceptible to windthrow damage.

Loads with mixed species will be scaled as the highest value species unless the consumer scales species separately using County approved methods.

Regeneration Plan

Natural Regeneration: aspen, balm, ash, northern hardwoods.

Itasca County Timber Appraisal Report

Appraised By: Tony Schram	Sale Type: REGULAR AUCTION SALE	Appraisal Number: 18-06-07
Appraisal Date: 07/20/2018	Auction Date: 12/11/2018	Permit Number:
		Expiration Date: 03/01/2021
		Page: 3 of 3

Site Map:

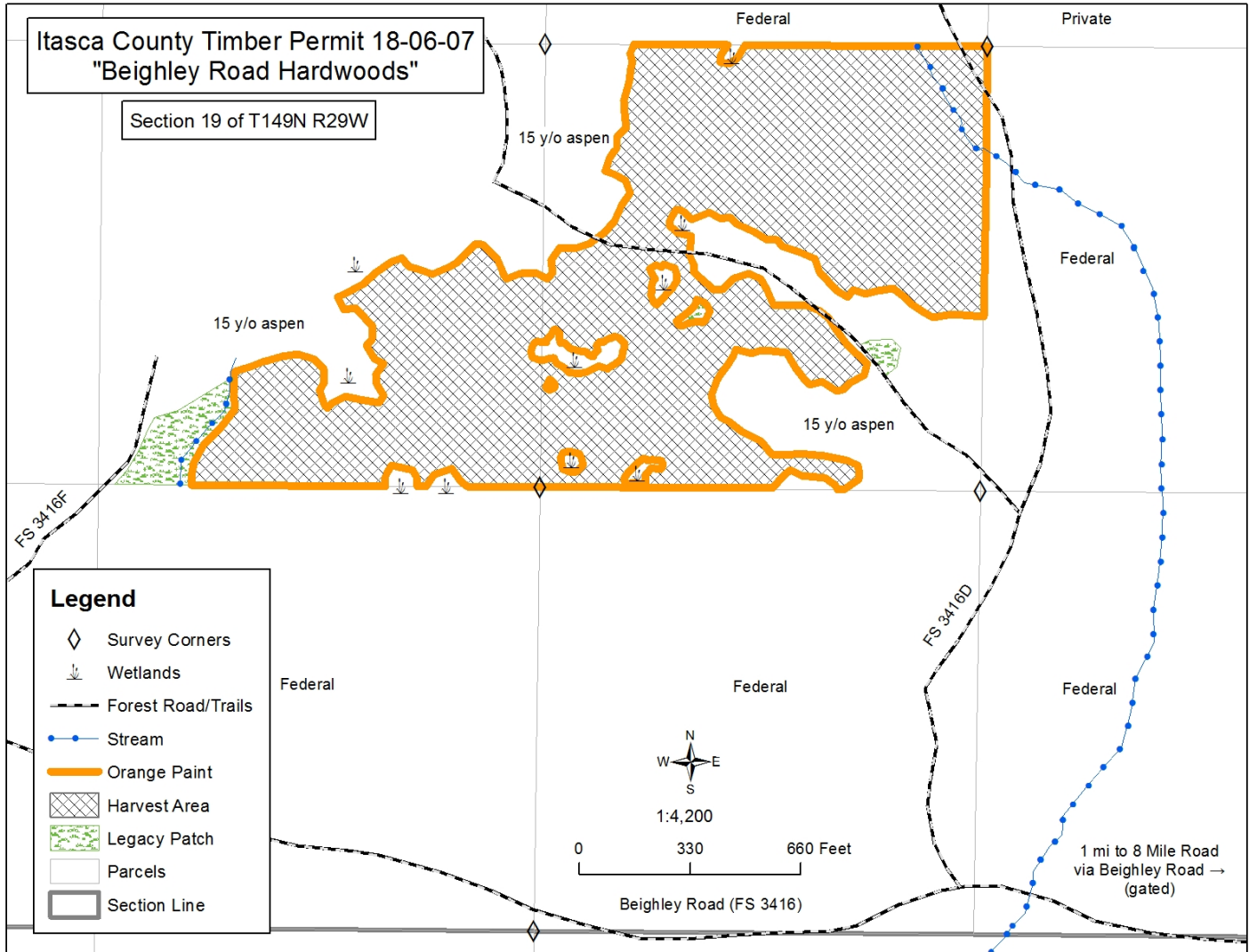

Appraisal examined and approved by _____ Forester _____ Date _____