

Itasca County Timber Appraisal Report

Appraised By: Tony Schram Appraisal Date: 10/23/2018	Sale Type: REGULAR AUCTION SALE Auction Date: 12/11/2018	Appraisal Number: 18-06-05 Permit Number: Expiration Date: 03/01/2021 Page: 1 of 3
---	---	---

Legal Description

RE Code	Sec.	Twp.	Rge.	City/Twp	Subd
27-005-2400	5	148	27	Max	SE NW
27-005-3100	5	148	27	Max	NE SW
27-005-3300	5	148	27	Max	SW SW
27-005-3400	5	148	27	Max	SE SW

Block 1 Species	Volume	Units	Unit Price	Value	Comments	Bolt %	Bid
Aspen	557	Cords	\$22.00	\$12,254.00	6-20", 4-7 st, Fair/Good.	5	^
Balm	151	Cords	\$17.00	\$2,567.00	6-18", 3-6 st, Fair.	0	^
Spruce	149	Cords	\$22.00	\$3,278.00	6-15", 2-5 st, Poor. (limby)	20	^
Jack Pine	107	Cords	\$14.00	\$1,498.00	7-10", 5-6 st, Poor. (declining)	15	^
Ash	102	Cords	\$13.00	\$1,326.00	6-18", 3-6 st, Good.	30	^
Balsam Fir	84	Cords	\$13.00	\$1,092.00	5-10", 2-5 st, Fair.	15	#
Paper Birch	55	Cords	\$11.00	\$605.00	5-18", 2-5 st, Fair.	15	#
Basswood	24	Cords	\$5.00	\$120.00	5-16", 3-6 st, Fair/poor.	5	#
Maple	12	Cords	\$5.00	\$60.00	5-10", 3-5 st, Poor.	0	#

\$22,800.00 **Subtotal**

Total Cords = 1,241 **Total MBF: 0** \$22,800.00 **Total**

Bid Symbols: ^ = Bid Species; # = Non-Bid Species; + = Sold Area Estimate; * = Sold Area Estimate & Non-Bid Species
 All species woodsrun unless listed otherwise.

Species Scaled: Ash , Aspen, Balm , Balsam Fir, Basswood , Jack Pine, Maple , Paper Birch , Spruce

Species SAE:

Operability: Winter - Frozen Ground: 12/15 - 3/1	Soil Type: Nebish very fine sandy loam, Mooselake-Lupton mucky peat
Topography: Level to rolling	Cutting Acres: 39.4

Harvest Specifications

Comments
"Guthrie's Cup" Aspen/balm clearcut, jack pine/norway spruce plantation final harvest, ash diameter limit cut.

Harvest and Reserves
Harvest: In pine and spruce blocks, clearcut all stems to facilitate replanting.
Harvest: In aspen cut all aspen, balm, ash, basswood, and birch.
Harvest: In ash block, cut all ash over 9".
Reserve: On aspen & ash blocks, reserve all oak, cedar, elm, spruce, and "R" marked trees.

Access
Federal land and roads must be crossed to access timber sale. Logger must notify land manager before starting or ceasing operations. Roads must be restored to as good or better condition than pre-harvest.
Private land owners use road; road must remain passable at all times. No skidding on road.
0.5 miles to public road Guthrie Bay Road. 1.5 miles to State Hwy 46.

Itasca County Timber Appraisal Report

Appraised By: Tony Schram Appraisal Date: 10/23/2018	Sale Type: REGULAR AUCTION SALE Auction Date: 12/11/2018	Appraisal Number: 18-06-05 Permit Number: Expiration Date: 03/01/2021 Page: 2 of 3
---	---	---

Landings and Access Roads

Reserve all non-merchantable timber within 15ft of all roads.

Location and construction of any new roads/landings must be pre-approved by the sale administrator.

Cutting, Felling, and Skidding

Do not damage painted trees, regeneration, or reserve species.

Do not fell timber into wetlands or across sale/ownership boundaries.

Do not disturb survey markers, including witness trees.

Sale boundaries painted with orange line; ownership boundaries painted with orange circles. Treat blue painted trees as unmarked.

Skid trail to southeast aspen block painted with two orange rings. Cut all aspen/balm within reach of trail.

Site, Soil, and Water Protection

Filter strips require <5% soil disturbance within 50' of all wetlands.

Homestead sites were identified and painted out within the harvest boundary. Do not operate equipment equipment within these areas.

Slash Disposal

Aspen/ash blocks: Slash must be evenly distributed throughout permit area.

Spruce and pine blocks: Slash is to be piled at administrator approved locations. 20% of tops and limbs must be scattered throughout the permit area per Site Level Forest Management Guideline. The 20% is in addition to incidental breakage.

Regeneration Plan

Natural regeneration in aspen and ash; replanting white spruce in pine and spruce types.

Itasca County Timber Appraisal Report

Appraised By: Tony Schram	Sale Type: REGULAR AUCTION SALE	Appraisal Number: 18-06-05
Appraisal Date: 10/23/2018	Auction Date: 12/11/2018	Permit Number:
		Expiration Date: 03/01/2021
		Page: 3 of 3

Site Map:

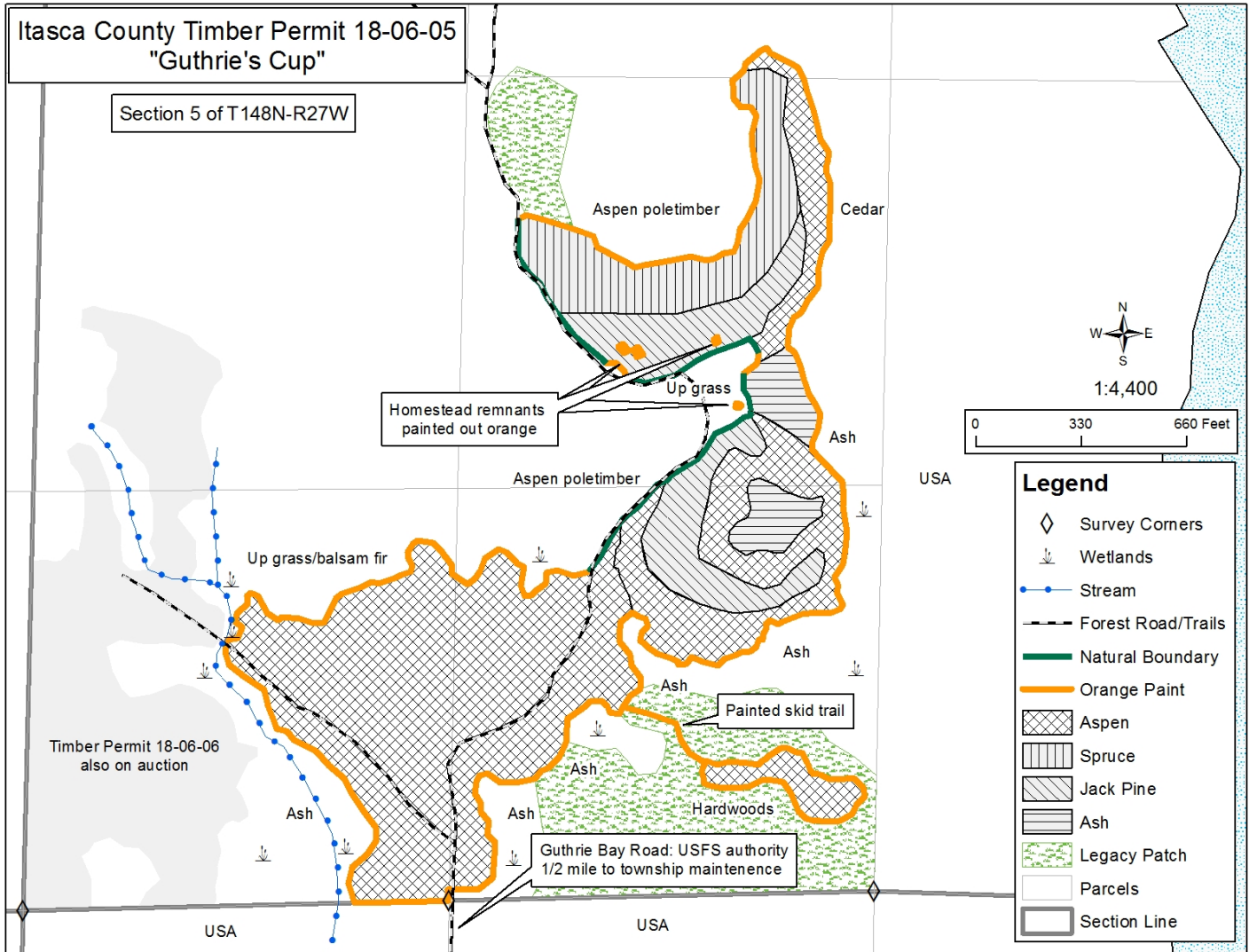

Appraisal examined and approved by _____ Forester _____ Date _____