

Itasca County Timber Appraisal Report

Appraised By: Blair Carlson Appraisal Date: 10/22/2018	Sale Type: REGULAR AUCTION SALE Auction Date: 12/11/2018	Appraisal Number: 18-05-11 Permit Number: Expiration Date: 03/01/2021 Page: 1 of 3
---	---	---

Legal Description

RE Code	Sec.	Twp.	Rge.	City/Twp	Subd
06-033-3200	33	61	22	Bearville	NW SW
06-033-2300	33	61	22	Bearville	SW NW
06-033-3300	33	61	22	Bearville	SW SW
06-105-2200	5	60	22	Bearville	LOT 4

Block 1 Species	Volume	Units	Unit Price	Value	Comments	Bolt %	Bid
Aspen	3,080	Cords	\$24.00	\$73,920.00	5-7 Sticks, Good Quality, 10-14" DBH	35	^
Ash	263	Cords	\$12.00	\$3,156.00	3-5 sticks, Good Quality	35	#
Balsam Fir	129	Cords	\$12.00	\$1,548.00	4-8 inch, 2-4 stick		#
Paper Birch	84	Cords	\$9.00	\$756.00	10-12 inch, 3-4 stick	5	#
Balm	78	Cords	\$17.00	\$1,326.00	10-12 inch, 4-6 stick		#
Spruce	45	Cords	\$25.00	\$1,125.00	100% white spruce, 4-7 stick, 12" DBH	50	#

\$81,831.00 **Subtotal**

Total Cords = 3,679 **Total MBF: 0** \$81,831.00 **Total**

Bid Symbols: ^ = Bid Species; # = Non-Bid Species; + = Sold Area Estimate; * = Sold Area Estimate & Non-Bid Species
 All species woodsrun unless listed otherwise.

Species Scaled: Ash , Aspen, Balm , Balsam Fir, Paper Birch , Spruce

Species SAE:

Operability: Winter/Frozen Ground : 12-1 - 3-1 **Soil Type:** 620B Cutaway loamy sand
Topography: Flat **Cutting Acres:** 113.1

Harvest Specifications

Comments
Harvest Type: Clearcut w/reserves; Lowland Hardwood Thinning by Diameter Within Lowland Hardwood types harvest all Ash 10" and above with a goal of 50-60 basal area residual

Harvest and Reserves
Reserve all non-hazardous snags. Reserve all Maple, Jack Pine, White Pine, and Oak

Access
1/4 miles to public road Snake Trail.

Landings and Access Roads
Location and construction of any new roads/landings must be pre-approved by the sale administrator. Trails and landings need to be rehabilitated to a satisfactory condition before performance bond is returned. Temporary water/wetland crossing needed on one or more locations. Remove crossing when harvesting activity is completed. Culvert(s) may be needed on access road(s).

Itasca County Timber Appraisal Report

Appraised By: Blair Carlson Appraisal Date: 10/22/2018	Sale Type: REGULAR AUCTION SALE Auction Date: 12/11/2018	Appraisal Number: 18-05-11 Permit Number: Expiration Date: 03/01/2021 Page: 2 of 3
---	---	---

Cutting, Felling, and Skidding

Do not damage reserve trees.
Do not fell timber into wetlands or across sale boundaries.
Do not disturb survey markers, including witness trees.
Sale boundaries painted Orange.

Site, Soil, and Water Protection

Filter strips require <5% soil disturbance within 50' of all wetlands.
Restricted cutting is allowed within the RMZ. Refer to sale administrator for specific basal area or species specific requirements.
Can cross intermittent creek / drainage in 1 location. All slash must be pulled from the creek and banks rehabilitated upon sale completion.
Reserve all non-merchantable timber within 15ft of all wetlands.

Slash Disposal

Slash must be evenly distributed throughout permit area.

Regeneration Plan

Natural Regeneration

Itasca County Timber Appraisal Report

Appraised By: Blair Carlson	Sale Type: REGULAR AUCTION SALE	Appraisal Number: 18-05-11
Appraisal Date: 10/22/2018	Auction Date: 12/11/2018	Permit Number:
		Expiration Date: 03/01/2021
		Page: 3 of 3

Site Map:

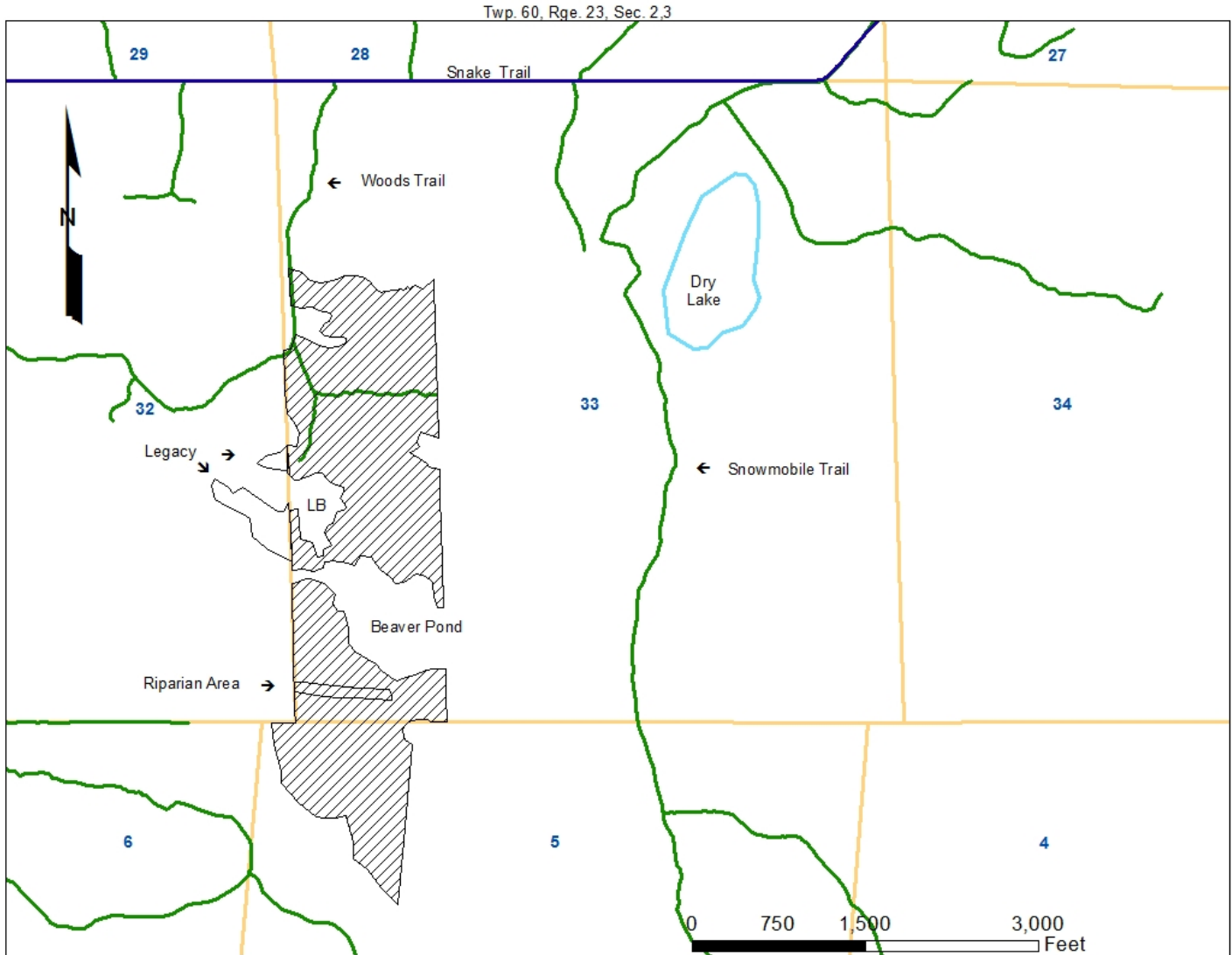

Appraisal examined and approved by _____ Forester _____ Date _____