

## Itasca County Timber Appraisal Report

<b>Appraised By:</b> Loren Eide  <b>Appraisal Date:</b> 10/25/2018	<b>Sale Type:</b> REGULAR AUCTION SALE  <b>Auction Date:</b> 12/11/2018	<b>Appraisal Number:</b> 18-04-15 <b>Permit Number:</b> <b>Expiration Date:</b> 03/01/2021 <b>Page:</b> 1 of 3
--	---	---

**Legal Description**

RE Code	Sec.	Twp.	Rge.	City/Twp	Subd		
06-117-0000	17	60	22	Bearville	ALL OF SEC 17		
06-120-2000	20	60	22	Bearville	NW 1/4		
Block 1 Species	Volume	Units	Unit Price	Value	Comments	Bolt %	Bid
Aspen	230	Cords	\$22.00	\$5,060.00	12-20+"		^
Paper Birch	450	Cords	\$10.00	\$4,500.00	7-13'	15	^
Maple	425	Cords	\$8.00	\$3,400.00	7-13"		^
Basswood	40	Cords	\$15.00	\$600.00	10% saw	50	#
Ash	40	Cords	\$12.00	\$480.00		35	#
Balsam Fir	25	Cords	\$14.00	\$350.00		15	*
Spruce	5	Cords	\$25.00	\$125.00	White	75	+
				\$14,515.00	<b>Subtotal</b>		
<b>Total Cords =</b>	1,215		<b>Total MBF: 0</b>	\$14,515.00	<b>Total</b>		

Bid Symbols: ^ = Bid Species; # = Non-Bid Species; + = Sold Area Estimate; \* = Sold Area Estimate & Non-Bid Species  
 All species woodsrun unless listed otherwise.

**Species Scaled:** Ash , Aspen, Basswood , Maple , Paper Birch  
**Species SAE:** Balsam Fir, Spruce

**Operability:** Winter sale: 12/15 - 3/1      **Soil Type:** Nashwauk fine sandy loam, Blackhoof Muck  
**Topography:** Level to rolling      **Cutting Acres:** 39.1

**Harvest Specifications**

Comments
Clearcuts w/reserves, small ash thins

Harvest and Reserves
Reserve Y. Birch, pine, oak, small balsam and 2 fully crowned birch per acre (200' spacing) within birch types shown on map. Reserve all non-hazardous snags and cavity trees. Harvest ash 10" and greater on SW part of sale and ash 8" and greater on NE part of sale. Reserve smaller ash.

Access
Gate at Stoney Ridge Trail parking lot must be locked in evening, and shut during the day except when hauling. Snowmobile trail regulations in Itasca County Forest Management Guideline & Specifications apply. A minimum of two inches of compacted snow must remain on the trail as a running surface. 3 miles to public road (#65).

Landings and Access Roads
Location and construction of any new roads/landings must be pre-approved by the sale administrator. Trails and landings need to be rehabilitated to a satisfactory condition before performance bond is returned.

Cutting, Felling, and Skidding
Majority of sale boundaries painted orange with some natural cutting boundaries. Do not disturb survey markers, including witness trees.

# Itasca County Timber Appraisal Report

<b>Appraised By:</b> Loren Eide	<b>Sale Type:</b> REGULAR AUCTION SALE	<b>Appraisal Number:</b> 18-04-15
<b>Appraisal Date:</b> 10/25/2018	<b>Auction Date:</b> 12/11/2018	<b>Permit Number:</b>
		<b>Expiration Date:</b> 03/01/2021
		<b>Page:</b> 2 of 3

<b>Regeneration Plan</b>
Natural Regeneration

# Itasca County Timber Appraisal Report

<b>Appraised By:</b> Loren Eide	<b>Sale Type:</b> REGULAR AUCTION SALE	<b>Appraisal Number:</b> 18-04-15
<b>Appraisal Date:</b> 10/25/2018	<b>Auction Date:</b> 12/11/2018	<b>Permit Number:</b>
		<b>Expiration Date:</b> 03/01/2021
		<b>Page:</b> 3 of 3

**Site Map:**

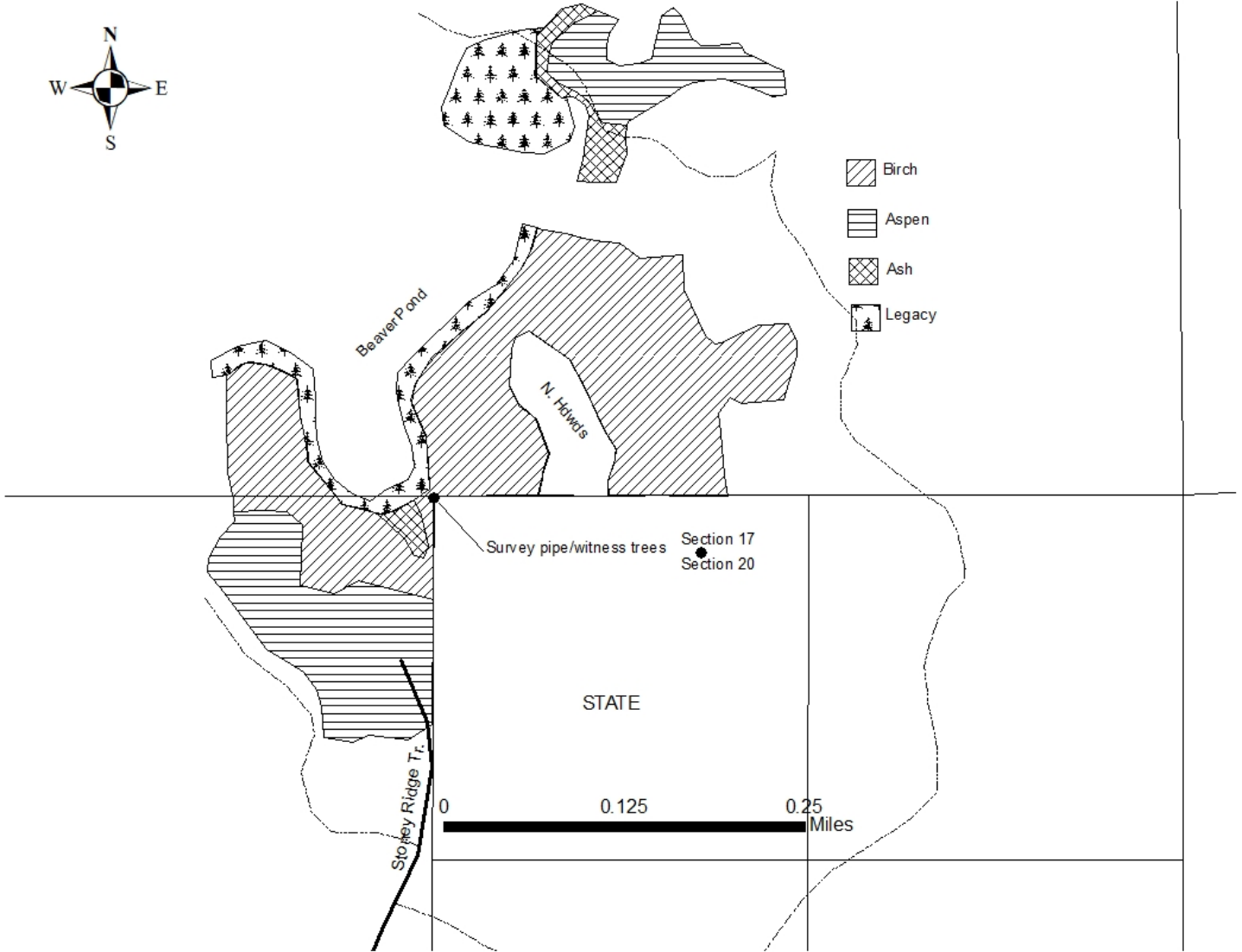

Appraisal examined and approved by \_\_\_\_\_ Forester \_\_\_\_\_ Date \_\_\_\_\_