

Itasca County Timber Appraisal Report

| | | |
|--|---|---|
| Appraised By: Loren Eide Appraisal Date: 10/04/2018 | Sale Type: REGULAR AUCTION SALE Auction Date: 12/11/2018 | Appraisal Number: 18-04-10 Permit Number: Expiration Date: 03/01/2021 Page: 1 of 3 |
|--|---|---|

Legal Description

| <u>RE Code</u> | <u>Sec.</u> | <u>Twp.</u> | <u>Rge.</u> | <u>City/Twp</u> | <u>Subd</u> |
|----------------|-------------|-------------|-------------|-----------------|---------------|
| 06-117-0000 | 17 | 60 | 22 | Bearville | ALL OF SEC 17 |
| 06-118-1000 | 18 | 60 | 22 | Bearville | NE 1/4 |
| 06-118-4000 | 18 | 60 | 22 | Bearville | SE 1/4 |
| 06-119-1000 | 19 | 60 | 22 | Bearville | NE 1/4 |
| 06-120-2000 | 20 | 60 | 22 | Bearville | NW 1/4 |

| <u>Block 1 Species</u> | <u>Volume</u> | <u>Units</u> | <u>Unit Price</u> | <u>Value</u> | <u>Comments</u> | <u>Bolt %</u> | <u>Bid</u> |
|------------------------|---------------|--------------|-------------------|--------------|-----------------|---------------|------------|
| Aspen | 830 | Cords | \$22.00 | \$18,260.00 | | | ^ |
| Balm | 45 | Cords | \$20.00 | \$900.00 | | | # |
| Paper Birch | 585 | Cords | \$9.00 | \$5,265.00 | | 10 | ^ |
| Maple | 340 | Cords | \$8.00 | \$2,720.00 | | | ^ |
| Balsam Fir | 130 | Cords | \$15.00 | \$1,950.00 | | 15 | * |
| Spruce | 55 | Cords | \$28.00 | \$1,540.00 | White | 60 | # |
| Ash | 95 | Cords | \$11.00 | \$1,045.00 | see notes | 20 | # |
| Basswood | 75 | Cords | \$13.00 | \$975.00 | | 50 | * |

\$32,655.00 **Subtotal**

Total Cords = 2,155 **Total MBF: 0** \$32,655.00 **Total**

Bid Symbols: ^ = Bid Species; # = Non-Bid Species; + = Sold Area Estimate; * = Sold Area Estimate & Non-Bid Species
 All species woodsrun unless listed otherwise.

Species Scaled: Ash , Aspen, Balm , Maple , Paper Birch , Spruce

Species SAE: Balsam Fir, Basswood

Operability: Winter sale: 12/15 - 3/1 **Soil Type:** Nashwauk fine sandy loam,Keewatin silt loam,Greenwood Peat

Topography: Level to rolling (north), rolling to hilly(south) **Cutting Acres:** 70.7

Harvest Specifications

| Comments |
|---|
| Aspen/N. Hdwd stands to be clearcut w/reserves. Black ash stands to be thinned. |

| Harvest and Reserves |
|--|
| Reserve cedar, Y. birch, pine, small balsam, cavity trees and all non-hazardous snags. |

| Access |
|--|
| Gate must be locked each evening, but can be left open during the days when 3 or more loads are hauled. Snowmobile trail regulations in Itasca County Forest Management Guideline & Specifications apply. A minimum of two inches of compacted snow must remain on the trail as a running surface. State land (portion of access rd.) must be crossed to access timber sale. Logger must obtain permission from land manager. 2.5 miles to public road (#65). |

| Landings and Access Roads |
|--|
| Location and construction of any new roads/landings must be pre-approved by the sale administrator. Trails and landings need to be rehabilitated to a satisfactory condition before performance bond is returned. |

Itasca County Timber Appraisal Report

| | | |
|--|---|---|
| Appraised By: Loren Eide Appraisal Date: 10/04/2018 | Sale Type: REGULAR AUCTION SALE Auction Date: 12/11/2018 | Appraisal Number: 18-04-10 Permit Number: Expiration Date: 03/01/2021 Page: 2 of 3 |
|--|---|---|

Cutting, Felling, and Skidding

Do not damage regeneration/ reserve trees or fell timber across sale boundaries.

Do not disturb survey markers, including witness trees.

Most sale boundaries painted orange, but some natural cutting boundaries.

Ash type shown on map - cut merchantable ash 3 sticks and greater, elsewhere on sale, cut ash greater than 9" dbh.

Site, Soil, and Water Protection

Roads and skid trails must be stabilized. This may involve installing water bars, strike outs, and/or mulching and seeding.

Slash Disposal

Slash must be evenly distributed throughout permit area.

Itasca County Timber Appraisal Report

| | | |
|--------------------------------------|---|------------------------------------|
| Appraised By: Loren Eide | Sale Type: REGULAR AUCTION SALE | Appraisal Number: 18-04-10 |
| Appraisal Date: 10/04/2018 | Auction Date: 12/11/2018 | Permit Number: |
| | | Expiration Date: 03/01/2021 |
| | | Page: 3 of 3 |

Site Map:

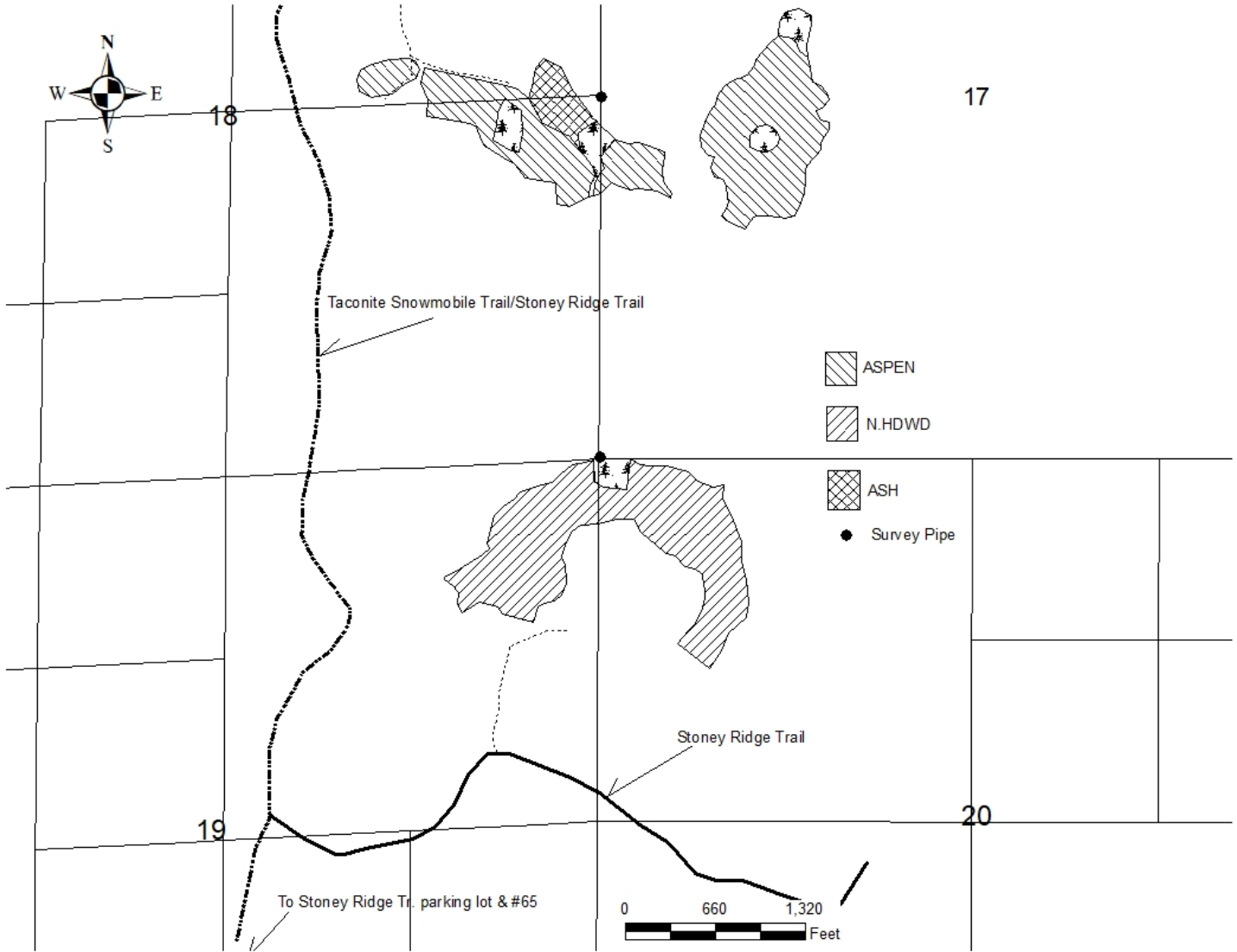

Appraisal examined and approved by _____ Forester _____ Date _____