

Itasca County Timber Appraisal Report

Appraised By: Loren Eide Appraisal Date: 09/27/2018	Sale Type: REGULAR AUCTION SALE Auction Date: 12/11/2018	Appraisal Number: 18-04-09 Permit Number: Expiration Date: 03/01/2021 Page: 1 of 3
--	---	---

Legal Description

<u>RE Code</u>	<u>Sec.</u>	<u>Twp.</u>	<u>Rge.</u>	<u>City/Twp</u>	<u>Subd</u>
48-010-3000	10	58	22	Unorganized	SW 1/4
48-010-4300	10	58	22	Unorganized	SW SE
48-010-4400	10	58	22	Unorganized	SE SE
48-011-1200	11	58	22	Unorganized	LOT 2
48-011-1300	11	58	22	Unorganized	LOT 3
48-011-2000	11	58	22	Unorganized	NW 1/4
48-011-3000	11	58	22	Unorganized	SW 1/4
48-011-4000	11	58	22	Unorganized	SE 1/4
48-014-1200	14	58	22	Unorganized	LOT 2
48-014-2100	14	58	22	Unorganized	NE NW
48-014-2200	14	58	22	Unorganized	NW NW
48-015-1300	15	58	22	Unorganized	SW NE
48-015-2000	15	58	22	Unorganized	NW 1/4
48-015-3000	15	58	22	Unorganized	SW 1/4
48-015-4000	15	58	22	Unorganized	SE 1/4

<u>Block 1 Species</u>	<u>Volume</u>	<u>Units</u>	<u>Unit Price</u>	<u>Value</u>	<u>Comments</u>	<u>Bolt %</u>	<u>Bid</u>
Aspen	4,740	Cords	\$23.00	\$109,020.00		10	^
Balsam Fir	660	Cords	\$15.00	\$9,900.00		15	#
Spruce	430	Cords	\$21.00	\$9,030.00	64% White Spruce,36% Black.	35	^
Maple	800	Cords	\$8.00	\$6,400.00			^
Paper Birch	460	Cords	\$8.00	\$3,680.00			^
Ash	190	Cords	\$13.00	\$2,470.00	5% saw	25	#
Balm	50	Cords	\$20.00	\$1,000.00			#
Basswood	50	Cords	\$10.00	\$500.00		35	#
Tamarack	65	Cords	\$6.00	\$390.00		15	#

\$142,390.00 **Subtotal**

Total Cords = 7,445 **Total MBF: 0** \$142,390.00 **Total**

Bid Symbols: ^ = Bid Species; # = Non-Bid Species; + = Sold Area Estimate; * = Sold Area Estimate & Non-Bid Species
 All species woodsrun unless listed otherwise.

Species Scaled: Ash , Aspen, Balm , Balsam Fir, Basswood , Maple , Paper Birch , Spruce , Tamarack

Species SAE:

Operability: Winter Sale: 12/15 - 3/1	Soil Type: Nashwauk fine sandy loam,Keewatin silt loam,Greenwood Peat
Topography: Level to rolling	Cutting Acres: 278.5

Harvest Specifications

<u>Comments</u>
Aspen, N. Hdws and Spruce stands to be clearcut w/reserves. Ash stands to be thinned.

Itasca County Timber Appraisal Report

Appraised By: Loren Eide Appraisal Date: 09/27/2018	Sale Type: REGULAR AUCTION SALE Auction Date: 12/11/2018	Appraisal Number: 18-04-09 Permit Number: Expiration Date: 03/01/2021 Page: 2 of 3
--	---	---

Harvest and Reserves

Reserve cedar, pine, small balsam and all non-hazardous snags and cavity trees.

Ash type shown on map - harvest ash greater than 8" dbh. Other ash types - harvest 1/2 of basal area. Leave remaining ash undamaged.

Access

Snowmobile trail regulations in Itasca County Forest Management Guideline & Specifications apply. A minimum of two inches of compacted snow must remain on the trail as a running surface.

3.5 miles from center of sale area to a public road (County #55).

Gate must be locked each evening, but can be left open during the day when 3 or more loads are hauled.

Landings and Access Roads

Location and construction of any new roads/landings must be pre-approved by the sale administrator.

Trails and landings need to be rehabilitated to a satisfactory condition before performance bond is returned.

Cutting, Felling, and Skidding

Do not damage regeneration/ reserve trees or fell timber across sale boundaries.

Do not disturb survey markers, including witness trees.

Most sale boundaries painted orange with some natural boundaries.

Slash Disposal

A 10 ft. wide slash free zone must be maintained along roads and trails.

Special Conditions

All Black Spruce stems greater than 5ft. must be severed for Dwarf Mistletoe prevention.

Regeneration Plan

Natural regeneration of aspen, N hwds and black spruce is expected. Black spruce areas to be supplemented with aerial seeding.

Itasca County Timber Appraisal Report

Appraised By:
Loren Eide
Appraisal Date:
09/27/2018

Sale Type:
REGULAR AUCTION SALE
Auction Date:
12/11/2018

Appraisal Number: 18-04-09
Permit Number:
Expiration Date: 03/01/2021
Page: 3 of 3

Site Map:

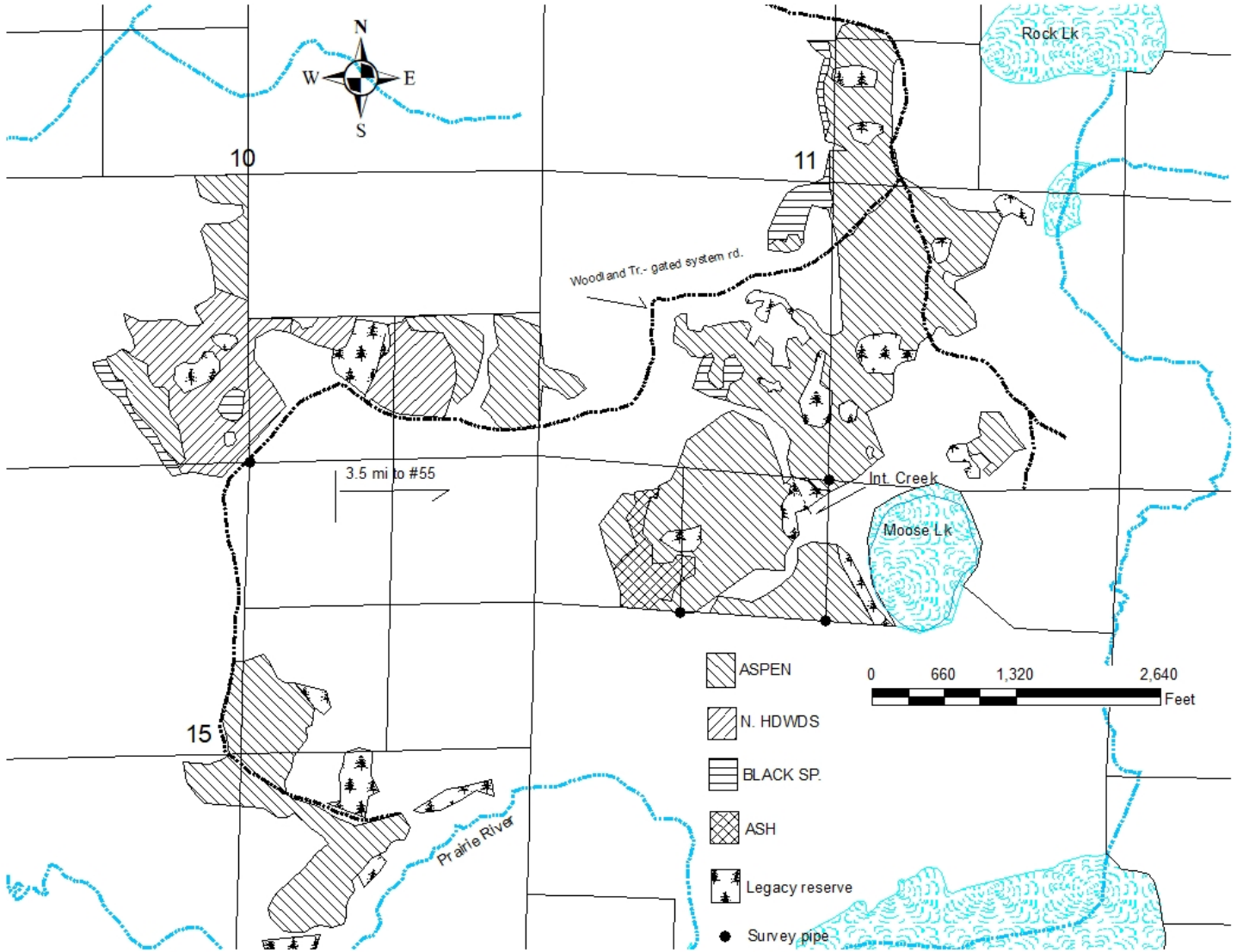

Appraisal examined and approved by _____

Forester

Date