

## Itasca County Timber Appraisal Report

|  |   |   |
|--|---|---|
| <b>Appraised By:</b><br>Bob Rother<br><br><b>Appraisal Date:</b><br>10/11/2018 | <b>Sale Type:</b><br>INTERMEDIATE AUCTION<br><br><b>Auction Date:</b><br>12/11/2018 | <b>Appraisal Number:</b> 18-01-10<br><b>Permit Number:</b><br><b>Expiration Date:</b> 03/01/2021<br><b>Page:</b> 1 of 2 |
|--|---|---|

**Legal Description**

| <u>RE Code</u>         | <u>Sec.</u>   | <u>Twp.</u>         | <u>Rge.</u>       | <u>City/Twp</u> | <u>Subd</u>                      |               |            |
|------------------------|---------------|---------------------|-------------------|-----------------|----------------------------------|---------------|------------|
| 12-006-4000            | 6             | 54                  | 23                | Feeley          | SE 1/4                           |               |            |
| 12-007-1100            | 7             | 54                  | 23                | Feeley          | NE NE                            |               |            |
| 12-007-1400            | 7             | 54                  | 23                | Feeley          | SE NE                            |               |            |
| <u>Block 1 Species</u> | <u>Volume</u> | <u>Units</u>        | <u>Unit Price</u> | <u>Value</u>    | <u>Comments</u>                  | <u>Bolt %</u> | <u>Bid</u> |
| Aspen                  | 250           | Cords               | \$21.00           | \$5,250.00      | 4-8 stick, 7-16"+ dbh, fair-good | 30            | ^          |
| Balm                   | 2             | Cords               | \$17.00           | \$34.00         | 2-5 stick, 5-10" dbh, fair       | 0             | #          |
|                        |               |                     |                   | \$5,284.00      | <b>Subtotal</b>                  |               |            |
| <b>Total Cords =</b>   | 252           | <b>Total MBF: 0</b> |                   | \$5,284.00      | <b>Total</b>                     |               |            |

Bid Symbols: ^ = Bid Species; # = Non-Bid Species; + = Sold Area Estimate; \* = Sold Area Estimate & Non-Bid Species  
 All species woodsrun unless listed otherwise.

**Species Scaled:** Aspen, Balm

**Species SAE:**

**Operability:** Winter Chance - Frozen Ground: 12/15 - 3/1      **Soil Type:** Spooner silt loam  
**Topography:** Level      **Cutting Acres:** 8.9

**Harvest Specifications**

| Comments  |
|---|
| Harvest Type = Clearcut with Reserves   |
| Harvest and Reserves  |
| Reserve all non-hazardous snags.<br>Reserve: Oak, Elm, Regen Patches. Do not damage reserve trees   |
| Landings and Access Roads   |
| Trails and landings need to be rehabilitated to a satisfactory condition before performance bond is returned.<br>Roads and landings must be approved by sale administrator. |
| Cutting, Felling, and Skidding  |
| Sale boundaries painted Orange slashes III.   |
| Slash Disposal  |
| Slash must be evenly distributed throughout permit area.  |
| Regeneration Plan   |
| Natural Regeneration  |

# Itasca County Timber Appraisal Report

|                                      |   |                                    |
|--------------------------------------|---|------------------------------------|
| <b>Appraised By:</b><br>Bob Rother   | <b>Sale Type:</b><br>INTERMEDIATE AUCTION | <b>Appraisal Number:</b> 18-01-10  |
| <b>Appraisal Date:</b><br>10/11/2018 | <b>Auction Date:</b><br>12/11/2018        | <b>Permit Number:</b>              |
|                                      |   | <b>Expiration Date:</b> 03/01/2021 |
|                                      |   | <b>Page:</b> 2 of 2                |

**Site Map:**

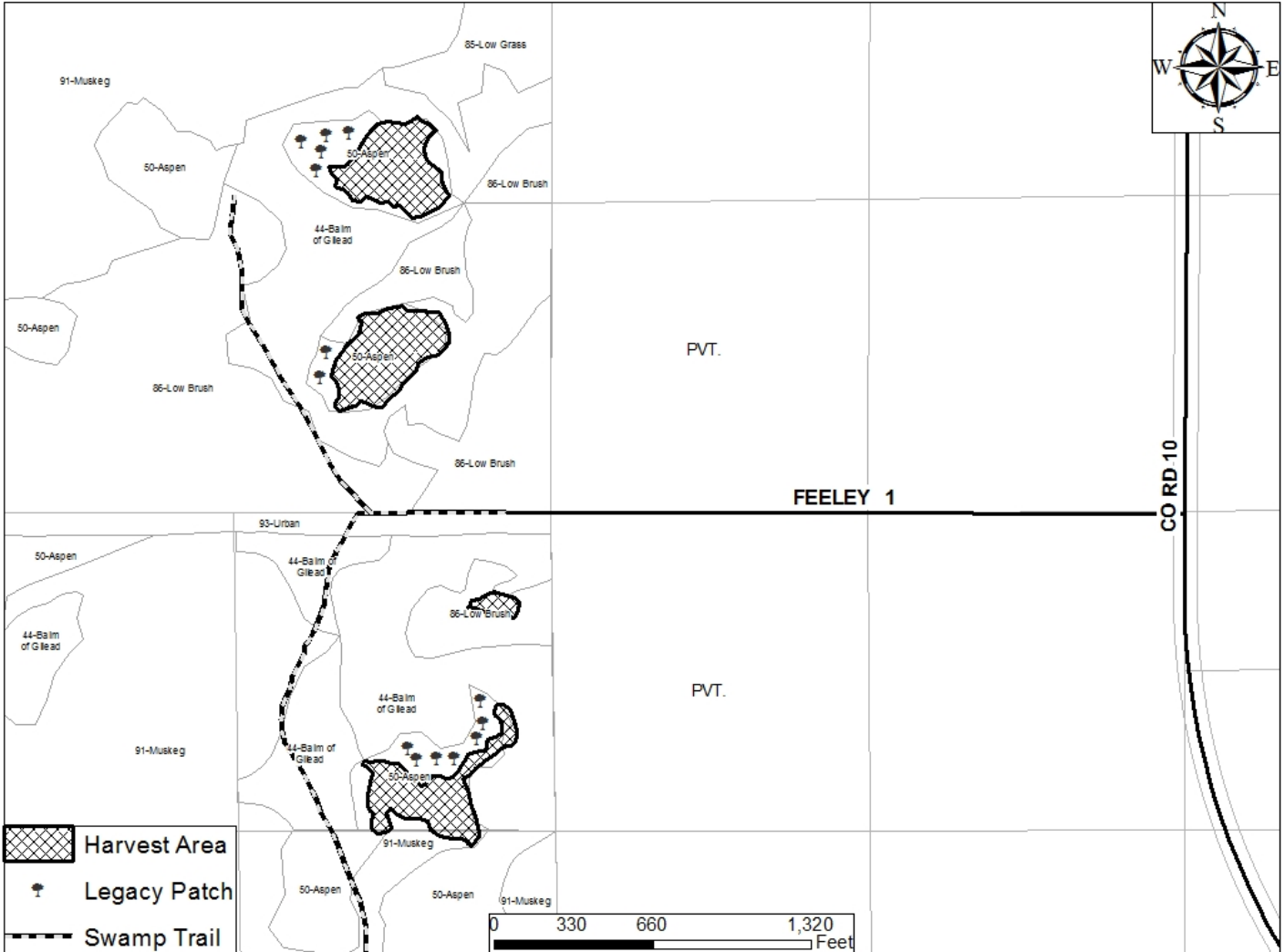

Appraisal examined and approved by \_\_\_\_\_ Forester \_\_\_\_\_ Date \_\_\_\_\_