

Itasca County Timber Appraisal Report

Appraised By: Ryan Newman Appraisal Date: 09/20/2017	Sale Type: REGULAR AUCTION SALE Auction Date: 12/07/2020	Appraisal Number: 17-102 Permit Number: Expiration Date: 03/01/2023 Page: 1 of 3
---	---	---

Legal Description

<u>RE Code</u>	<u>Sec.</u>	<u>Twp.</u>	<u>Rge.</u>	<u>City/Twp</u>	<u>Subd</u>
53-030-2400	30	60	23	Unorganized	SE NW
53-030-3000	30	60	23	Unorganized	SW 1/4
53-030-4200	30	60	23	Unorganized	NW SE
53-030-1000	30	60	23	Unorganized	NE 1/4

<u>Block 1 Species</u>	<u>Volume</u>	<u>Units</u>	<u>Unit Price</u>	<u>Value</u>	<u>Comments</u>	<u>Bolt %</u>	<u>Bid</u>
Tamarack	1,715	Cords	\$4.00	\$6,860.00	6-14" DBH, 4-6 stick average, poor to fair condition and declining over time	10	^
				\$6,860.00	Subtotal		
Total Cords =	1,715	Total MBF: 0		\$6,860.00	Total		

Bid Symbols: ^ = Bid Species; # = Non-Bid Species; + = Sold Area Estimate; * = Sold Area Estimate & Non-Bid Species
 All species woodsrun unless listed otherwise.

Species Scaled: Tamarack
Species SAE:

Operability: Frozen Ground Only: 1/1/2021 - 3/1/2023 **Soil Type:** Mooselake and Lupton mucky peats
Topography: Level **Cutting Acres:** 48.0

All permits must follow Itasca County Forest Management Guidelines and Specifications (can be found at <http://www.co.itasca.mn.us/DocumentCenter/View/567/Forest-Management-Guidelines-and-Specifications>).

Harvest Specifications

Comments
Harvest Type = Clear-cut w/reserves RE_OFFER

Harvest and Reserves
Clearcut all tamarack 5" in DBH or greater and at least 1 stick. Due to significant beetle mortality, all dead tamarack may be harvested. Do not cut any other tree species. Reserve all advanced regeneration for all species, including all healthy tamarack under 5" in DBH and less than 1 stick.

Access
0.8 miles to Wasson Lake Forest Road. State land must be crossed to the west to access timber sale. Logger must obtain permits/permission from the MN DNR.

Landings and Access Roads
Location and construction of any new roads/landings must be pre-approved by the sale administrator. Trails and landings need to be rehabilitated to a satisfactory condition, determined by administering forester, before performance bond is returned.

Cutting, Felling, and Skidding
All boundaries are painted. Cutting boundaries are painted with 3 orange dashes (III), and the western property boundary is painted with 3 orange circles (o0o). An orange paint trail is painted between the sale's two tamarack stands. Pink flagging tape marks a stream in the northern tamarack stand. There will only be 1 stream crossing as indicated by trees with 3 blue dashes (III).

Slash Disposal
Slash must be evenly distributed throughout permit area.

Itasca County Timber Appraisal Report**Appraised By:**

Ryan Newman

Appraisal Date:

09/20/2017

Sale Type:

REGULAR AUCTION SALE

Auction Date:

12/07/2020

Appraisal Number: 17-102**Permit Number:****Expiration Date:** 03/01/2023**Page:** 2 of 3**Regeneration Plan**

Tamarack will naturally regenerate, and black spruce will be aeri ally seeded.

Itasca County Timber Appraisal Report

Appraised By: Ryan Newman	Sale Type: REGULAR AUCTION SALE	Appraisal Number: 17-102
Appraisal Date: 09/20/2017	Auction Date: 12/07/2020	Permit Number:
		Expiration Date: 03/01/2023
		Page: 3 of 3

Site Map:

Wasson Lake Tamarack

Legal: 60-23-30

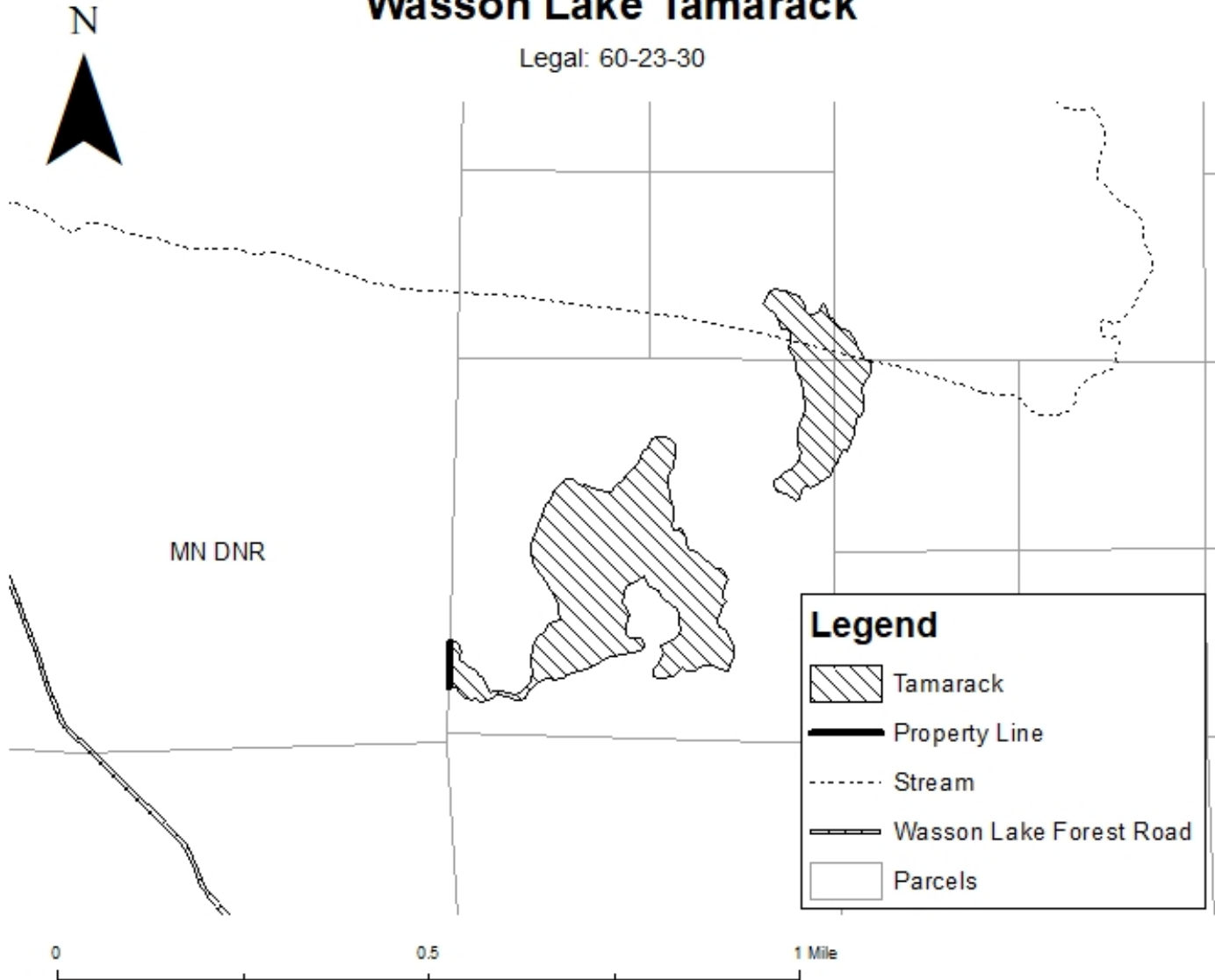

Appraisal examined and approved by _____
Forester
Date

Appraisal examined and approved by _____
Land Department
Date